



INSTALLATION INSTRUCTIONS

PART#: 7G086106SS\7G086106A
TAIL LIGHT GUARD FOR 02-07 JEEP LIBERTY

TEL ☐ 1-866-XANATOS

PARTS LIST:

1	Driver/Left Taillight Guard (longer mounting tabs)	2	4-.90mm x 12mm Phillips Screws
1	Passenger/Right Taillight Guard (shorter mounting tabs)	2	4mm ID x 9mm OD x 1mm Flat Washers
2	Support Brackets		

PROCEDURE:

1. **REMOVE CONTENTS FROM BOX. VERIFY ALL PARTS ARE PRESENT. READ INSTRUCTIONS CAREFULLY BEFORE STARTING INSTALLATION.**
2. Open the rear door and remove the passenger's side screws holding the taillight (**Figure 1**).
3. Grasp the taillight with one hand and pull gently. **NOTE:** Be sure to pull straight out to avoid possible damage. This is the same procedure required to change a burn out taillight in the assembly. For more info see owner's manual on replacing burn taillight bulbs.
4. Once you have removed the passenger taillight, use the bigger hole in the Support Bracket to attach it to upper factory stud located behind taillight (**Figure 2**).
5. Hold Support Bracket in place as you re-install the taillight back onto vehicle (**Figure 3**).
6. Carefully position the passenger side Taillight Guard onto vehicle and attach it using the factory screws removed in step two (**Figure 4**). Do not tighten at this time. **NOTE:** If Mounting Brackets don't fit properly, they can be adjusted to fit properly using a pair of pliers. Make sure to protect the finish on the mounting tabs when adjusting.
7. Attach Taillight Guard to Support Bracket using the included (1) 4-.90mm x 12mm Phillips Screw, (1) 4mm Flat Washer (**Figure 5**). Do not tighten at this time.
8. Align and center Taillight Guard; then tighten all hardware at this time. **IMPORTANT:** Close the rear door slowly to make sure Taillight Guard does not interfere with rear door. If so, remove Taillight Guard and adjust Mounting Tabs by pulling or pushing on them.
9. Repeat steps 2-8 for driver side Taillight Guard. **NOTE:** Open the rear door all the way, and use a long torx screw driver to remove the factory screws trough the gap between the rear door and vehicle (**Figure 6**).
10. Do periodic inspections to the installation to make sure that all hardware is secure and tight.

To protect your investment, wax this product after installing. Regular waxing is recommended to add a protective layer over the finish. Do not use any type of polish or wax that may contain abrasives that could damage the finish.

For stainless steel: Aluminum polish may be used to polish small scratches and scuffs on the finish. Mild soap may be used also to clean the Sidebar.

For gloss black finishes: Mild soap may be used to clean the Sidebar.

Passenger Side Installation Shown)

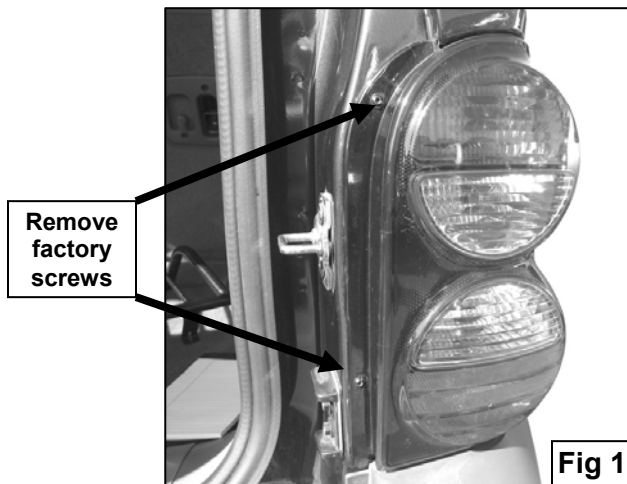

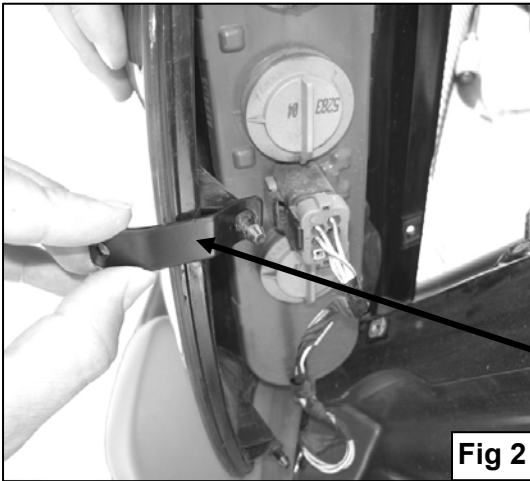

Fig 2

**Support
Bracket**

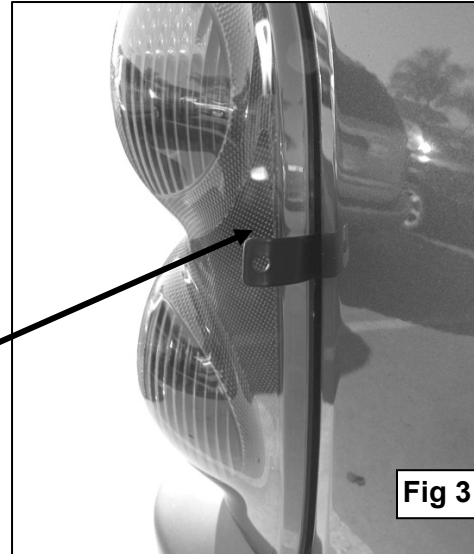
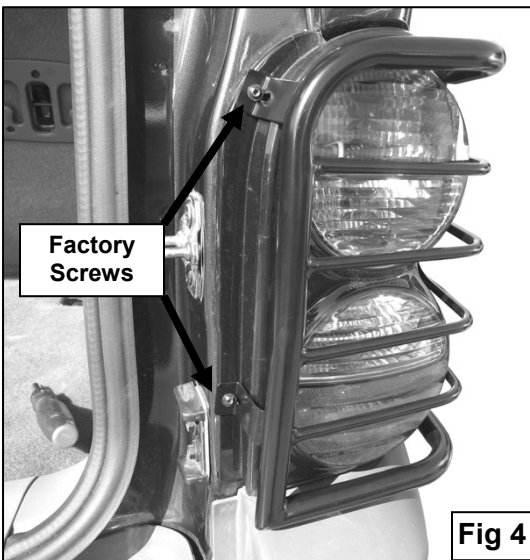

Fig 3



**Factory
Screws**

Fig 4

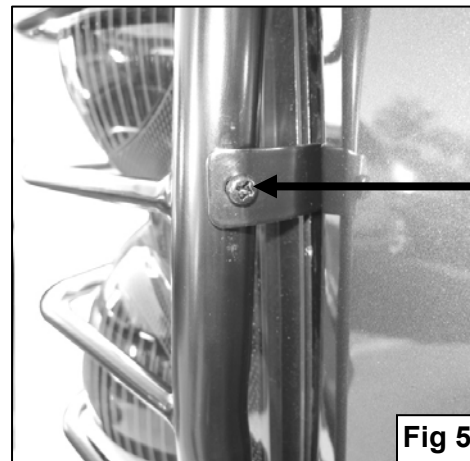
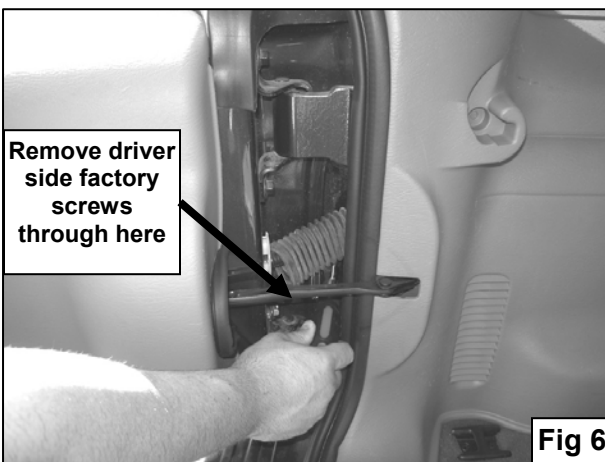

Fig 5

**4mm x 12mm Screw
4mm Lock Washer
4mm Flat Washer**



**Remove driver
side factory
screws
through here**

Fig 6

Installation Complete



Fig 7