



**TEL: 1-866-XANATOS**

## **INSTALLATION INSTRUCTIONS**

**MD1 FRONT BUMPER  
2015-19 CHEVY SILVERADO 25-3500  
PART# AFB-SI35-BU**

## PARTS LIST:

1	MD1 Front Bumper	6	10-1.5mm x 35mm Hex Bolts
1	Driver/left Top Fill Panel	4	10-1.5mm x 30mm Hex Bolts
1	Passenger/right Top Fill Panel	12	10mm x 27mm x 3mm Flat Washers
1	Top Center Fill Panel	4	10mm x 20mm x 2mm Flat Washers
1	Driver/left Frame Bracket	10	10mm Lock Washers
1	Passenger/right Frame Bracket	6	10mm Hex Nuts
2	Outer Mesh Fill Panels	2	8-1.25mm x 25mm Hex Bolts
1	Center Mesh Fill Panel	2	8-1.25mm x 16mm Hex Bolts
1	Driver/left LED "L" Light Bar Bracket	6	8mm x 24mm x 2mm Flat Washers
1	Passenger/right LED "L" Light Bar Bracket	4	8mm Lock Washers
1	License Plate Bracket	2	8mm Hex Nuts
2	License Plate Plastic Plugs	20	6-1.0mm x 20mm Button Head Combo Bolts
4	Sensor Retaining Caps	2	6-1.0mm x 20mm Button Head Bolts
4	20mm x 10mm Foam Spacers	4	6mm x 18mm x 1.6mm Flat Washers
4	15.5mm x 25mm Foam Sealing Washers	2	6-1.0mm Nylon Lock Nuts
4	Sensor Plugs	10	6mm Flange Nuts
4	Wiring Harness Extensions	8	4mm Self Tapping Screws
1	LED Wiring Harness Kit	1	4mm Allen Wrench
10	Nylon Wire Ties		

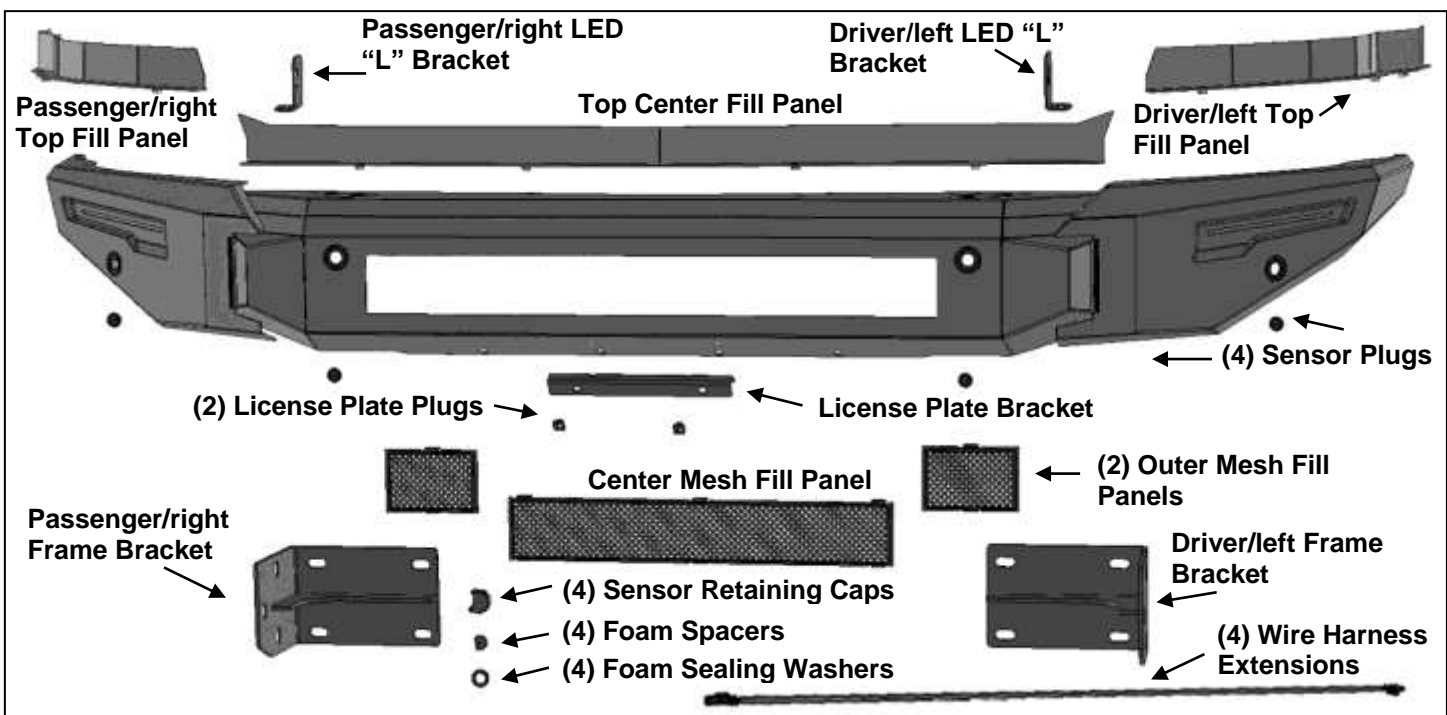

## PROCEDURE:

**REMOVE CONTENTS FROM BOX. VERIFY ALL PARTS ARE PRESENT. READ INSTRUCTIONS CAREFULLY BEFORE STARTING INSTALLATION. BUMPER IS HEAVY, ASSISTANCE IS HIGHLY RECOMMENDED TO AVOID POSSIBLE INJURY OR DAMAGE TO THE VEHICLE.**

1. Remove the license plate and bracket. On models with factory fog lights and/or sensors, unplug the wiring harness leading to the front bumper. Move all wiring harnesses away from bumper.
2. Open the hood and remove the plastic cover from the top of the radiator and the grille, **(Figure 1)**. Temporarily remove the plastic grille.

3. Remove the hardware at each end of the bumper attaching the outer bumper supports to the sides of the frame, **(Figure 2)**.
4. Place blocks or jack stands under the front bumper to support it during mounting bolt removal. Once the bumper has been supported, remove the lower bumper bolts attaching the inner bumper bracket to the frame bracket. Next, from above the bumper, remove the (2) bumper bolts from each side, **(Figure 3)**. **WARNING!** Assistance is required to hold the bumper in place during bolt removal to prevent the bumper from falling. Remove the bumper assembly.
5. Remove the driver/left bumper bracket from the end of the frame, **(Figures 4 & 5)**. Select the driver/left Frame Bracket. Reuse the (4) factory hex bolts to attach the Bracket to the end of the Frame, **(Figure 6)**. Repeat this **Step** to install the passenger/right side Frame Bracket. Do not fully tighten hardware at this time.
6. Carefully unwrap the Bumper assembly. Pull outward to unfold the passenger/right outer wing until fully extended, **(Figure 7)**. Anchor the Wing to the back of the Bumper with the included (2) 10mmx 30mm Hex Bolts, (2) 10mm Lock Washers and (2) 10mm x 20mm Small Flat Washers, **(Figure 8)**. Leave hardware loose at this time. Repeat this **Step** to unfold and attach the driver/left Wing to the Bumper. **IMPORTANT:** There is a small amount of adjustment in the Wings that can increase or decrease the final width of the Bumper. Loosen the (2) pivot bolts and the (2) anchor bolts and pull each Wing outward as far as possible to start, **(Figure 9)**. Snug hardware but do not fully tighten at this time.
7. Determine if accessory lights, (not included), or Screen Fill Panels will be installed at this time. **NOTE:** It may be easier to install Center Fill Panels and/or lights before installing Bumper.  
**Screen Fill Panel Installation** (do not install fill panels if installing lights).
  - a. Select desired long center or small outer Screen Fill Panels, **(Figure 10)**.
  - b. Attach Screen Fill Panels as needed with the included 6mm Button Head Combo Bolts and 6mm Flange Nuts, **(Figure 10)**. Fully tighten Fill Panel hardware at this time. Repeat to install all Panels as desired.**Inner center LED bar style light installation** (light not included).
  - a. Select the passenger/right "L" Light Bar Bracket, **(Figure 11)**. **NOTE:** "L" Brackets are offset to adjust for different widths of LED Bar Lights and can be installed on either side as needed.
  - b. Attach the "L" Bracket to the slot on the back of the Bumper with (1) 8mm x 25mm Hex Bolt, (2) 8mm Flat Washers, (1) 8mm Lock Washer and (1) 8mm Hex Nut, **(Figure 11)**. Repeat this **Step** to install the remaining "L" Bracket on the other side of the Bumper. **IMPORTANT:** The Bumper features slots designed for most 20" and 30" bar style lights. Attach the Brackets to the correct slots in the Bumper. If necessary, hold the light up to the slots to help determine correct slots to use.
  - c. Attach the light to the "L" Brackets with the hardware included with the light or the supplied (2) 8mm x 16mm Hex Bolts, (2) 8mm Lock Washers and (2) 8mm Flat Washers, **(Figure 11)**. Do not fully tighten hardware at this time.
8. Determine if vehicle is equipped with parking sensors. **NOTE:** Sensors must be installed in Bumper before installing Bumper Assembly.  
**Models without bumper sensors:**
  - a. From the front of the bumper, push the included Plastic Plugs into sensor mounting holes, **(Figure 12)**.**Models with bumper mounted sensors:**
  - a. Remove the sensors and wiring harness from the factory bumper.
  - b. Remove the factory sealing washer from the sensor. Attach the provided Foam Sealing Washer to the front of the sensor, **(Figure 11)**.

- c. Push the sensor in from the back of the Bumper until it is flush with the outer Bumper. Place (1) Foam Spacer over the end of the sensor. Push the Retaining Cap onto the sensor mount and snap into place, **(Figure 12)**.
  - d. Repeat the previous **Steps** for the remaining sensors.
  - e. Attach factory wiring harness to Bumper and plug into sensors. **IMPORTANT:** (4) Harness Extensions have been included to extend the ends of the factory harness to the sensors. Use as necessary.
9. With assistance, position the Bumper Assembly to the outside of the Frame Brackets. Temporarily support the weight of the Bumper. **WARNING:** To avoid possible injury or damage to the vehicle, do not proceed until the Bumper is fully and safely supported.
  10. Attach the Bumper to the Brackets with the included (6) 10mm x 35mm Hex Bolts, (12) 10mm x 27mm Large Flat Washers, (6) 10mm Lock Washers and (6) 10mm Hex Nuts, **(Figures 14 & 15)**. Do not fully tighten hardware at this time.
  11. Plug the bumper wiring harness into the main sensor harness.
  12. Level and adjust the Bumper and fully tighten all hardware. **IMPORTANT:** Adjust wings on bumper as needed and fully tighten all wing pivot and mounting hardware. If necessary, temporarily remove bumper to fully tighten inner 10mm anchor hardware.
  13. Attach the License Plate Bracket to the holes in the bumper with the included (2) 6mm x 20mm Button Head Bolts, (4) 6mm Flat Washers and (2) 6mm Nylon Lock Nuts. Insert (2) Plastic Plugs into the square holes in the Bracket. Reuse the factory screws to attach the license plate to the plastic plugs, **(Figure 17)**.
  14. Do periodic inspections to the installation to make sure that all hardware is secure and tight.

**To protect your investment,** Do not use any type of polish or wax that may contain abrasives that could damage the finish. Mild soap may be used to clean the MD1 Front Bumper assembly.

#### Driver/left Side Installation Pictured



**(Fig 1) Remove plastic cover and grille**

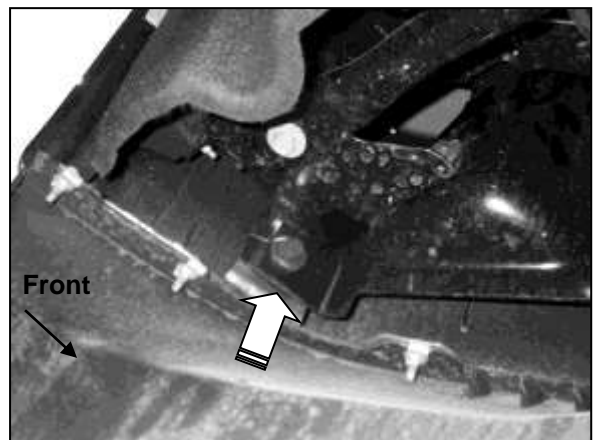

**(Fig 2) Remove bumper supports attaching outer end of bumper to frame (Driver/left side pictured)**

### Driver/left Side Installation Pictured

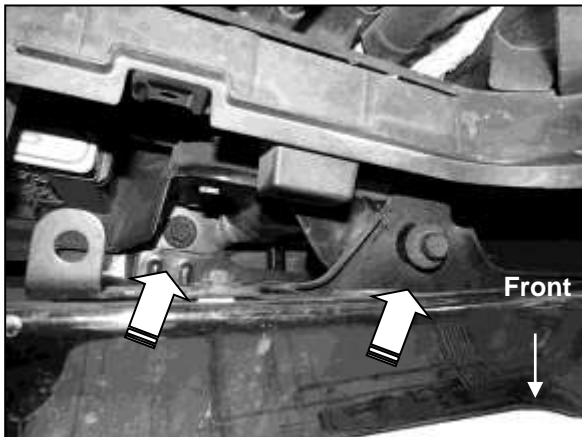

(Fig 3) Remove bumper bolts (arrows) to remove bumper (driver/left side pictured from above)

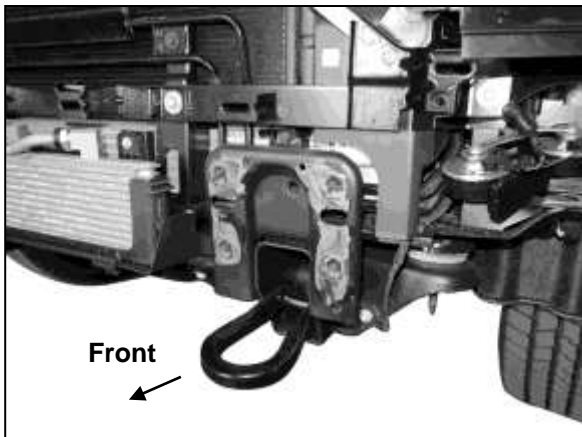

(Fig 5) Driver/left bumper bracket removed

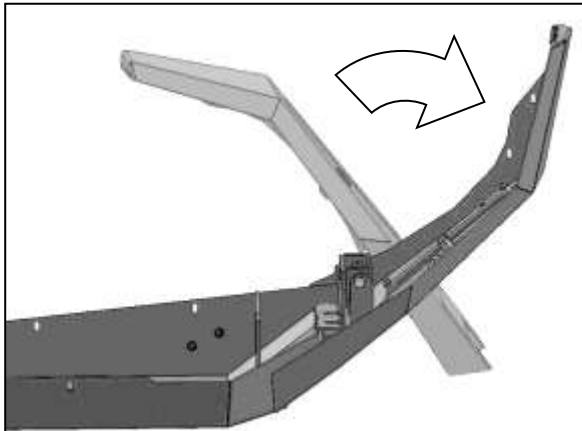

(Fig 7) Unfold outer Wings from center Bumper. Passenger/right side illustrated from below

**WARNING!** Do not remove bumper bolts unless the bumper is properly supported on blocks or stands or it may fall.

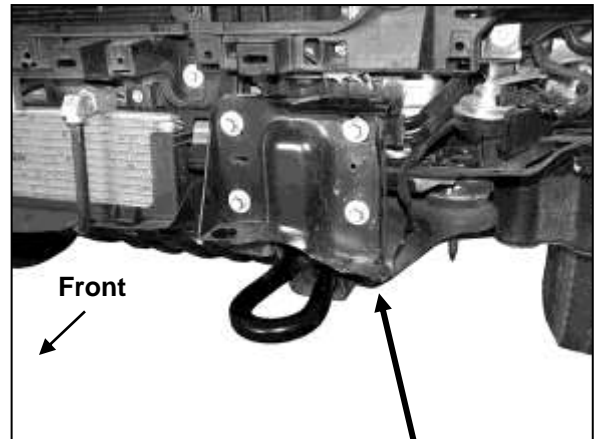

(Fig 4) Remove factory bumper brackets

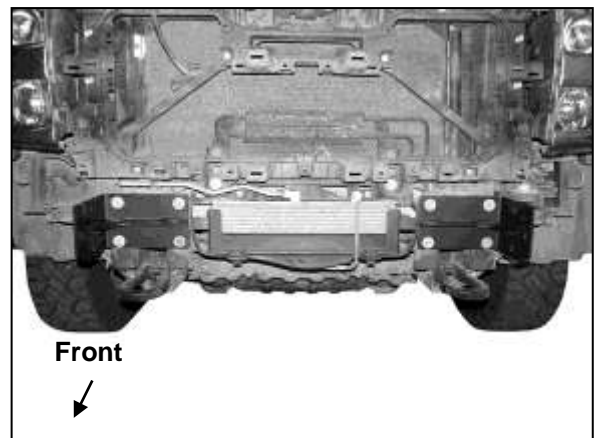

(Fig 6) Reuse factory bumper bolts to attach Frame Brackets to end of frame

**Driver/left Side Installation Pictured**

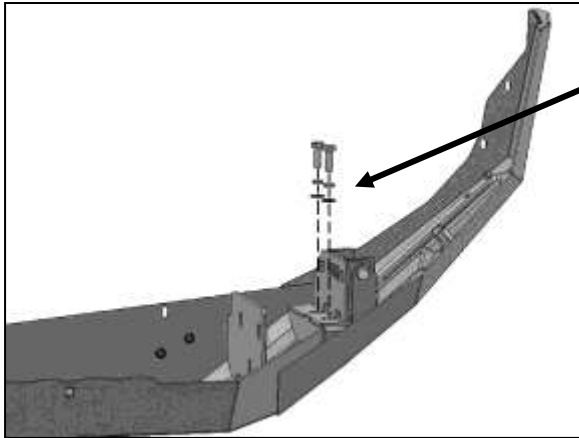

**(Fig 8) Anchor outer Wings to back of center Bumper**

- (2) 10mm x 30mm Hex Bolts
- (2) 10mm Lock Washers
- (2) 10mm x 20mm Small Flat Washers

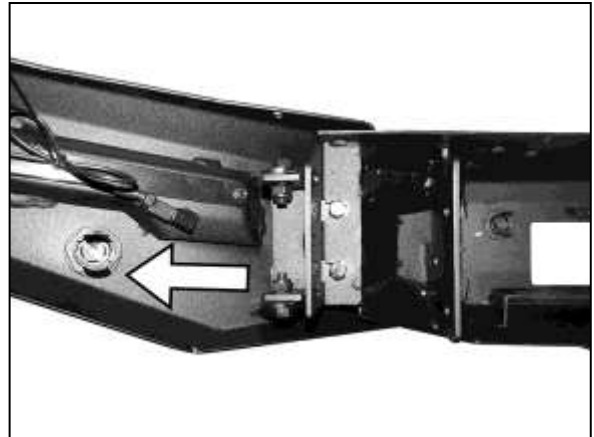

**(Fig 9) Loosen hardware and pull Wing outward to widen overall Bumper**

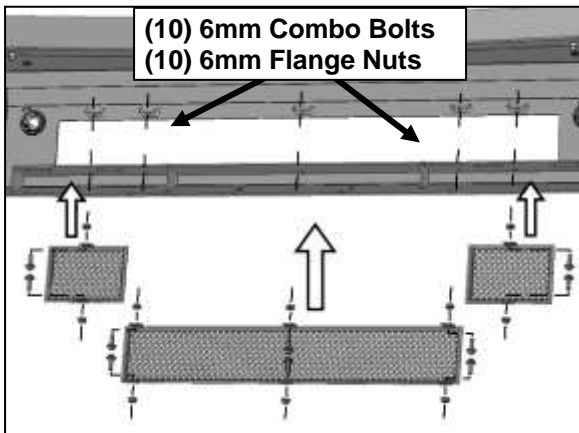

**(Fig 10) Attach Inner and Center Mesh Plates to tabs on the back of the bumper as desired**

- 8mm x 25mm Hex Bolt
- (2) 8mm Flat Washers
- 8mm Lock Washer
- 8mm Hex Nut

- 8mm x 16mm Hex Bolt
- 8mm Lock Washer
- 8mm Flat Washer

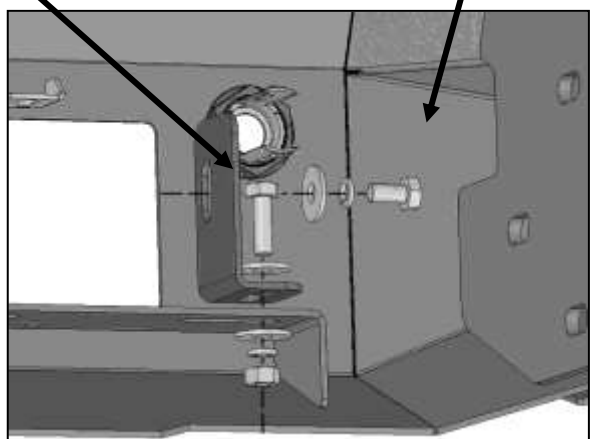

**(Fig 11) Passenger/right side "L" Bracket attached to the back of the Bumper. NOTE: Attach the "L" Bracket to the proper slot for the length of LED light**

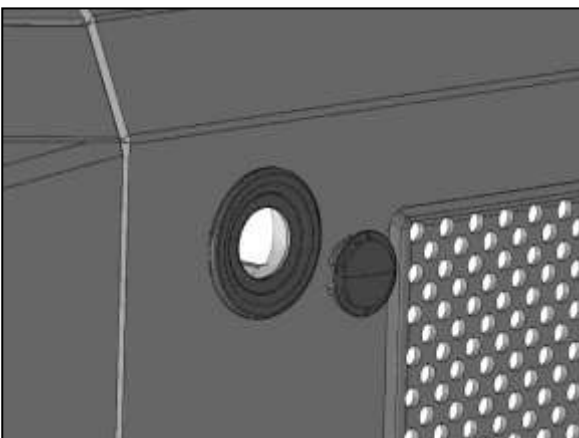

**(Fig 12) Models without sensors, push Plastic Plugs into the sensor mounts**

Driver/left side installation pictured

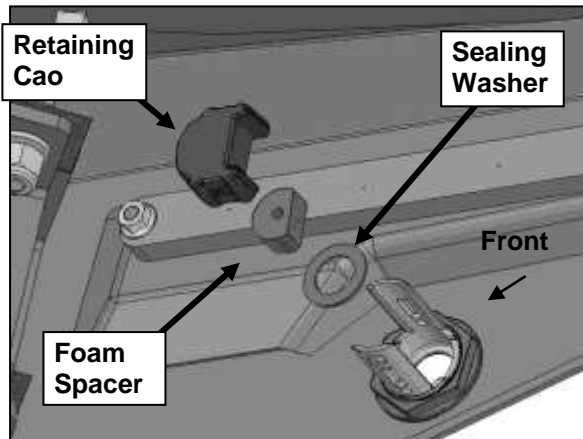

(Fig 13) Insert sensor with Foam Seal into sensor Mount. Place Foam Spacer onto sensor. Snap Cap onto sensor and Mount

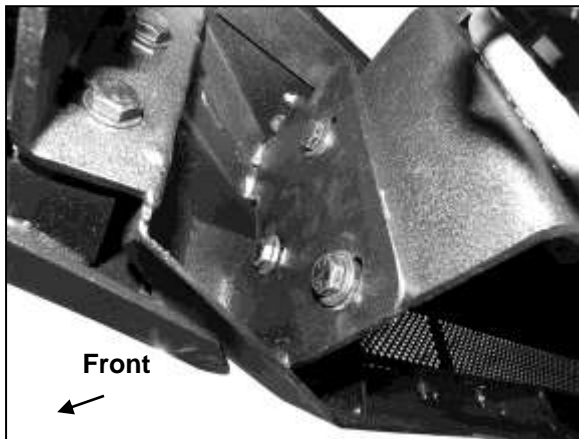

(Fig 15) Attach Bumper assembly to Frame Brackets (Driver/left side pictured)



**WARNING!** Do not crawl under bumper unless it is properly supported on blocks or stands or the bumper may fall.

- (3) 10mm x 35mm Hex Bolts
- (6) 10mm x 37mm Large Flat Washers
- (3) 10mm Lock Washers
- (3) 10mm Hex Nuts

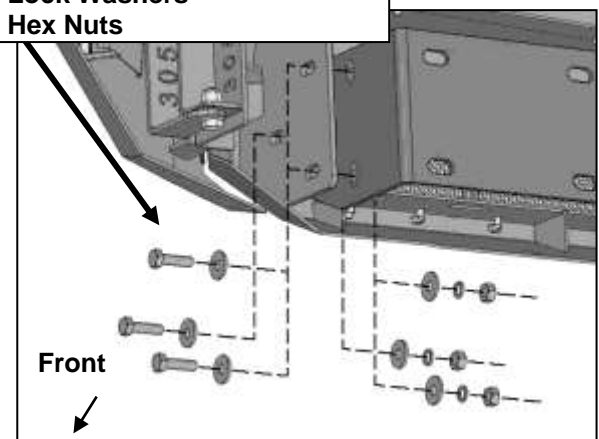

(Fig 14) Attach the Bumper to the outside of the Mounting Brackets (driver/left side illustrated)

- (2) 6mm x 20mm Button Head Bolts
- (4) 6mm Flat Washers
- (2) 6mm Nylon Lock Nuts

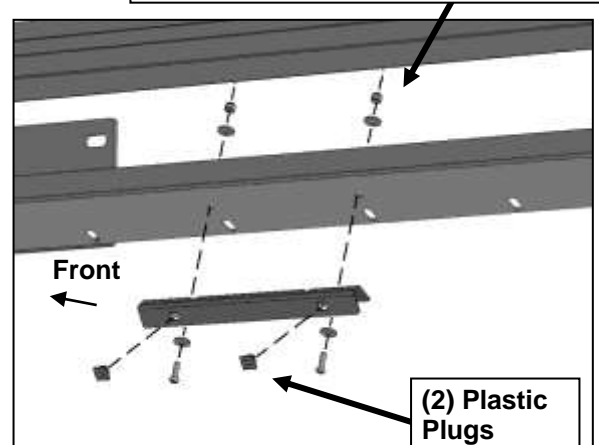

(Fig 16) Attach License Plate Bracket to Bumper

Complete Installation (pictured with Bull  
Nose Hoop and light, not included)

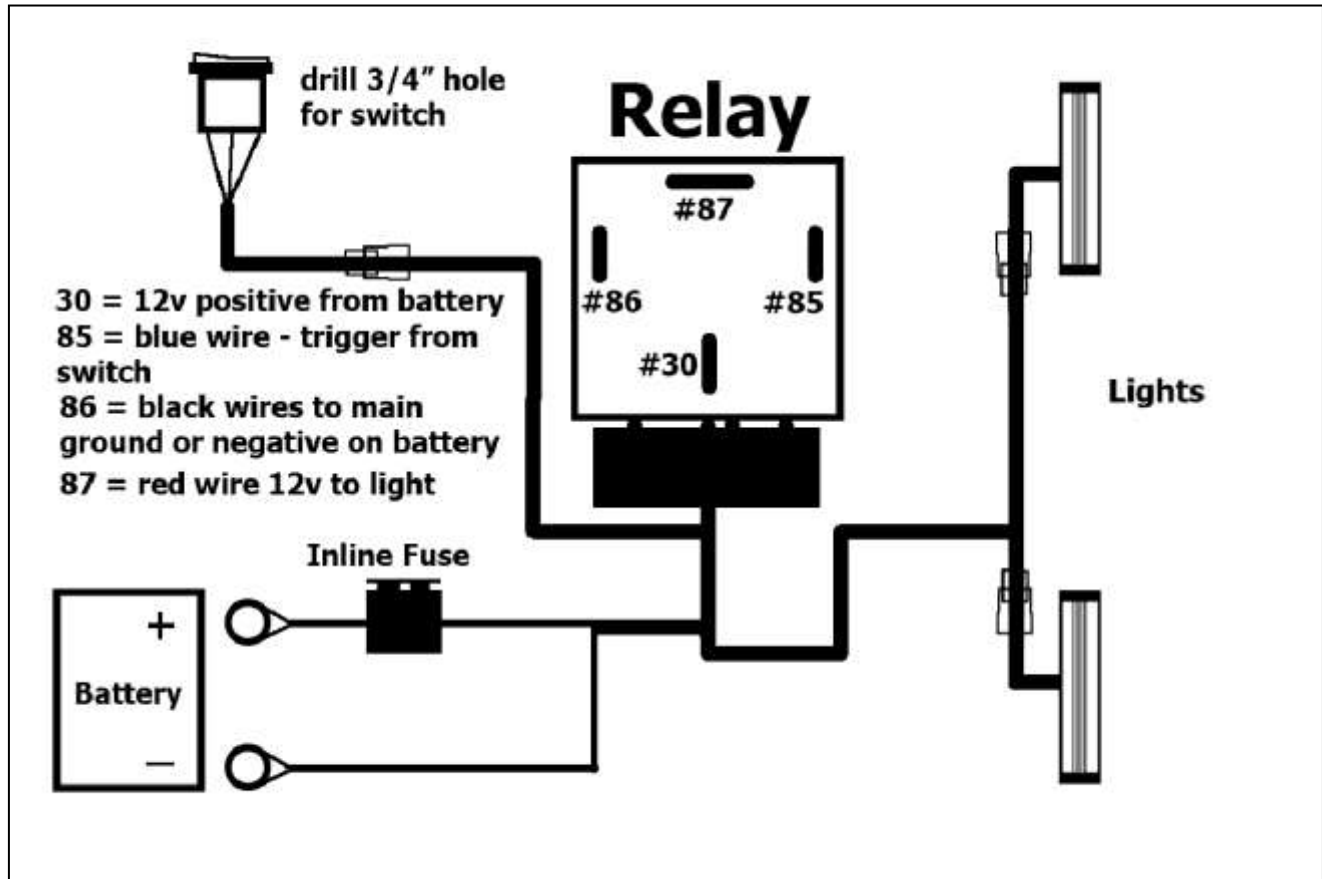

**GENERAL LIGHT WIRING PROCEDURE:**

1. REMOVE CONTENTS FROM BOX. VERIFY ALL PARTS ARE PRESENT. READ INSTRUCTIONS CAREFULLY. DRILLING IS REQUIRED. ELECTRICAL KNOWLEDGE IS HIGHLY RECOMMENDED.
2. Open hood and disconnect battery.
3. Unwrap preassembled wiring harness. Disconnect the plug in the harness leading to the lighted switch. Locate suitable mounting location for switch. Drill 3/4" hole in panel to mount switch. **IMPORTANT:** Do not drill any holes in panel until back of location is properly checked for clearance. Use of safety goggles is required.
4. Run switch harness through firewall on vehicle. Drill hole through firewall as required for harness plug. Highly recommend use of rubber grommet (not included) to protect harness. Feed switch harness plug through hole in firewall. Seal firewall with silicone as necessary.
5. Attach Relay and main harness to suitable location near battery (firewall or inner fender for example). Do not connect to battery at this time.
6. Attach switch plug to switch harness and tie harness away from anything that could damage harness.
7. Run the prewired light harness down to each light. Plug harness into prewired plug on each light. Tie wiring harness away from anything that could damage harness.



8. Attach the fused red positive and black negative wires on the main harness to the battery. **NOTE:**  
Attach black negative wire to negative terminal on battery or suitable chassis ground.
9. Reattach battery cables to battery. Installation is complete.
10. Do periodic inspections to the installation to make sure that all hardware is secure and tight and all wiring harnesses are properly secured and free from excessive movement.