



TEL: 1-866-XANATOS

INSTALLATION INSTRUCTIONS

MD1 FRONT BUMPER SKID PLATE

2015-19 CHEVY SILVERADO 25-3500

PART# AFB-SI35-SK

PARTS LIST:

1	Skid Plate	4	8mm Lock Washers
4	8mm x 25mm Button Head Bolts	1	5mm Allen Wrench
4	8mm x 24mm x 2mm Flat Washers		

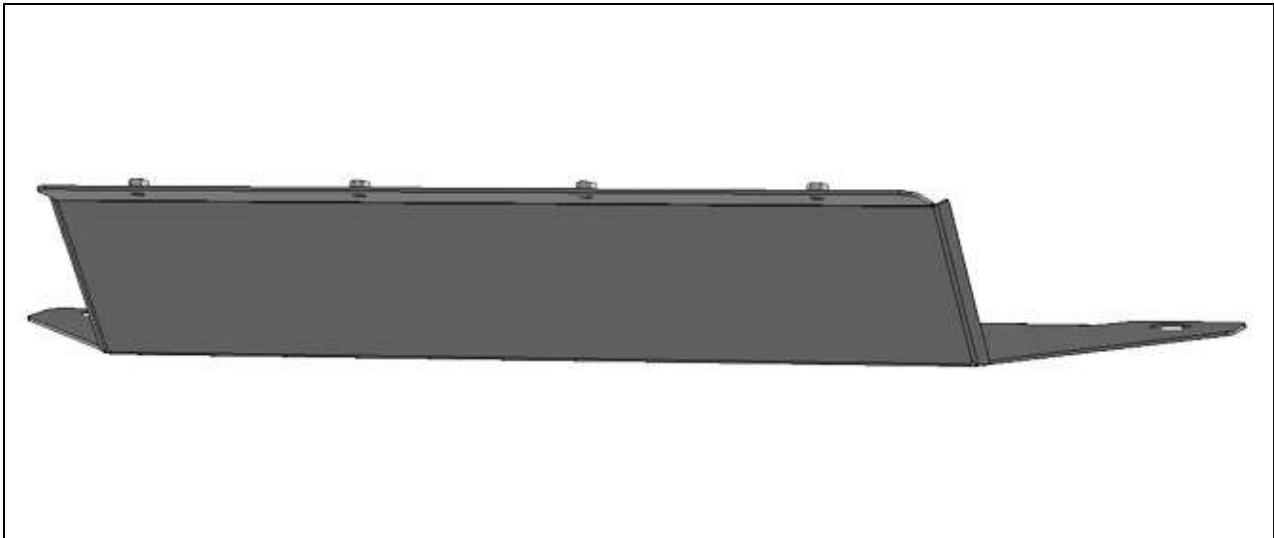

PROCEDURE:

REMOVE CONTENTS FROM BOX. VERIFY ALL PARTS ARE PRESENT. READ INSTRUCTIONS CAREFULLY BEFORE STARTING INSTALLATION. ASSISTANCE IS RECOMMENDED.

1. Remove the factory hex bolts from the bottom of the frame. **NOTE:** Hex bolts attach the tow hooks to the bottom of the frame, **(Figure 1)**. It is not necessary to remove the tow hooks, only remove the bottom hex bolts.
2. Carefully unwrap the Skid Plate.
3. With assistance, line up the front of the Skid Plate with the back of the MD1 Bumper.
4. Attach the Skid Plate to the back of the Bumper with the included (4) 8mm Button Head Bolts, (4) 8mm Lock Washers and (4) 8mm Flat Washers, **(Figure 2)**. Leave hardware loose.
5. Reuse the (2) factory hex bolts from **Step 1** to attach the rear mounting tabs on the end of the Skid Plate to the bottom of the frame, **(Figure 2)**.
6. Level and adjust the Skid Plate and fully tighten all hardware, **(Figure 3)**.
7. Do periodic inspections to the installation to make sure that all hardware is secure and tight.

To protect your investment, Do not use any type of polish or wax that may contain abrasives that could damage the finish. Mild soap may be used to clean the Skid Plate.

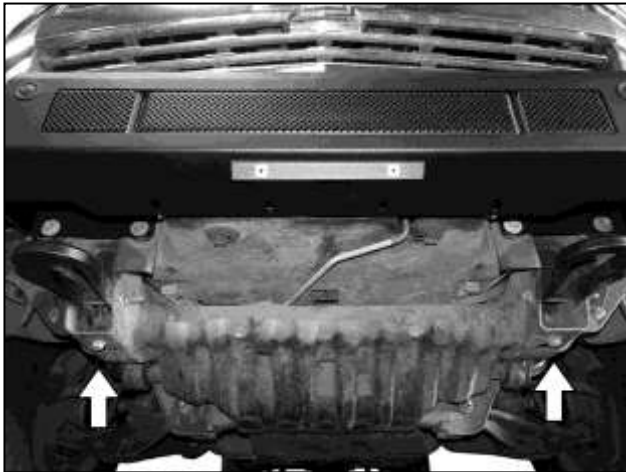

(Fig 1) Temporarily remove hex bolts (arrows) attaching bottom of tow hooks to frame

(4) 8mm Button Head Bolts
(4) 8mm Lock Washers
(4) 8mm Flat Washers

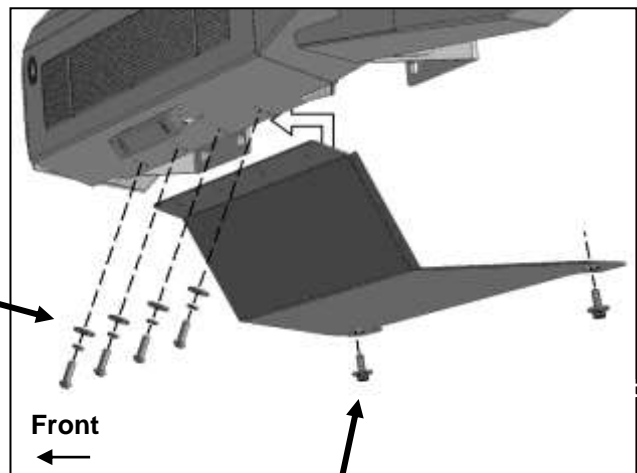

(Fig 2) Attach Skid Plate to back of Bumper. Reuse factory hex bolts to attach rear tabs on Skid Plate to bottom of frame

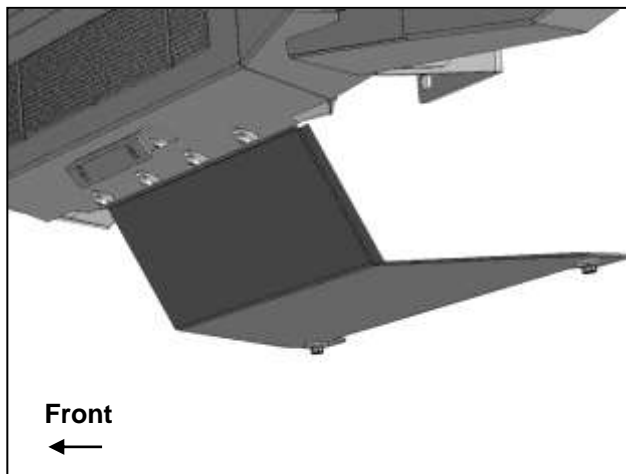

(Fig 3) Skid Plate fully installed

MD1 FRONT BUMPER SKID PLATE
2015-19 CHEVY SILVERADO 25-3500