



INSTALLATION INSTRUCTIONS
APPLICATION □ NISSAN PATHFINDER 1999^{1/2}-2000

TEL □ 1-866-XANATOS

MOUNT KIT

B B 1 1 0 0 0 9 A - S P

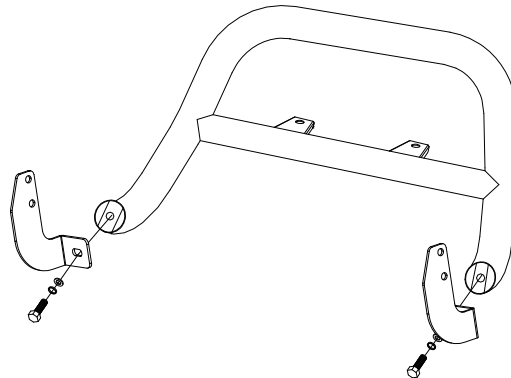

QTY	PARTS KIT CONTENTS DESCRIPTION	TOOLS REQUIRED
1	SAFARI BAR ASSEMBLY (PURCHASED SEPARATELY)	19MM SOCKET
1	MOUNT BRACKET-DRIVER SIDE	14MM SOCKET
1	MOUNT BRACKET-PASSENGER SIDE	RATCHET
2	M12×50 HEX BOLT	TORQUE WRENCH
2	Φ12 FLAT WASHER	
2	Φ12 MEDIUM SPRING WASHER	

- STEP1. Remove the contents from the box and check for any damage. Verify all parts against the parts list.
- STEP2. Read and understand instructions completely before beginning installation.
- STEP3. Determine Driver and Passenger Mount Brackets from figure above.
- STEP4. Remove the six (6) screws from the lower part of the bumper that secure the plastic shroud. Move plastic out of the way to gain access to the tow hook bolts.
- STEP5. Locate the 10mm bolts on the side of the frame that secure the tow hook.
- STEP6. Remove the two (2) front bolts from each side, install the bracket, and replace the bolts.
- STEP7. Attach Safari Bar to Mount Brackets using the 1/2" hardware. Leave loose.
- STEP8. Center and level the Safari Bar, Tighten and torque fasteners to:
10mm Bolts.....35Ft.Lbs.
1/2" fasteners.....65Ft.Lbs.
- STEP9. Re-install the screws that secure the plastic shroud.