



TEL: 1-866-XANATOS

INSTALLATION INSTRUCTIONS

SENSOR RELOCATION KIT 3" ROUND BULL BAR

2014-18, 2019 "LD" CHEVY SILVERADO 1500

2014-18, 2019 "LIMITED" GMC SIERRA 1500

PART# BPS01B

Part List:

| | | | |
|---|-------------------------------------|---|---|
| 1 | Driver/left Sensor Housing | 2 | Wire Harness Extensions |
| 1 | Passenger/right Sensor Housing | 6 | 8-1.25mm x 20mm Button Head Bolts |
| 1 | Driver/left side Housing Back Cover | 6 | 8mm x 16mm x 1.6mm Flat Washers |
| 1 | Passenger/right Housing Back Cover | 6 | 8mm Lock Washers |
| 2 | 3in Front Clamping Bracket | 4 | 6-1.00mm x 20mm Button Head Combo Bolts |
| 2 | 3in Rear Clamping Bracket | 4 | 4mm x 15mm Self Tapping Screws |
| 2 | Sensor Retaining Caps | 1 | 4mm Wrench |
| 2 | 20mm x 10mm Foam Spacers | 1 | 5mm Wrench |
| 2 | 15mm x 25mm Foam Seals | 4 | 75mm x 35mm x 2mm Adhesive Foam Strips |
| 4 | Rubber Grommets | | |

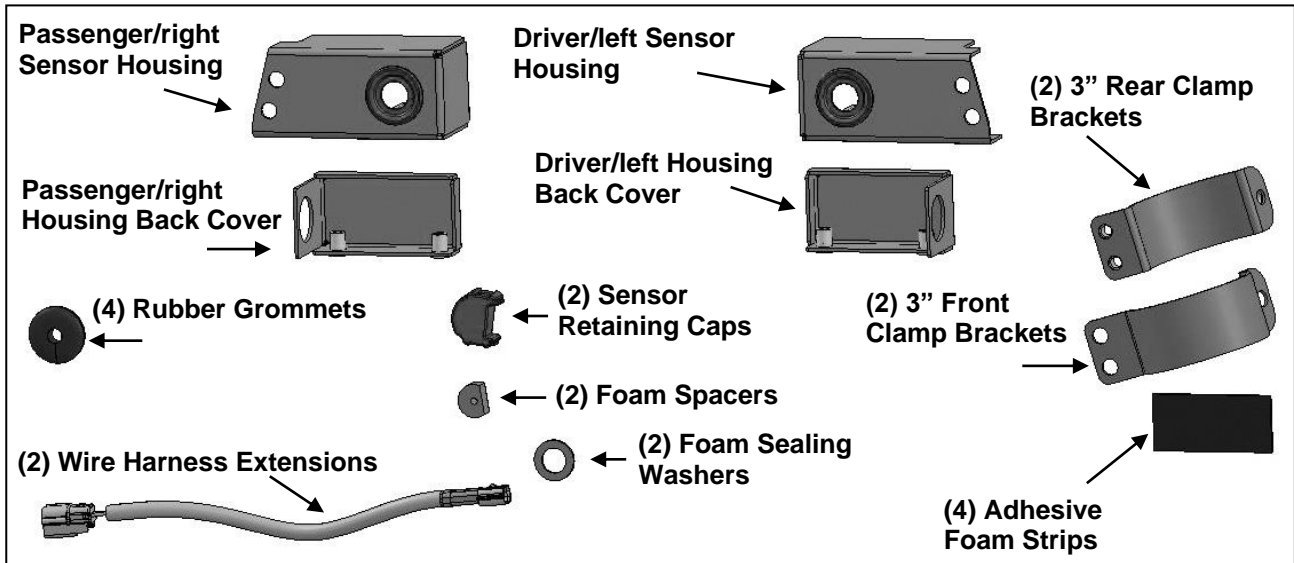

PROCEDURE:

READ INSTRUCTIONS CAREFULLY BEFORE STARTING INSTALLATION.

1. Select (1) Outer Clamp Half and (1) Foam Pad, **(Figure 1)**. Apply the Foam Pad to the inside of the Outer Clamp Half. Trim Foam as needed for proper fit. Next select (1) Inner Clamp Half. Repeat to apply (1) Foam Pad to inside of Clamp Half, **(Figure 1)**. Repeat previous **Step** to apply Foam Pads to inside of remaining Inner and Outer Clamp Halves.
2. Wrap (1) Outer and (1) Inner Clamp Half around the Bull Bar tube. Attach the Outer to the Inner Clamp with (1) 8mm x 20mm Button Head Bolt, (1) 8mm Lock Washer and (1) 8mm Flat Washer, **(Figure 2)**. Leave hardware loose.
3. Unplug and remove the center sensors from the bumper, **(Figure 3)**. Remove the retainers from the bumper, **(Figure 4)**.
4. Locate the driver/left Sensor Housing. Select (1) sensor. Remove the front seal from the sensor, **(Figure 5)**. Apply the included Foam Seal to the front of the sensor. Push the sensor into the sensor mount in the Relocation Housing, **(Figure 6)**. Place (1) Foam Spacer over the sensor and snap the Retaining Cap onto the tabs on the Sensor Mount.
5. Insert the driver/left Sensor Housing between the Inner and Outer Clamps, **(Figure 7)**. Attach the Clamps to the Housing with the included (2) 8mm x 20mm Button Head Bolts, (2) 8mm Lock Washers and (2) 8mm Flat Washers. Snug but do not fully tighten Clamp hardware.
6. Select (1) Wire Harness Extension Cable and (2) Rubber Grommets, **(Figure 8)**. Slide the Grommets onto each end of the Wire Harness. Select the driver/left Sensor Housing Back Cover, **(Figure 9)**. Push the larger "female" end of the harness through the hole in the Cover. Plug the end of the Harness into the sensor. Push the Rubber Grommet into the hole in the Cover. Attach the Cover to the Sensor

Housing with the included (2) 6mm x 20mm Button Head Combo Bolts, **(Figure 10)**. Fully tighten this hardware only at this time.

7. Insert the smaller "male" end of the Harness into and through the hole in the bumper. Plug the Harness Extension into the factory wire harness. Push the Rubber Grommet into the hole in the bumper to protect the Harness, **(Figure 11)**.
8. Repeat **Steps 1—7** to assemble and install the passenger/right side Sensor Housing.
9. Properly level and adjust the Sensor Housing and Clamps to match the angle of the bumper. **NOTE:** It may be necessary to loosen the Bull Bar and adjust angle of the Bull Bar to parallel the face of the bumper for proper sensor function. Once properly adjusted and aligned, fully tighten all hardware and secure the Wire Harnesses.
10. Do periodic inspections to the installation to make sure that all hardware is secure and tight.

To protect your investment, Do not use any type of polish or wax that may contain abrasives that could damage the finish. Mild soap may be used to clean the Sensor Relocation assembly.

Driver/Left Side Installation Pictured

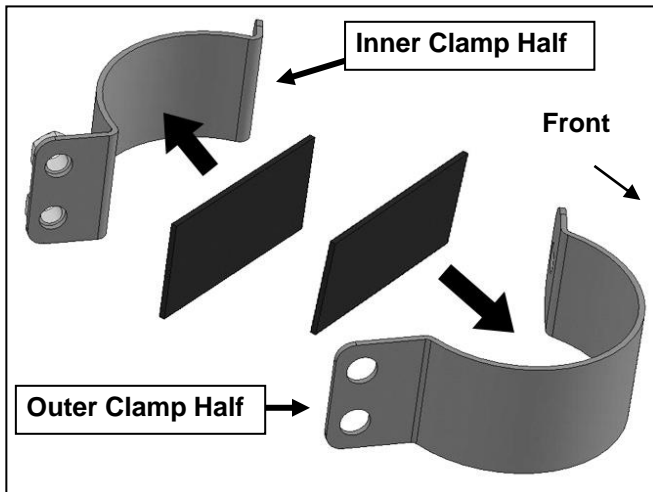

(Fig 1) Apply Foam to inside of Clamps

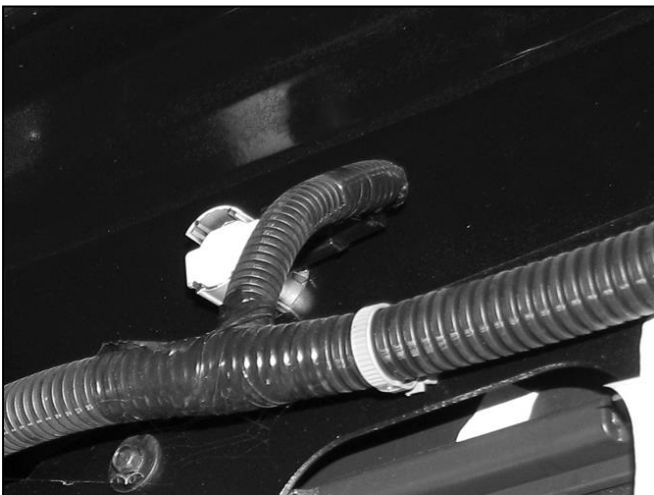
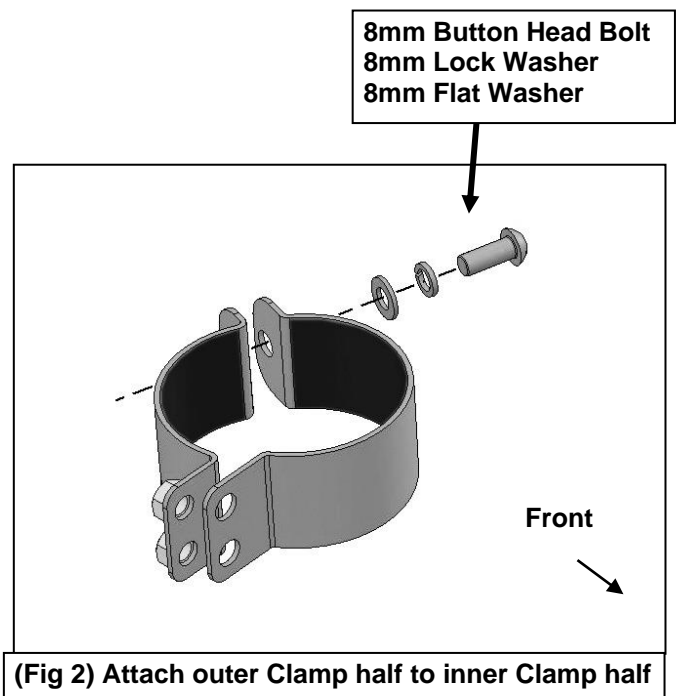

(Fig 3) Unplug and remove OE center sensors from the back of the bumper (Example ONLY)

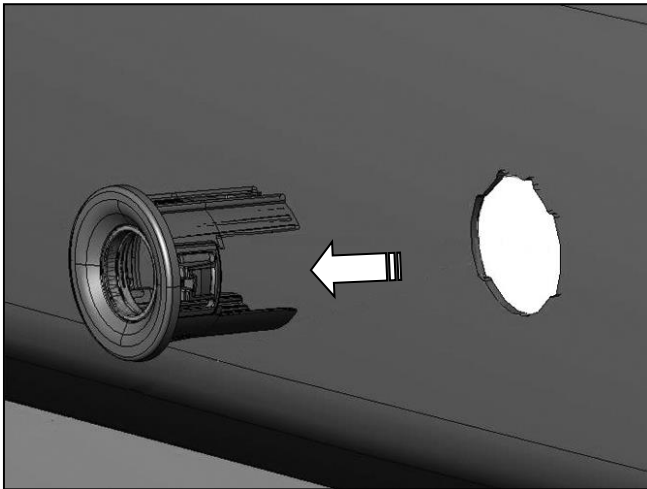

(Fig 4) Remove OE sensor retainer from bumper

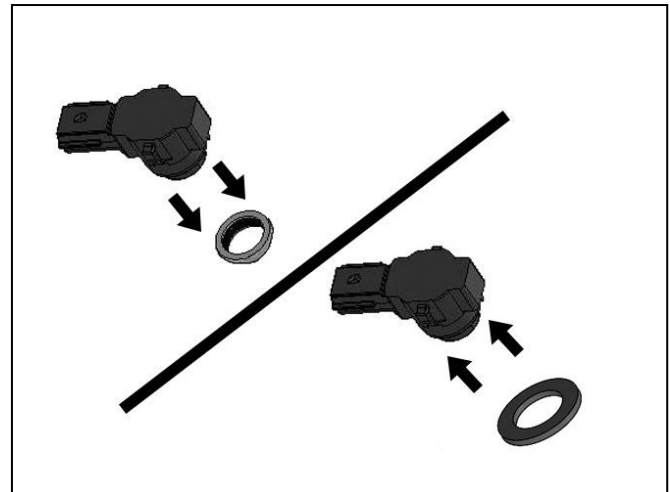

(Fig 5) Remove silicone seal from sensor.
 Slide large Seal over end of sensor

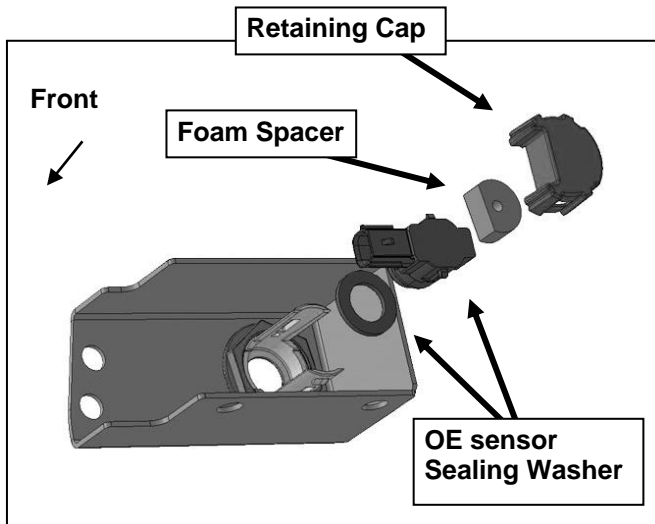

(Fig 6) Sensor Assembly attached to the back of the sensor sleeve on the Driver/left side Front Bracket

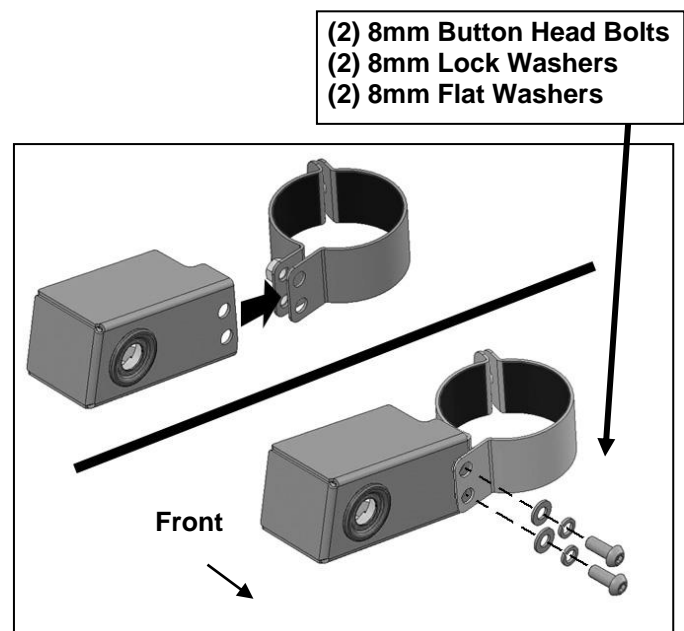

(Fig 7) Slide Sensor Housing between inner and outer Clamp Halves

Driver/Left Side Installation Pictured



(Fig 8) Slide (2) Rubber Grommets onto Wire Harness Extension



(Fig 9) Insert Harness Extension into driver/left Back Cover and plug into sensor in Housing

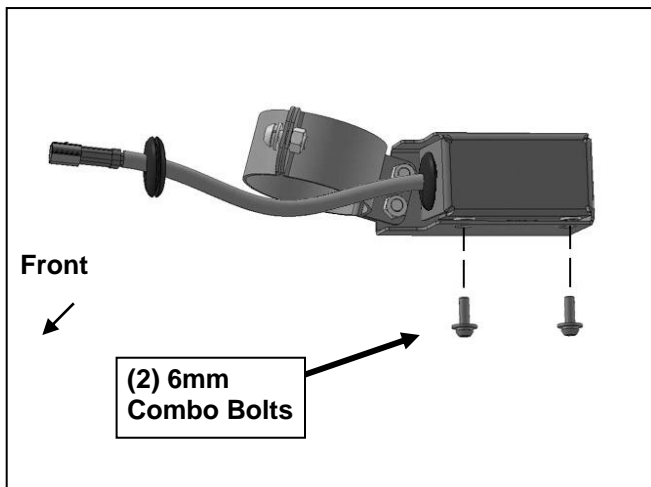

(Fig 10) Slide Back Cover into driver/left Housing. Push Grommet into hole in Cover

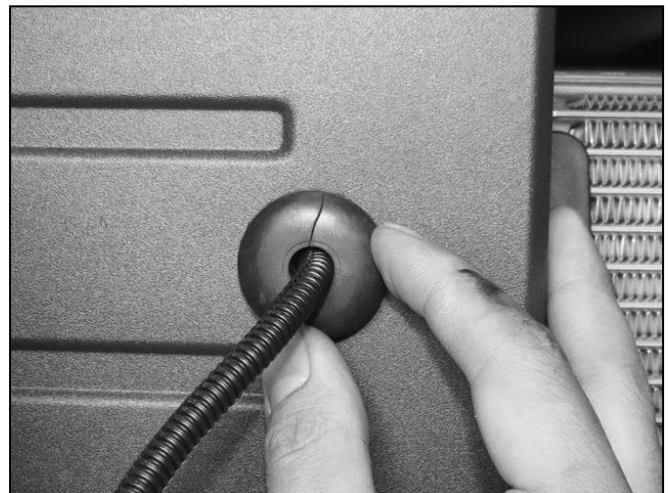

(Fig 11) Plug Harness Extension into factory sensor harness. Push Rubber Grommet into sensor hole in bumper (bumper pictured for example only)