

**UNIVERSAL SLIDE TRAY WITH AL. CHECKER PLATE FOR MID  
SIZE PICKUPS (TOYOTA TACOMA 15-23/CHEVY COLORADO  
19-23/FORD RANGER / 22-23 NISSAN FRONTIER / 21-23 JEEP  
GLADIATOR**

---



## **INSTALLATION INSTRUCTIONS**

**UNIVERSAL SLIDE TRAY WITH AL. CHECKER PLATE FOR MID  
SIZE PICKUPS (TOYOTA TACOMA 15-23/CHEVY COLORADO  
19-23/FORD RANGER / 22-23 NISSAN FRONTIER / 21-23 JEEP  
GLADIATOR**

**PART # BSCP03B**

# UNIVERSAL SLIDE TRAY WITH AL. CHECKER PLATE FOR MID SIZE PICKUPS (TOYOTA TACOMA 15-23/CHEVY COLORADO 19-23/FORD RANGER / 22-23 NISSAN FRONTIER / 21-23 JEEP GLADIATOR

## Before Installation

- Please read the instruction completely for easy installation, which will also help you to avoid scratches or other potential damages to your appealing car.
- The figures here are for reference only and may have differences with the actual product you received, however they share the same assembly way.

## Care and Cleaning

- Mild soap may be used also to clean the Product.
- Please periodically check and retighten all the hardware and clean the investment for a refresh look.

## Parts list

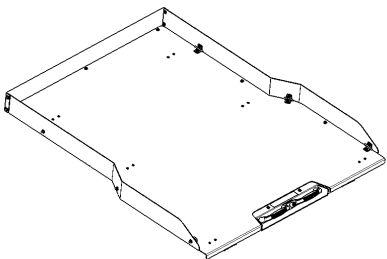
NO.	QTY	NAME	NO.	QTY	NAME
①	1	 <p style="text-align: center;">Slide tray</p>			
Hardware list :					
②	4	Hex bolt M10_65	③	8	Large washer D12 (12x44x4mm)
④	4	Lock washer D10	⑤	4	Hex nut M10
⑥	4	φ16×12 Pastic washer			

## Installation Steps

### Installation Figure:

**UNIVERSAL SLIDE TRAY WITH AL. CHECKER PLATE FOR MID  
SIZE PICKUPS (TOYOTA TACOMA 15-23/CHEVY COLORADO  
19-23/FORD RANGER / 22-23 NISSAN FRONTIER / 21-23 JEEP  
GLADIATOR**

---

# **UNIVERSAL SLIDE TRAY WITH AL. CHECKER PLATE FOR MID SIZE PICKUPS (TOYOTA TACOMA 15-23/CHEVY COLORADO 19-23/FORD RANGER / 22-23 NISSAN FRONTIER / 21-23 JEEP GLADIATOR**

Step 1: Put the slide tray on the truck bed, adjust the base of slide tray to appropriate position.

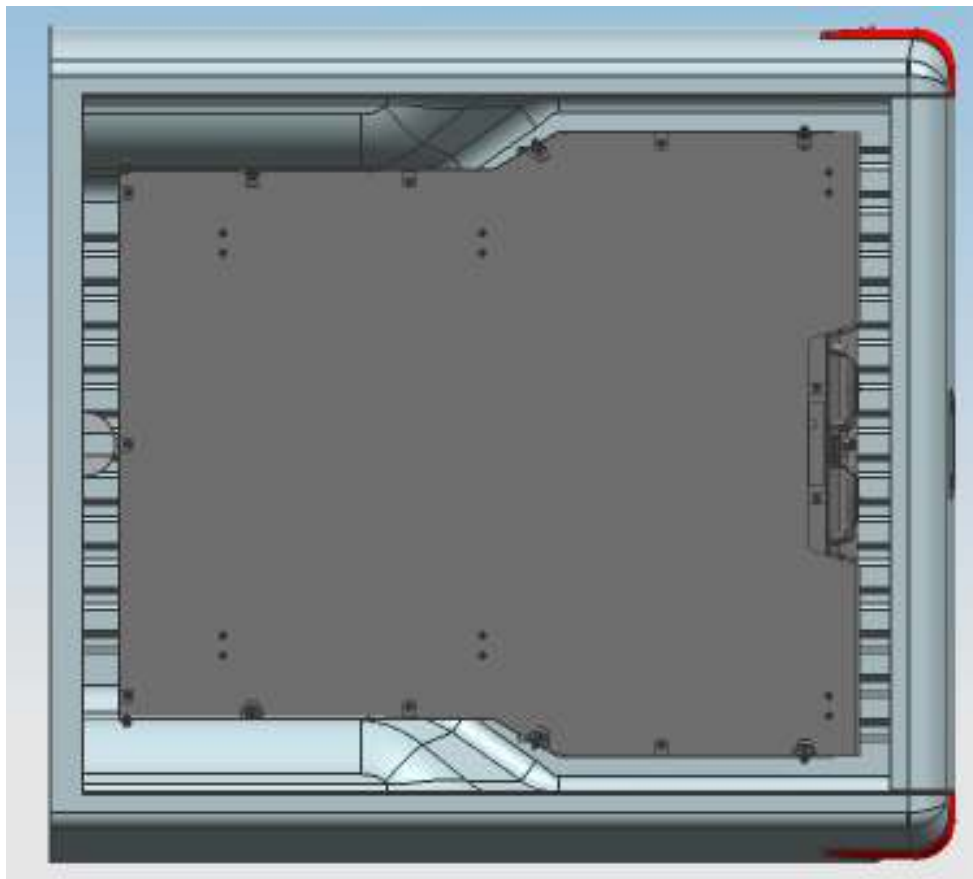

Step 2: After adjusted the position, remove the plate from the base according to the following steps.

**UNIVERSAL SLIDE TRAY WITH AL. CHECKER PLATE FOR MID  
SIZE PICKUPS (TOYOTA TACOMA 15-23/CHEVY COLORADO  
19-23/FORD RANGER / 22-23 NISSAN FRONTIER / 21-23 JEEP  
GLADIATOR**

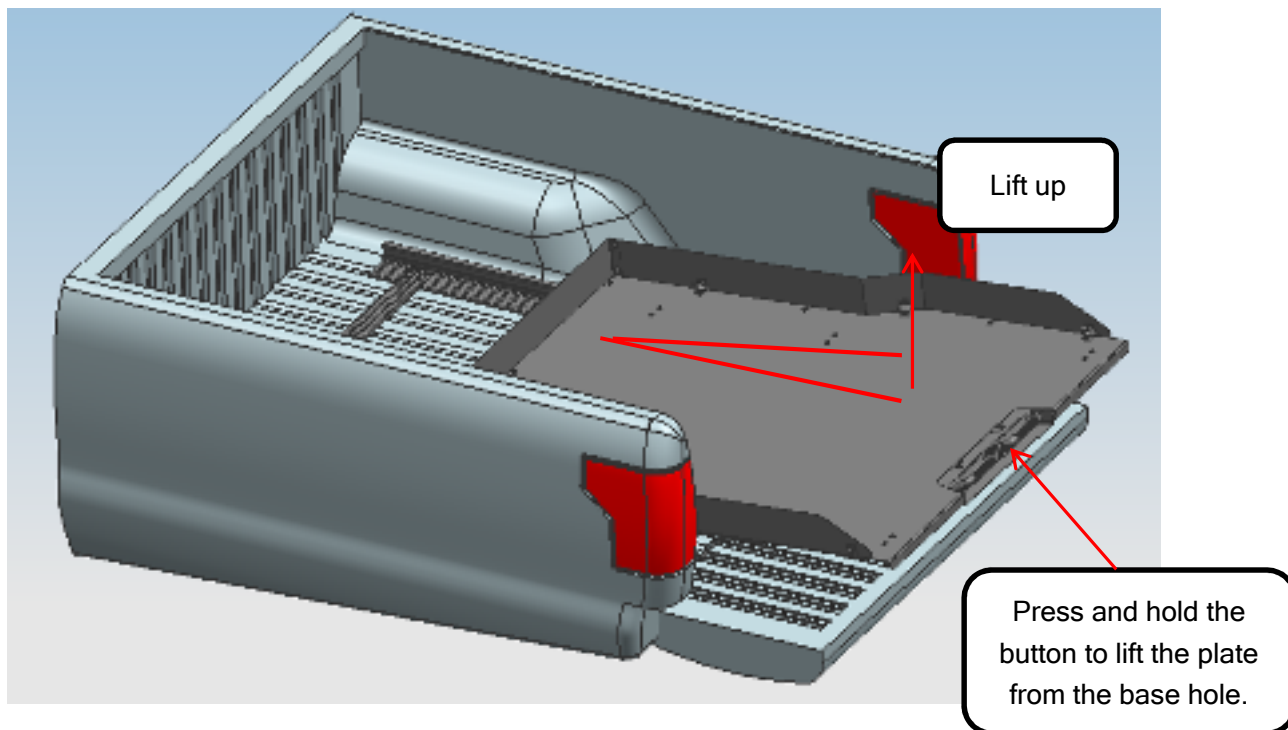
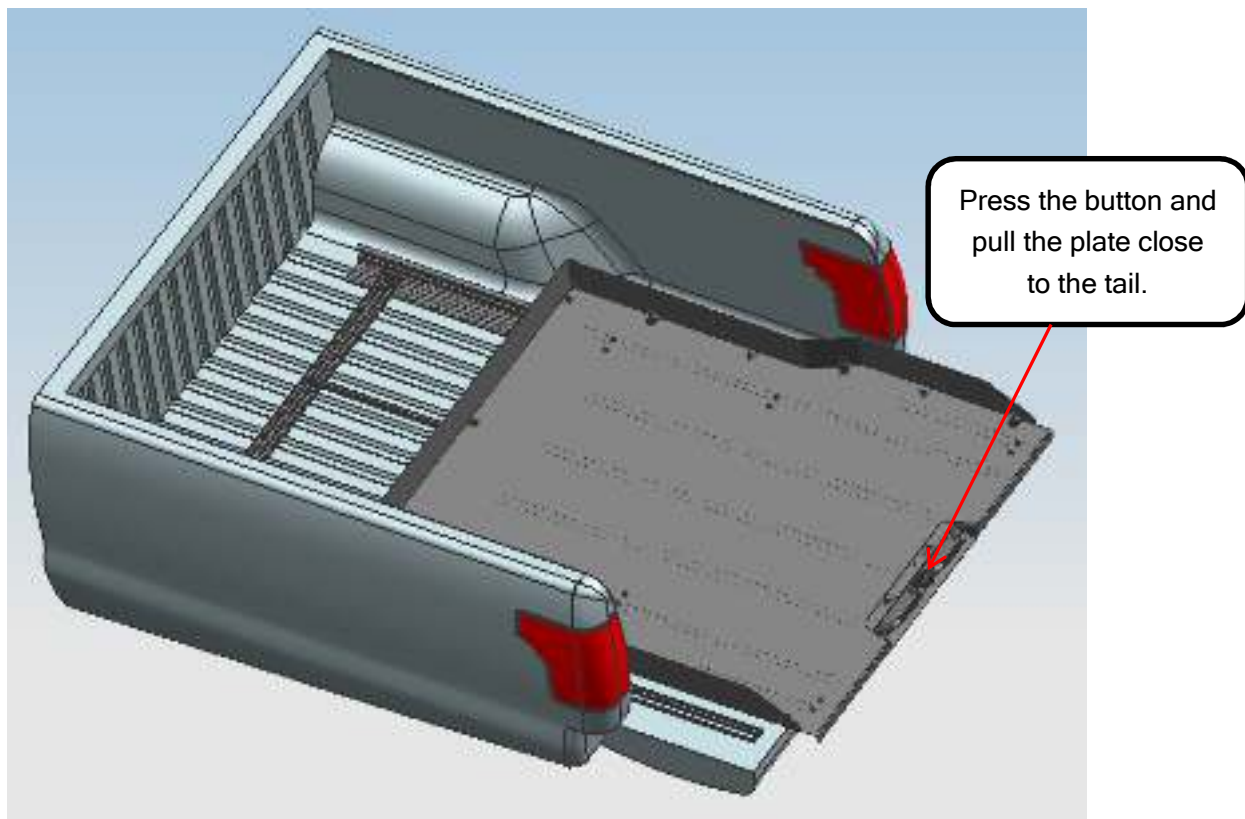

**UNIVERSAL SLIDE TRAY WITH AL. CHECKER PLATE FOR MID  
SIZE PICKUPS (TOYOTA TACOMA 15-23/CHEVY COLORADO  
19-23/FORD RANGER / 22-23 NISSAN FRONTIER / 21-23 JEEP  
GLADIATOR**

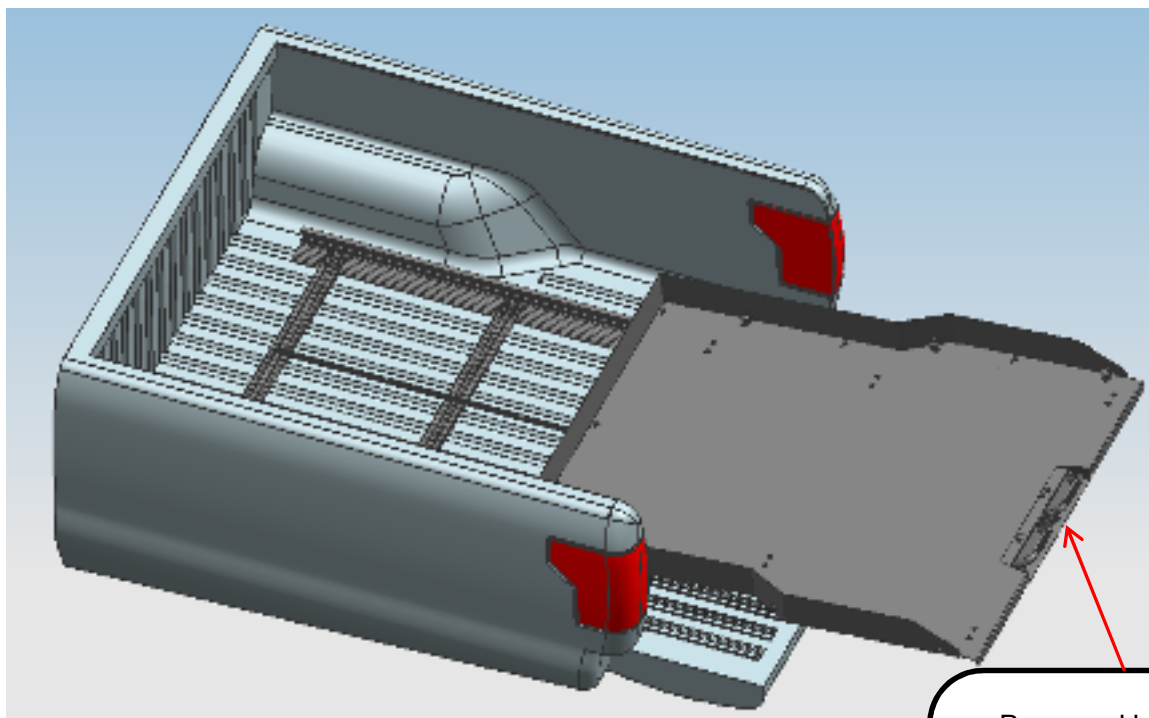

Press and hold the button, and pull the plate out, you can remove whole plate when it is near the end of the base.

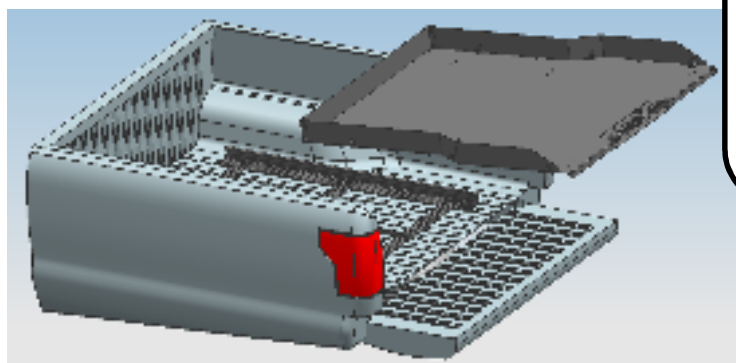

Step 3: Drill 4 holds ( $\varnothing 12\text{mm}$ ) on the aluminum base, as figure shown below. Holds on each side should be kept in the same distance;

# UNIVERSAL SLIDE TRAY WITH AL. CHECKER PLATE FOR MID SIZE PICKUPS (TOYOTA TACOMA 15-23/CHEVY COLORADO 19-23/FORD RANGER / 22-23 NISSAN FRONTIER / 21-23 JEEP GLADIATOR

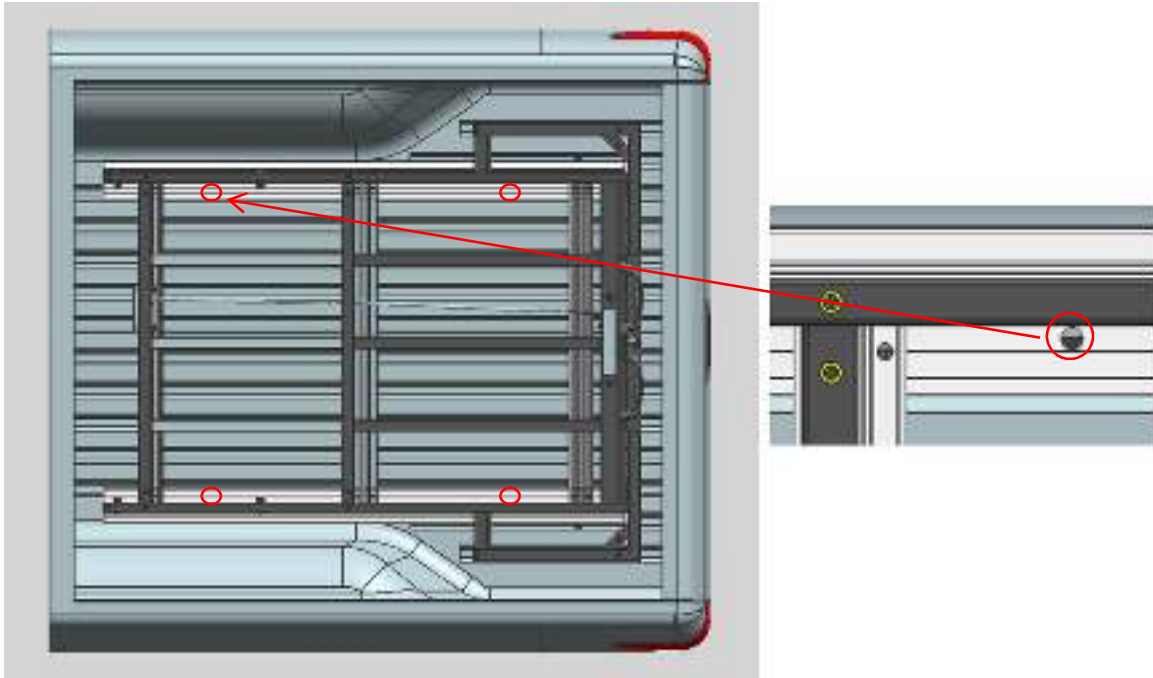

Step 4: Install the base of slide tray ① on the truck bed with hardwares ② ③ ④ ⑤ ⑥

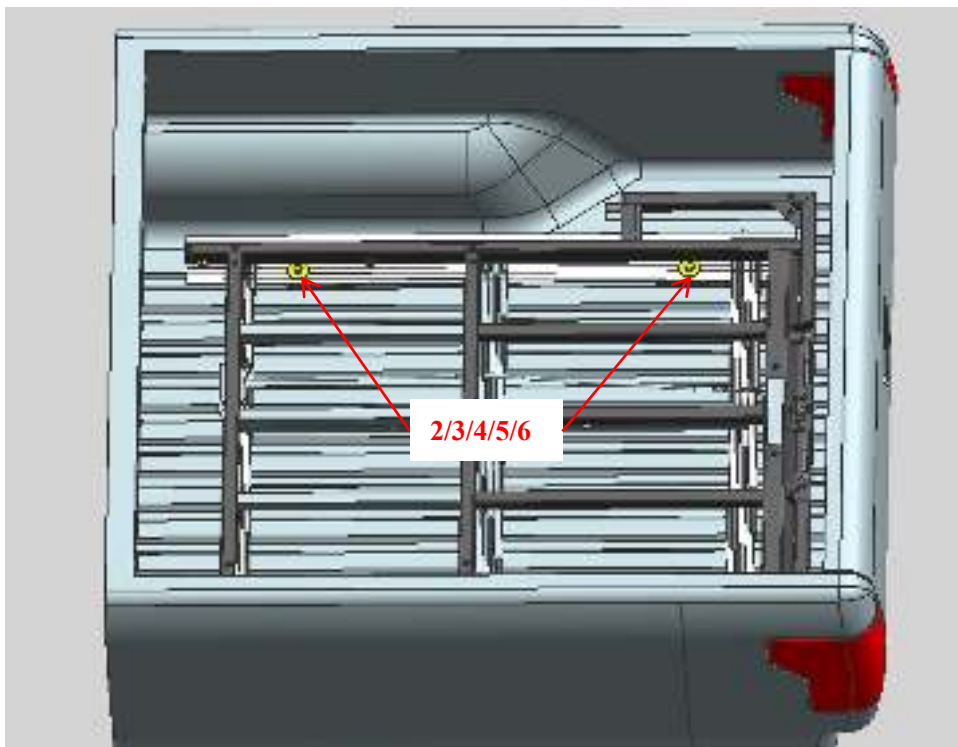

Step 5: Install the plate on the base according to the remove method.

Step 6: Test and make sure that the slide tray is steadily fixed, fully tighten all hardware.

Step 7: Installation is finished, pick up all tools.

## NOTE

# **UNIVERSAL SLIDE TRAY WITH AL. CHECKER PLATE FOR MID SIZE PICKUPS (TOYOTA TACOMA 15-23/CHEVY COLORADO 19-23/FORD RANGER / 22-23 NISSAN FRONTIER / 21-23 JEEP GLADIATOR**

Any damages and losses caused by improper installation and application, goes beyond our quality warranty.



- [866-926-2867](tel:866-926-2867)
- Email: [info@blackhorseoffroad.com](mailto:info@blackhorseoffroad.com)
  - Mon-Fri 9AM-6PM EST
  - Headquarters
- 39 ST. MARY'S PLACE FREEPORT, NY 11520