



# **INSTALLATION INSTRUCTIONS**

**EXCEED RUNNING BOARD FOR 2020 TOYOTA HIGHLANDER**

**PART # EX-T2070**

## Before Installation

- Please read the instruction completely for easy installation, which will also help you to avoid scratches or other potential damages to your appealing car.
- The figures here are for reference only and may have differences with the actual product you received, however they share the same assembly way.

## Care and Cleaning

- Mild soap may be used also to clean the Product.
- Please periodically check and retighten all the hardware and clean the investment for a refresh look.

## Parts list

NO.	QTY	NAME	NO.	QTY	NAME
①	1	Front Bracket (L)	②	1	Front Bracket (R)
③	1	Rear Bracket (L)	④	1	Rear Bracket (R)
⑤	4	Support Plates	⑥	8	T Bolt M10_40
STANDARD PARTS LIST:					
⑧	8	T Bolt M6x20	⑨	8	Spring Washer D6
⑩	8	Flat Washer D6 (6x22x2mm)	⑪	8	Hex Nut M6

⑫	12	Hex Nut M10	⑬	12	Spring Washer D10
⑭	12	Flat Washer D10_27_3	⑮	4	Hex Bolt M10_50

## Installation Steps

### Installation Figure:

**Front Bracket**

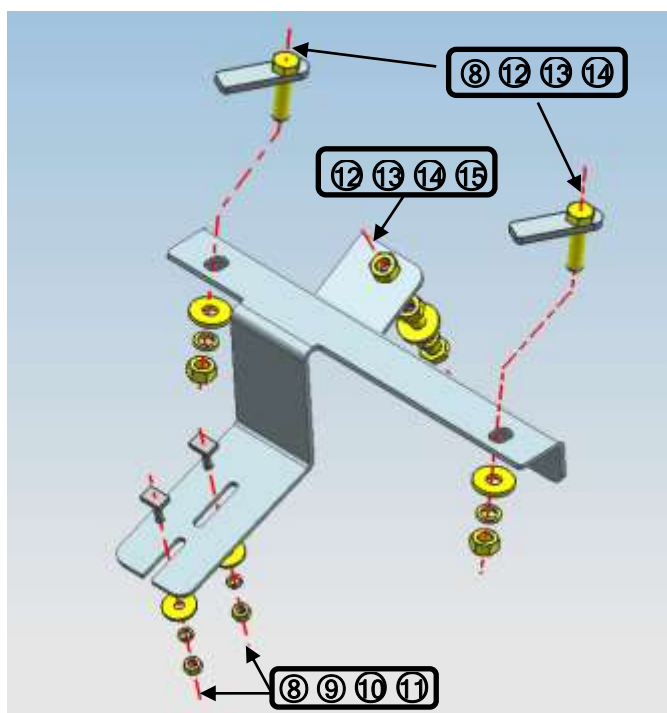

**Rear Bracket**

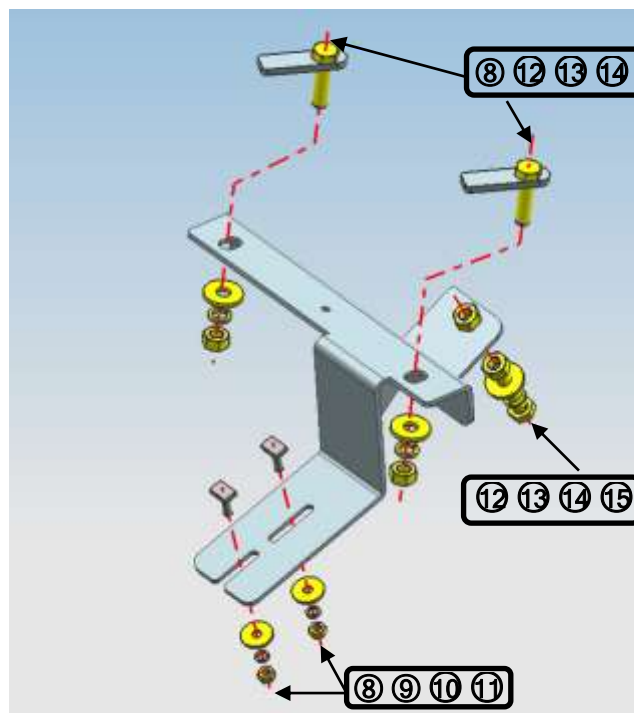

## PROCEDURE

1. REMOVE CONTENTS FROM BOX. VERIFY ALL PARTS ARE PRESENT. READ INSTRUCTIONS CAREFULLY BEFORE STARTING INSTALLATION.
2. Before installation, the skirt plastic shall be removed, and the skirt plastic shall be trimmed as the Fig1 shows to ensure that there is room for normal installation of the brackets.
3. Place the (2)T Blot M10\_40 (Fig2) on the position of (Fig2A) shows in advance. Use (1)Flat Washer D10\_27\_3, (1)Spring Washer D10 and (1)Hex Nut M10 to fix Front Bracket (L) (Fig2B).
4. Next, prepare (1) Support Plate, (1) 10mm Hex Nut, (1) 10mm x 50mm Hex Bolt, (1) 10mm Flat Washer and (1)10mm Spring Washer. Thread the 10mm Hex Nut all the way down the long Hex Bolt. Screw the Hex Bolt and Nut a few threads into and through the Nut welded onto the back tab on the Front Bracket. Insert the Support Plate with the welded socket facing down, into the space between the Front Bracket and the floor panel behind the pinch weld, (**Figures 2B、3&3A**). Tighten the Hex Bolt into the socket on the Support Plate until the Plate is close to but not touching the floor panel. Do not tighten hardware at this time.
5. Under the condition that the installation hole location is consistent as shown in Fig. 2A, the installation method of Rear Bravket (L) is consistent with Step3&4 (Figures 4、5&5A).

6. The installation steps of the front and rear bracket of the right side are the same as those on the left side.

After confirming the position of the running board, lock all the standard parts and reinstall the skirt plastic.

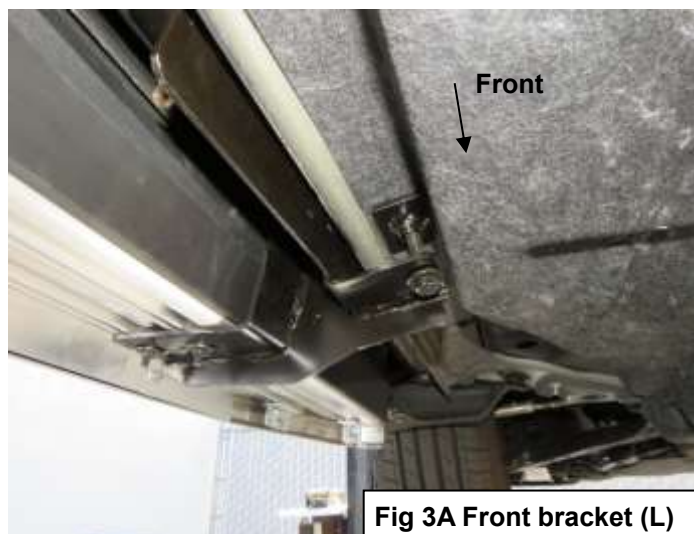
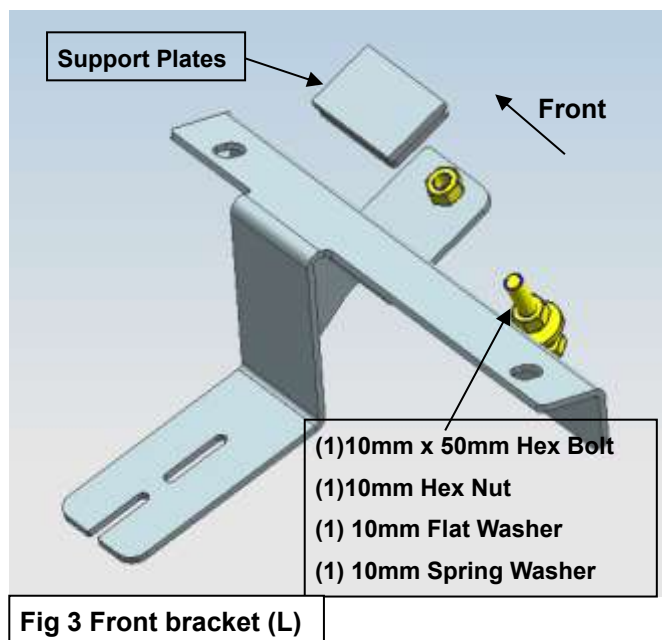
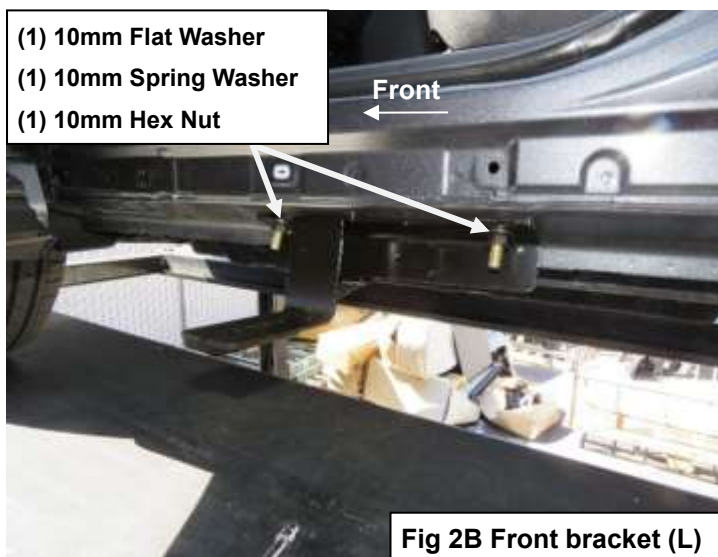
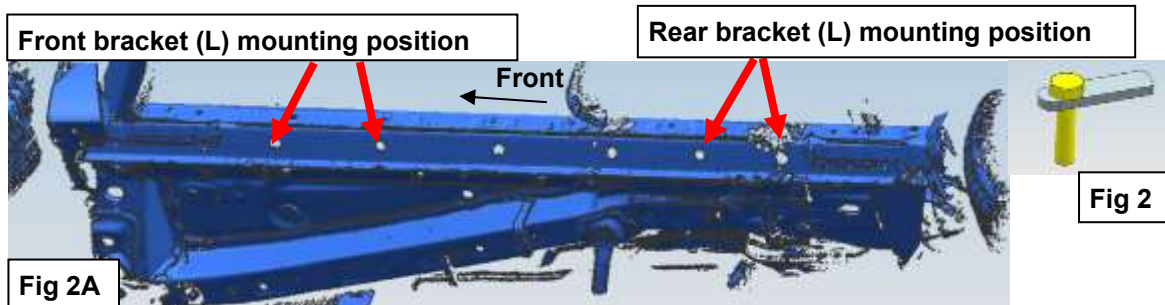

- (2) 10mm Flat Washer
- (2) 10mm Spring Washer
- (2) 10mm Hex Nut

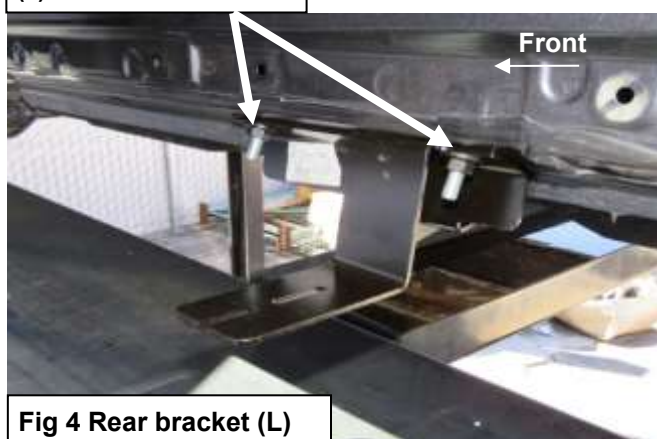
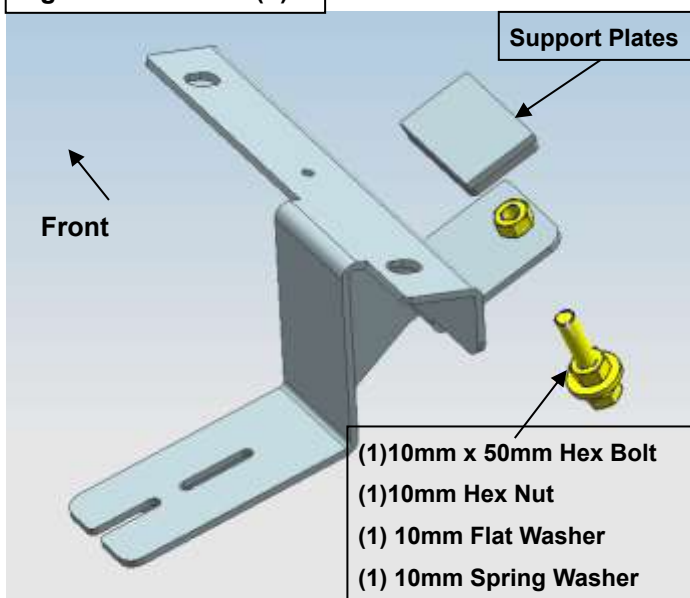

Fig 4 Rear bracket (L)



Fig 5A Rear bracket (L)

Fig 5 Rear bracket (L)



## NOTE

Any damages and losses caused by improper installation and application, goes beyond our quality warranty.