



## INSTALLATION INSTRUCTION

APPLICATION □ 1998-01 CHEVROLET S-10/BLAZER

1998-01 GMC SONOMA/JIMMY/

1998-01 OLDSMOBILE BRAVADA/ 1998-01 ISUZU HOMBRE

TEL:1-866-XANATOS

### MOUNT KIT

#### B17

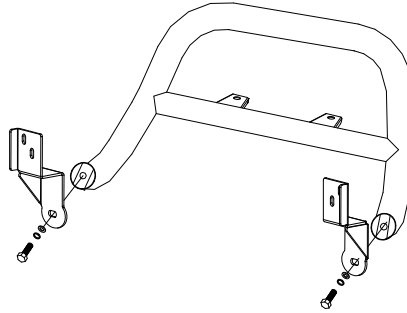

QTY	PARTS KIT CONTENTS DESCRIPTION	TOOLS REQUIRED
1	SAFARI BAR ASSEMBLY (PURCHASED SEPARATELY)	3/4" SOCKET
1	MOUNT BRACKET, PASSENGER	15MM SOCKET
1	MOUNT BRACKET, DRIVER	17MM SOCKET
2	M12×50 HEX HEAD BOLT	RATCHET
4	M10×30 HEX HEAD BOLT	TORQUE WRENCH
2	Φ12 SAE FLAT WASHER	
4	Φ10 FLAT WASHER	
2	Φ12 SPLIT LOCK WASHER	
4	Φ10 SPLIT LOCK WASHER	

- STEP1. Remove the contents from the box and check for any damage. Verify all parts against parts list.
- STEP2. Read and understand instructions completely before beginning installation.
- STEP3. Remove (2) 10MM bumper brace bolts located on back side of front body mount. (Body mount is located on outside of frame just behind the bumper). See Figure 1. NOTE: Bumper brace bolts may not be included on all models of vehicles. In this case, proceed to Step 4.
- STEP4. Place Mount brackets up to back side of body mount and secure using existing 10MM bolts previously removed. NOTE: On trucks without existing bolts, use the 10MM fasteners provided. See Figure 1. Hand tighten. See Figure 2 for bracket orientation.
- STEP5. Mount Safari Bar using M12 fasteners. Hand tighten. See Figure 1.

STEP 6. Center and level Safari Bar. Tighten and torque fasteners as follows:  
M12 fasteners to 65 FT. LBS.

M10 fasteners  
to 30 FT. LBS.

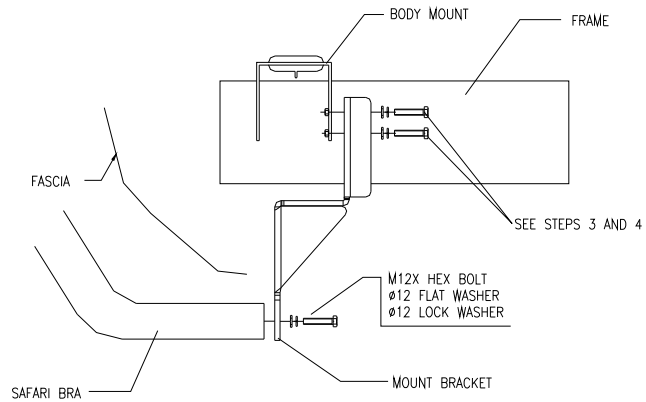

FIGURE 1  
DRIVER SIDE

FIGURE 2  
FRONT VIEW

