



TEL: 1-866-XANATOS

INSTALLATION INSTRUCTIONS

PART#: B401

A BAR BRACKET FOR HYUNDAI SANTAFE 01-06

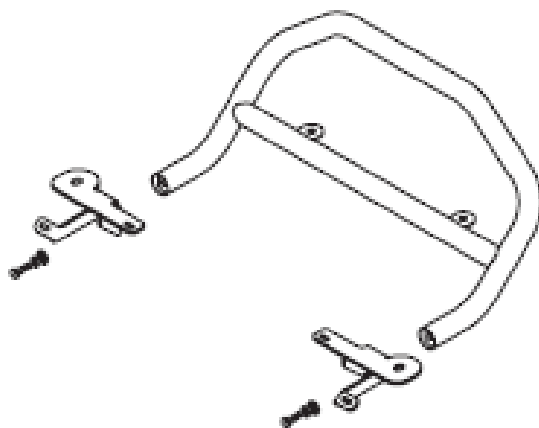

Part list:

No.	Name	Qty	Remarks	No.	Name	Qty	Remarks
①	Hex bolt	2	M14×80	⑧	Flat washer	4	8mm
②	Hex bolt	2	M12×50	⑨	Spring washer	4	8 mm
③	Hex bolt	4	M8×30	⑩	passenger side bracket	1	
④	Flat washer	4	14mm	⑪	Driver side bracket	1	
⑤	Spring washer	2	14mm	⑫	passenger side support bracket	1	
⑥	Flat washer	2	12mm	⑬	Driver side support bracket	1	
⑦	Spring washer	2	12mm	⑭	Flat washer	4	32mm

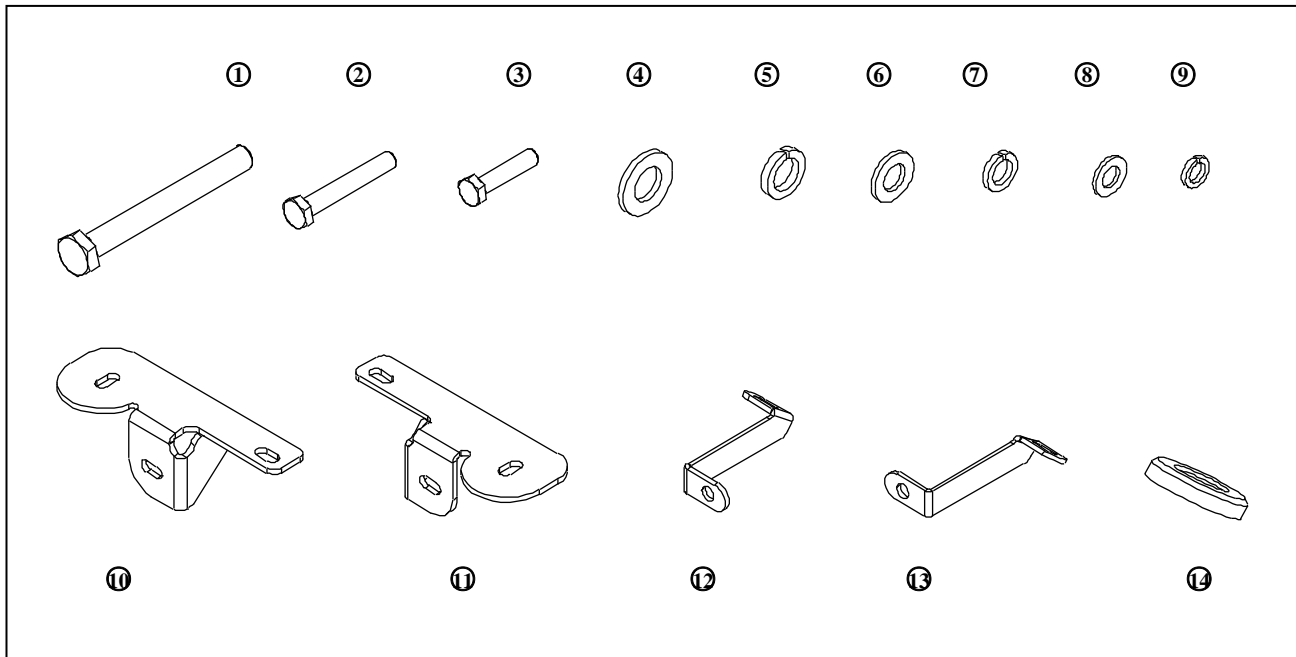

Note : Please read this information before installation.

Step one. Determine passenger and driver brackets.

Step two. Install brackets one side at a time. **CAUTION;** Wheels must be supported to support sub-frame to unibody to avoid misalignment for re-attachment. Remove (1) 14mm body mount bolt and (2) 8mm splash guard bolts (see figure #1).

NOTE: On 2 wheel drive models, no splash guard or 8mm bolts are present(see figure #1).

Step three. Insert 32mm flat washers and 14mm flat washers between bracket and body mount as shown(see figure #1).

Step four. Attach bracket and brace using 8mm and 14mm fasteners as shown. Hand tighten and repeat installation for opposite side(see figure #1).

Step five. Attach grille guard to brackets using 12 fasteners. Hand tighten(see figure #1).

Step six. Center and level grille guard. Completely tighten all hardware(see figure #1).

See figure #1

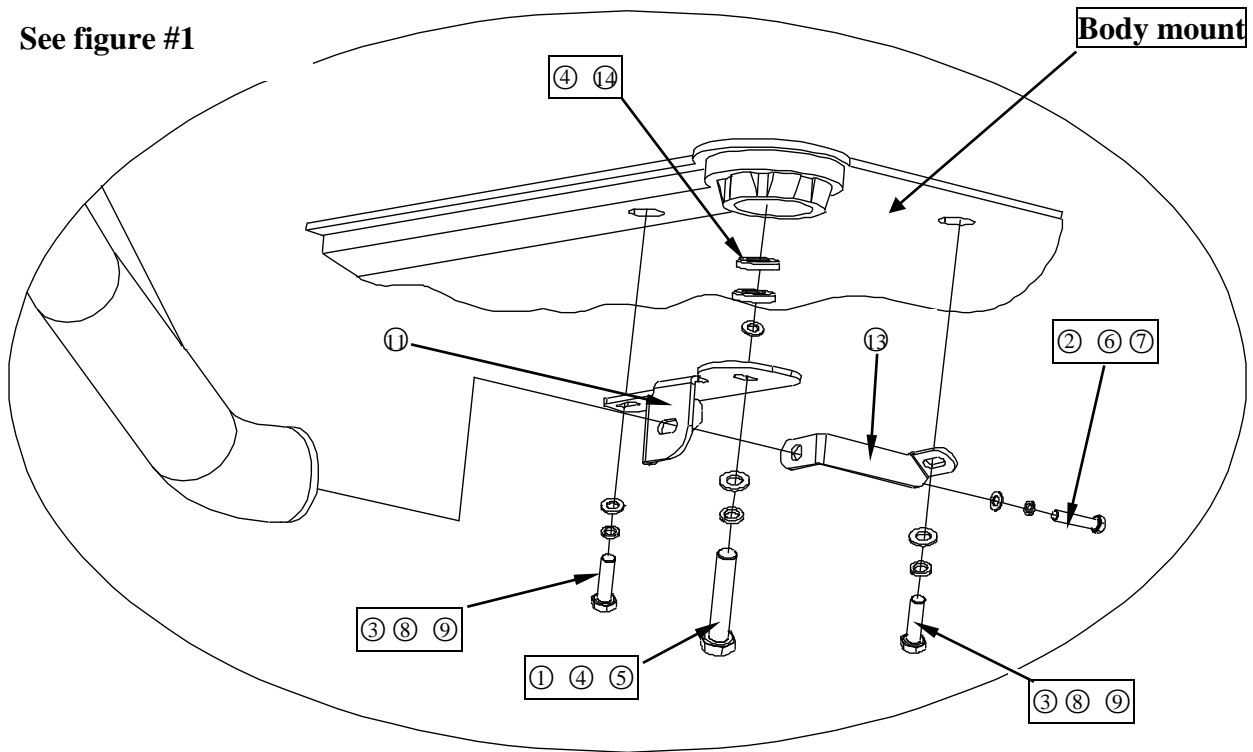

Installation view of driver side, passenger side opposite