

INSTALLATION INSTRUCTION

Front Runner SS

21 Nissan Rogue

PART # 15NIROS21



Attention:

- Please read this installation menu before installing this part. Protect your car properly in case there is any scratch might happen.
- You may need to periodically to re-tighten all hardware for safety use after installation.
- Installation pictures are only for your reference, there might be some differences between pictures and real parts but no affection for your installation.

PART LIST

NO.	NAME	QTY	REMARK	NO.	NAME	QTY	REMARK
1	Bumper (left)	1		11	T-bolt	2	M8
2	Bumper (right)	1		12	Plastic clampφ8	2	
3	Upper cross pipe	1		13	Large washer	2	Φ8x25x2.0
4	Lower cross pipe	1		14	Spring washer	2	Φ8
5	Bracket (left)	1		15	Hex nut	2	M8
6	Bracket (right)	1		16	Hexagonal head bolt	4	M12x35
7	Hexagon socket flat head bolt	8	M6x20	17	Large washer	8	Φ12x30x3.0h
8	Flat washer	16	Φ6x12x1.5	18	Spring washer	4	Φ12
9	Spring washer	8	Φ6	19	Hex nut	4	M12
10	Hex nut	8	M6	20	Hex key	1	

Note: The installation method is the same for both the left and right sides.

INSTALLATION PICTURES

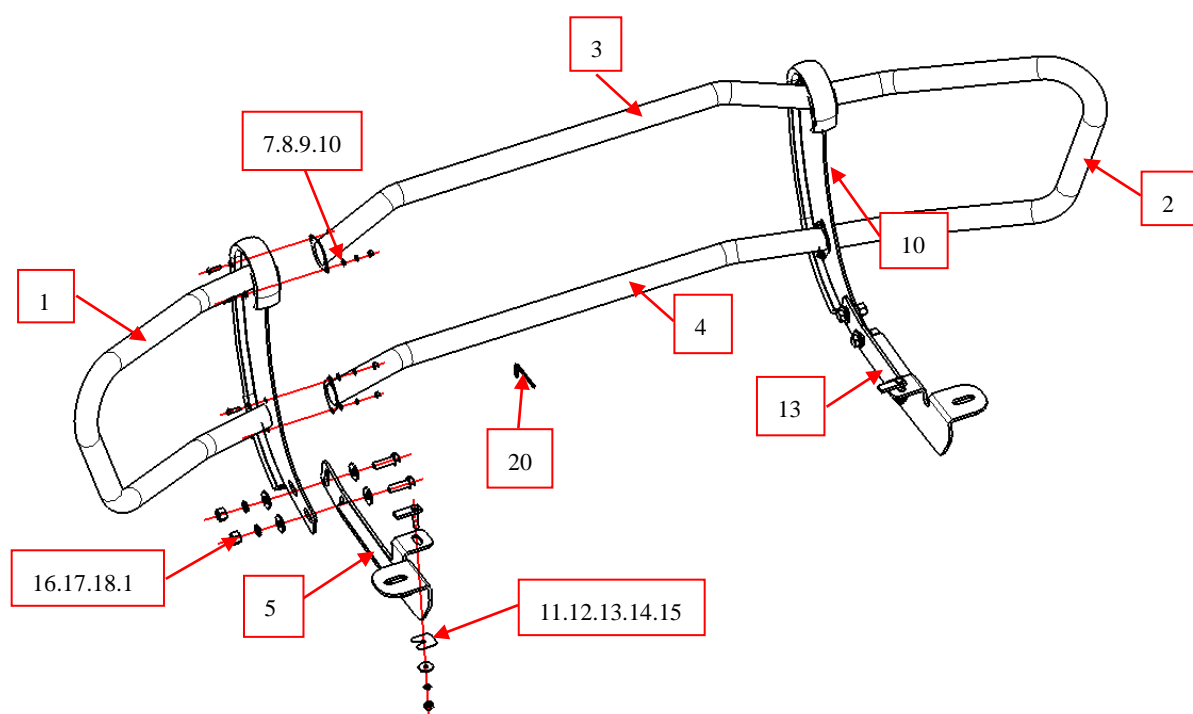

Step 1: Refer to the parts list to check if all the components are complete.

Step 2: Firstly, according to the license plate code, place it on the installation diagram, distinguishing between the left and right sides. Then, place it together with the fasteners in their respective positions to improve your installation speed.

Step 3: Refer to the diagram and use standard components to screw on the license plate, but do not tighten the screws initially. (The installation method for the left and right license plates is the same.)

Step 4: Check if all screws are in place, adjust the plate to the optimal position, and then tighten all the screws that have not been tightened.



Disclaimer: Caused due to improper installation initiates some related problem and losses, are beyond our company's quality assurance.