

INSTALLATION INSTRUCTION

BULL BAR
99-04 Jeep Grand Cherokee/
99-04 Jeep Laredo

Part # MAB-JEB4001S



BLACK HORSE
OFF ROAD

Installation Instructions

APPLICATION: 99-04 JEEP GRAND CHEROKEE

MOUNT KIT

B40

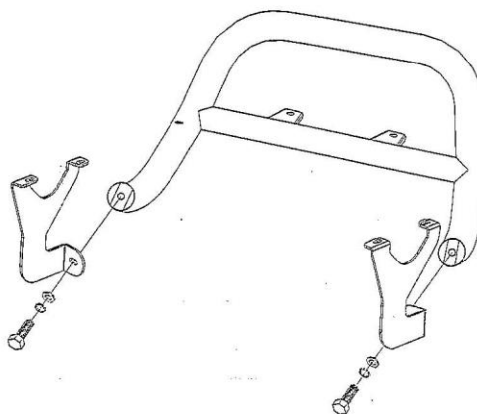

QTY	PARTS KIT CONTENTS DESCRIPTION	TOOLS REQUIRED
1	SAFARI BAR ASSEMBLY (PURCHASED SEPARATELY)	19MM SOCKET
1	MOUNT BRACKET-DRIVER SIDE	17MM SOCKET
1	MOUNT BRACKET-PASSENGER SIDE	RATCHET
2	M12×50 HEX BOLT	TORQUE WRENCH
2	Φ 12 FLAT WASHER	SOCKET EXTENSION
2	M12 LOCK WASHER	FLAT SCREWDRIVER
4	M10×30 HEX BOLT	
4	Φ 10 FLAT WASHER	
4	M10 NYLOCK NUT	

- STEP1. Remove the contents from the box and check for any damage. Verify all parts against the parts list.
- STEP2. Read and understand instructions completely before beginning installation.
- STEP3. Determine driver and Passenger Mount Brackets from figure above.
- STEP4. Remove plastic sway-bar shroud from underneath vehicle with flat screwdriver. Shroud is held in with four (4) plastic "push-in" style pins that secure it to the bottom part of the frame. Note: Reinstallation of shroud is optional.
- STEP5. Install driver side Mount Bracket using M10×30mm bolts, Φ 10 Flat Washers and M10 Nylock nuts. Leave loose. Repeat for the passenger side.
- STEP6. Attach Safari Bar to Mount Brackets using the 1/2" hardware. Leave loose. SA
- STEP7. Center and level the Safari Bar. Tighten and torque fasteners to:
- | | |
|---------------|-----------|
| M10 Bolts | 35Ft.Lbs. |
| M12 fasteners | 65Ft.Lbs. |