



**BLACK HORSE
OFF ROAD®**

TEL: 1-866-XANATOS

INSTALLATION INSTRUCTIONS

**MODULAR RUGGED GRILLE GUARD
2023-2024 FORD F250/350/450/550 SUPER DUTY
PART# RU-FOF218-B**

PARTS LIST:

1	Grille Guard Main Body	1	Allen Wrench S=6
2	Upright	16	12mm x 32mm x 3mm Flat Washer
1	Driver/Left Side Brush Guard	8	12mm Lock Washer
1	Passenger/Right Side Brush Guard	8	12mm Hex Nut
1	Bottom Tube	8	12mm-1.75 x 35mm Hex Bolt
1	Driver/Left Frame Mounting Bracket	28	10mm x 24mm x 2.2mm Flat Washer
1	Passenger/Right Frame Mounting Bracket	14	10mm Nylon Lock Nut
1	Driver/Left Upper Mounting Bracket	8	10-1.5mm x 40mm Button Head Bolt
1	Passenger/Right Upper Mounting Bracket	6	10-1.5mm x 35mm Button Head Bolt
2	LED Lamp Bracket	6	8mm x 24mm x 2mm Flat Washer
2	PVC Plastic Retainers $\phi 12(50.7*40*40)$	4	8-1.25mm x 25mm Button Head Bolt
1	Allen Wrench S=4	2	8mm Lock Washer
1	Allen Wrench S=5	2	8mm Nylon Lock Nut

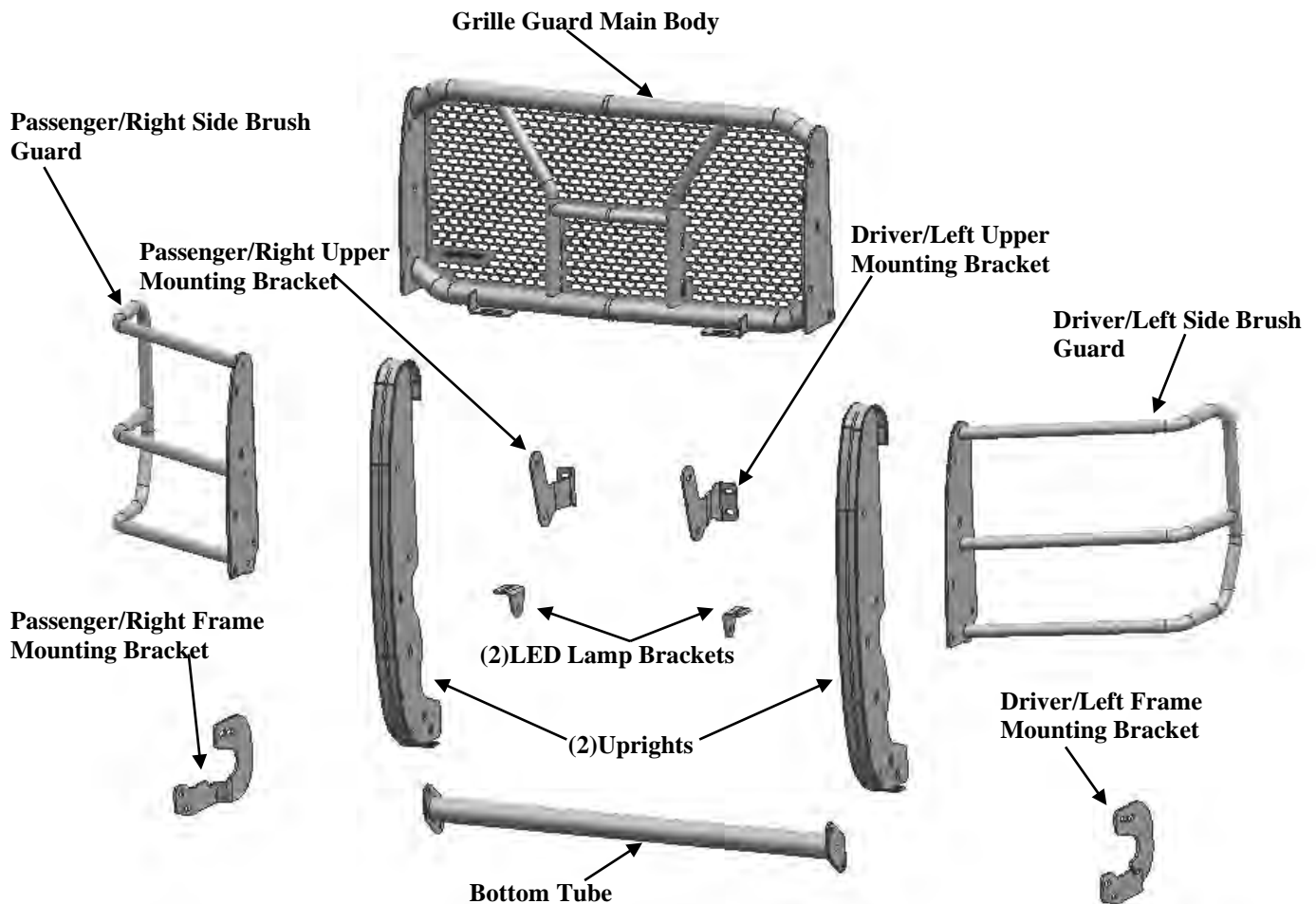

PROCEDURE:

REMOVE CONTENTS FROM BOX. VERIFY ALL PARTS ARE PRESENT. READ INSTRUCTIONS CAREFULLY BEFORE STARTING INSTALLATION. ASSISTANCE IS RECOMMENDED TO AVOID POSSIBLE INJURY OR DAMAGE TO THE VEHICLE. MINOR PLASTIC TRIMMING IS REQUIRED.

1. Starting at the front-driver side of the front bumper, remove the plastic cover, (if equipped), covering the bumper bolts on both sides of the tow hook, **(Figures 1 & 2)**. Cover re-installation recommended on models with driver/left side adaptive cruise control sensor attached to bumper.
2. Remove the (2) outer bumper bolts, **(Figure 2)**. **IMPORTANT:** Do not remove the inner bumper bolts or the bumper may fall. Only remove the outer bumper bolts.
3. Select the driver/left side Upper Bracket. **NOTE:** Models with plastic covers removed in **Step 1**, cut openings in outer pocket on covers to clear Brackets, **(Figure 1 & 3)**. Slide covers over Brackets but leave covers loose until after final adjustment, **(see Step 14)**.
Reuse the factory bolts to attach the Bracket and plastic cover to the bumper, **(Figure 4)**.
4. Make sure there is clearance between the top and bottom of the Upper Bracket and the opening in the bumper. Do not tighten hardware at this time.
5. Repeat **Steps 1—4** for passenger/right side Upper Bracket installation.
6. Next, remove the plastic air dam from the bottom of the bumper and place it on a clean, stable work surface, **(Figure 5)**. Note the location and type of all factory hardware for reinstallation.
7. From under the driver/left side of the bumper, locate the (2) outer hex nuts attaching the car catcher frame extension to the outside of the frame, **(Figure 6)**. Remove (1) of the (2) factory hex nuts, **(Figures 7 & 8)**. Thread (1) Plastic Retainer onto the threaded end of the double bolt plate. Remove the second factory nut from the bolt plate. **NOTE:** The Plastic Retainer is designed to help hold the factory double bolt plate in place in the frame and to help with bracket installation. Do not allow the double bolt plate to fall into the frame channel.
8. Select the driver side Frame Mounting Bracket. Reuse the (2) factory hex nuts to attach the Bracket to the double bolt plate, **(Figure 8 & 9)**. Do not tighten hardware at this time.
9. Repeat **Steps 7 & 8** for passenger/right side Frame Mounting Bracket installation.
10. With assistance, position the Upright up to the outside of the driver/left side Upper Bracket. Attach the Upright to the Brackets with the included (2) 12mm-1.75 x 35mm Hex Bolts, (4) 12mm x 32mm x 3mm Flat Washers, (2) 12mm Lock Washers and (2) 12mm Hex Nuts, **(Figure 10)**. Do not tighten hardware. Repeat this Step for passenger/right side Upper Bracket.
11. Attach the driver side Frame Mounting Bracket to the inside of the Upright with the included (2) 12mm-1.75 x 35mm Hex Bolts, (4) 12mm x 32mm x 3mm Flat Washers, (2) 12mm Lock Washers and (2) 12mm Hex Nuts **(Figures 11)**. Do not tighten hardware at this time. Repeat Step 11 to attach the passenger/right side Frame Mounting Bracket.
12. Attach the Bottom Tube to the inside of the Upright with the included (2) 10-1.5mm x 35mm Button Head Bolts, (4) 10mm x 24mm x 2.2mm Flat Washers and (2) 10mm Nylon Lock Nuts, **(Figures 12)**. Do not tighten hardware at this time. Repeat this Step to install the remaining upright.
13. Select the Driver/Left Brush Guard and Upright, **(Figure 13)**. Attach the Driver/Left Brush Guard and Upright to the outside of the Grille Guard Main Body with the included (4) 10-1.5mm x 40mm Button Head Bolts, (1) 10-1.5mm x 35mm Button Head Bolt, (10) 10mm x 24mm x 2.2mm Flat Washers and (5) 10mm Nylon Lock Nuts. Fully tighten hardware. Repeat this Step to attach the Passenger/Right Brush Guard.
14. Level and adjust the Grille Guard and fully tighten the Bracket-to-vehicle hardware only at this time. Temporarily remove the Grille Guard. Snap modified plastic covers in place, (also see **Step 3**).
15. Hold the plastic air dam up in position against the Frame Brackets and mark the location of the Brackets onto the top of the air dam, **(Figure 14)**. Measure the location of the Frame Brackets and transfer these measurements onto the back of the air dam, **(Figure 15)**. Place the air dam back up to the (2) Frame Mounting Brackets to verify location before cutting. Check all measurements on the vehicle. Once absolutely satisfied, use a hacksaw blade or utility knife to carefully cut (2) openings in air dam. Check fit, trim as necessary and reuse the factory hardware to reinstall air dam over Frame Brackets.
IMPORTANT: Do not cut through the top or bottom edge of the air dam, **(Figure 15)**. **NOTE:** It may be necessary to loosen or temporarily remove the Frame Mounting Brackets only to reinstall the air dam.

16. Reinstall the Frame Brackets through the air dam “if previously removed”.

17. Reinstall the Grille Guard as described in **Steps 10—14**. Level and adjust Grille Guard and fully tighten all hardware.

On models with grille emblem mounted camera, use included 4mm Allen Wrench to remove center window screen from back of Grille Guard, **(Figure 16)**.

18. LED Lamp Bracket installation (light sold separately).

- a. Select (1) LED Lamp Bracket, **(Figure 17)**. Attach the Bracket to the mounting tab on the Grille Guard Main Body with the included (1) 8-1.25mm x 25mm Button Head Bolt, (2) 8mm x 24mm x 2mm Flat Washers and (1) 8mm Nylon Lock Nut. Repeat this Step to install the remaining Bracket. Leave loose at this time.
- b. Use the hardware included with the light or the supplied (1) 8-1.25mm x 25mm Button Head Bolt, (1) 8mm x 24mm x 2mm Flat Washer and (1) 8mm Lock Washer to attach the LED light assembly to the LED Lamp Bracket, **(Figure 17)**. Do not fully tighten hardware at this time.
- c. Follow light manufacturer’s instructions to properly wire the light to the electrical system.
- d. Adjust light and fully tighten hardware.

19. Do periodic inspections to the installation to make sure that all hardware is secure and tight.

To protect your investment, Do not use any type of polish or wax that may contain abrasives that could damage the finish. Mild soap may be used to clean the Grille Gua

Driver/left Side Installation Pictured



(Fig 1) Remove cover over bumper bolts.



(Fig 2) Remove outer bumper bolts only

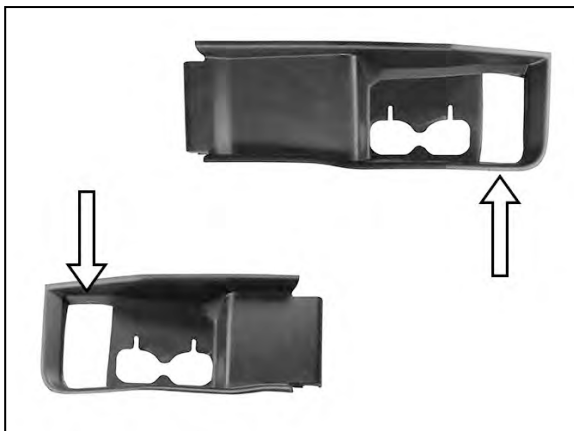

(Fig 3) Cut plastic covers to clear base on Brackets for reinstallation “if desired”



(Fig 4) Reuse factory bumper bolts to attach driver/left Upper Bracket to bumper

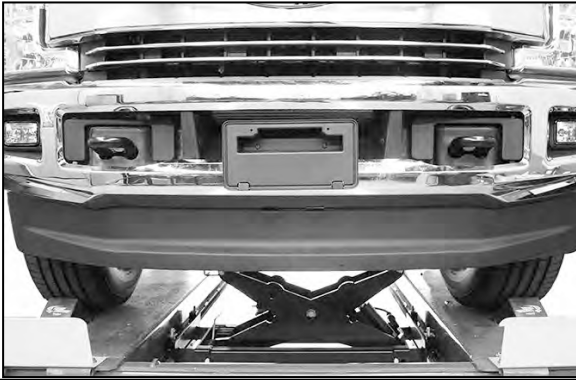

(Fig 5) Remove plastic air dam from bottom of bumper.

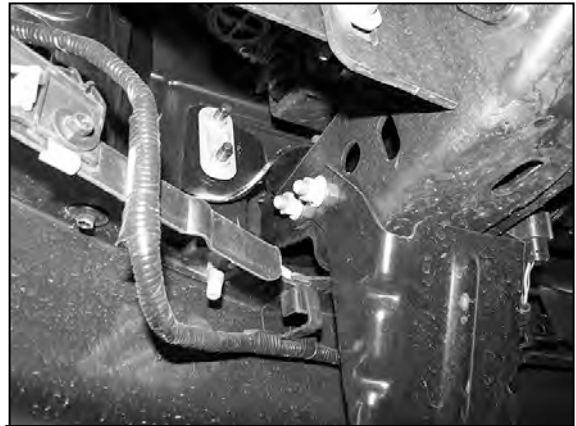

(Fig 6) Driver/left frame extension pictured



Remove (1) nut, thread (1)
12mm Plastic Retainer onto
threaded end before
removing remaining hex nut

(Fig 7) Driver/left frame extension pictured

Remove (1) nut, thread (1)
12mm Plastic Retainer onto
threaded end before
removing remaining hex nut

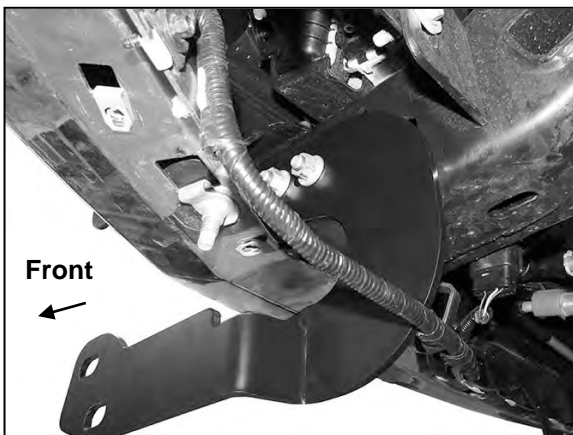

(Fig 9) Driver/left Frame Bracket pictured.
Reuse factory hardware to attach Bracket
to side of frame and frame extension

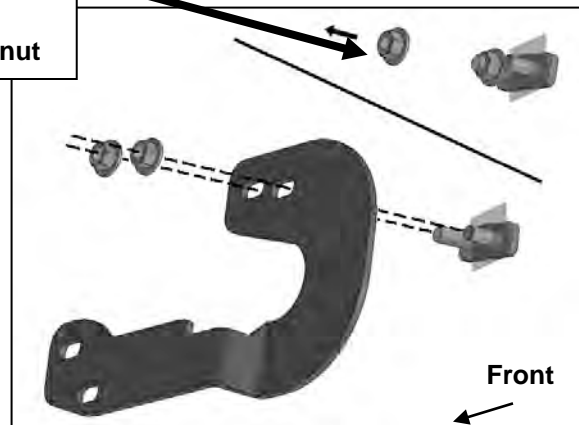

(Fig 8) Driver/left Frame Bracket
illustrated. Reuse factory hardware to
attach Bracket to side of frame and frame
extension.

- (2) 12mm-1.75 x 35mm Hex Bolts,
- (4) 12mm x 32mm x 3mm Flat Washers
- (2) 12mm Lock Washers
- (2) 12mm Hex Nuts

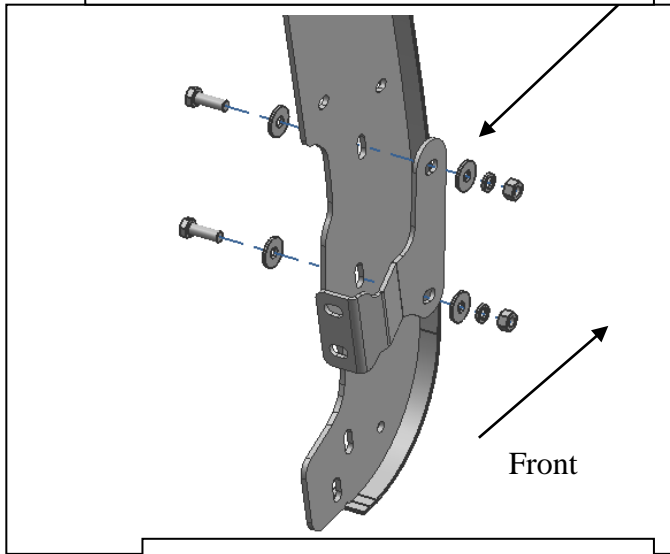

(Fig 10) Attach driver/left side Upper Bracket to Upright

- (2) 12mm-1.75 x 35mm Hex Bolts
- (4) 12mm x 32mm x 3mm Flat Washers
- (2) 12mm Lock Washers
- (2) 12mm Hex Nuts

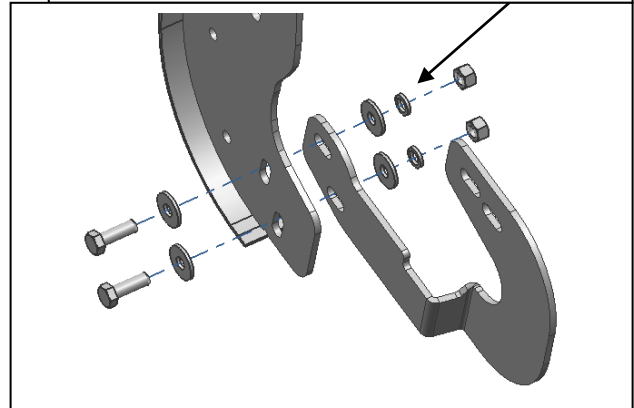

(Fig 11) Attach driver side Frame Mounting Bracket to Upright

- (2) 10-1.5mm x 35mm Button Head Bolts
- (4) 10mm x 24mm x 2.2mm Flat Washers
- (2) 10mm Nylon Lock Nuts

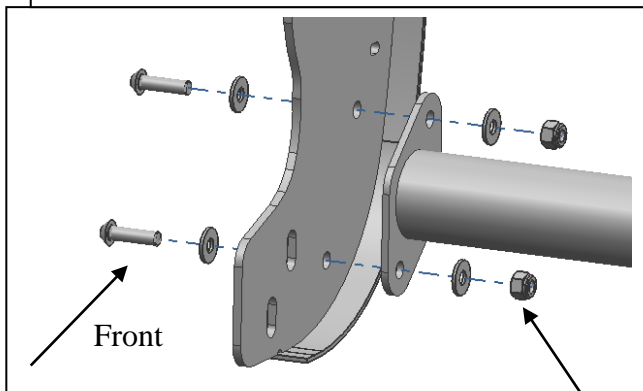

(Fig 12) Bottom Tube installed

- (4) 10-1.5mm x 40mm Button Head Bolts
- (1) 10-1.5mm x 35mm Button Head Bolt
- (10) 10mm x 24mm x 2.2mm Flat Washers
- (5) 10mm Nylon Lock Nuts

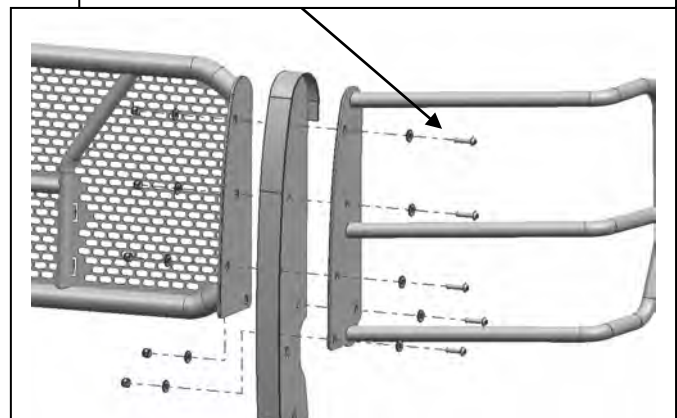

(Fig 13) Attach Upright to Grille Guard Main Body

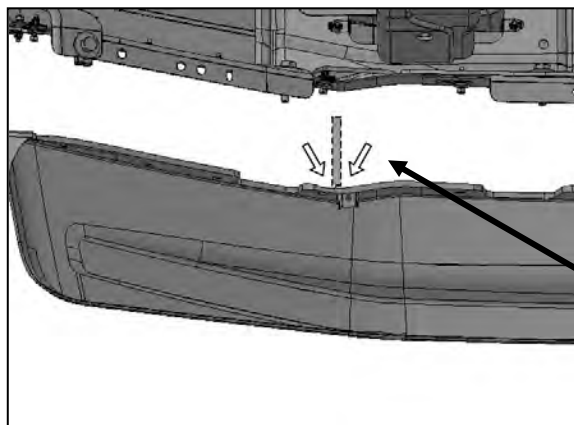

Hold air dam up against bottom of Brackets (dashed line for reference). Mark location of Bracket onto top of air dam (arrows)

(Fig 14) Driver side-back of air dam illustrated

Do not cut through the top or bottom edges of the air dam. Only remove enough material to clear the Brackets

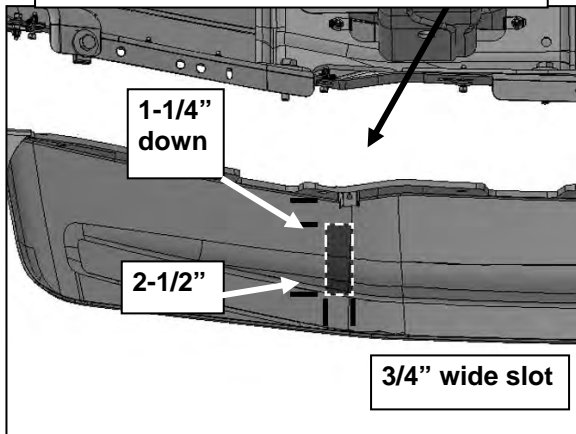

(Fig 15) Driver side-back of STD air dam illustrated. All measurements are for reference and example only, check all measurements before cutting air dam.

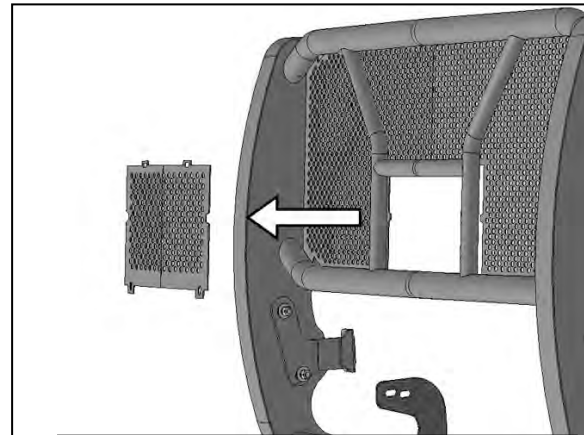

(Fig 16) On models with grille mounted camera, remove center window screen

- (1) 8-1.25mm x 25mm Button Head Bolt
- (1) 8mm x 24mm x 2mm Flat Washer
- (1) 8mm Lock Washer

- (1) 8-1.25mm x 25mm Button Head Bolt
- (2) 8mm x 24mm x 2mm Flat Washers
- (1) 8mm Nylon Lock Nut

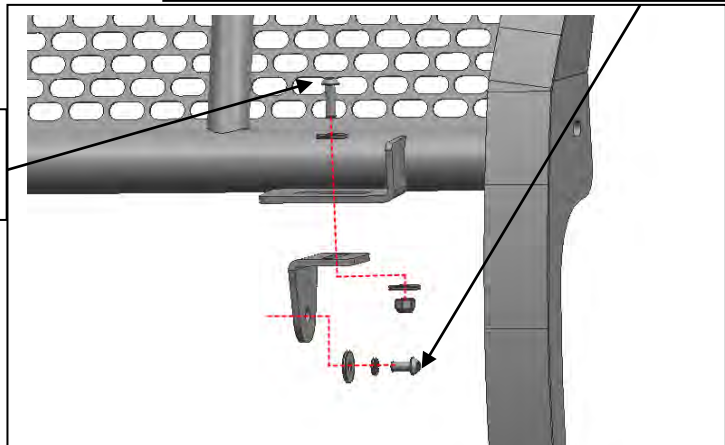

(Fig 17) Attach LED Lamp Bracket to Grille Guard Main Body

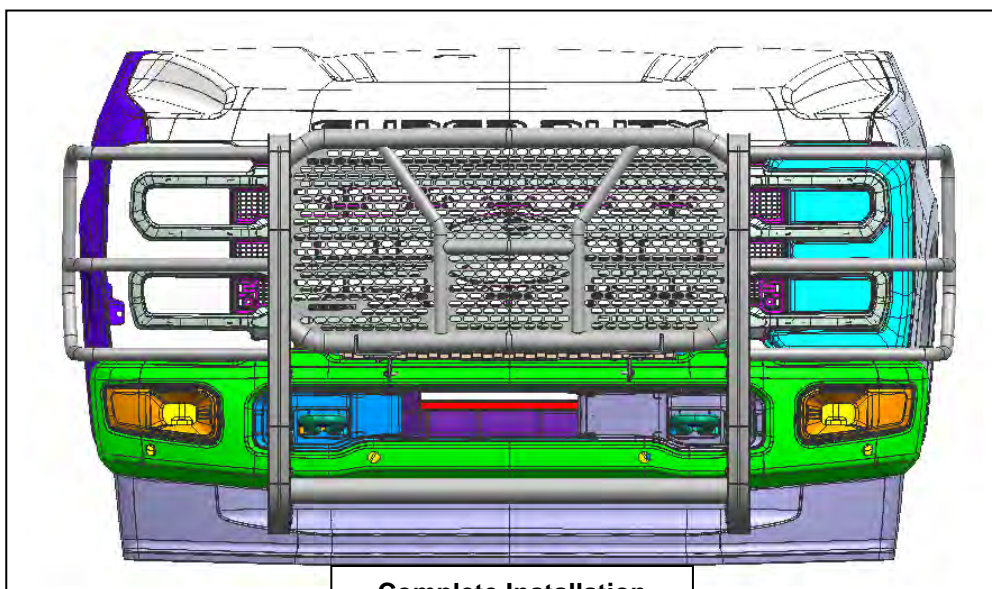

Complete Installation