



TEL : 1-866-XANATOS

INSTALLATION INSTRUCTIONS

**MODULAR RUGGED GRILLE GUARD
2022+ FORD MAVERICK
PART# RU-FOMA22-B**

INSTALLATION INSTRUCTIONS

PARTS LIST:

QTY	Item Description	QTY	Item Description
1	Grille Guard Main Body	6	8-1.25mm x 25mm Hex Bolt
1	Driver/Left Brush Guard	4	8-1.25mm x 25mm Button Head Bolt
1	Passenger/Right Brush Guard	18	8mm x 24mm x 2mm Flat Washer
1	Bottom Tube	8	8mm Nylon Lock Nut
2	Uprights	2	8mm Lock Washer
1	Driver/Left Mounting Bracket	10	10-1.5mm x 35mm Hex Bolt
1	Passenger/Right Mounting Bracket	4	10-1.5mm x 35mm Button Head Bolt
1	Driver/Left Lower Support Bracket	10	10-1.5mm x 40mm Button Head Bolt
1	Passenger/Right Lower Support Bracket	24	10mm Nylon Lock Nut
1	Driver/Left Top Inner Support Bracket	4	10mm x 20mm x 2mm Flat Washer
1	Passenger/Right Top Inner Support Bracket	44	10mm x 27mm x 3mm Flat Washer
1	Driver/Left Top Outer Support Bracket	4	12mm-1.75 x 40mm Hex Bolt
1	Passenger/Right Top Outer Support Bracket	8	12mm x 32mm x 3mm Flat Washer
2	LED Lamp Bracket	4	12mm Nylon Lock Nut
2	6-1.0mm x 25mm Hex Bolt	1	4mm Wrench
2	6mm x 22mm x 2mm Flat Washer	1	5mm Wrench
2	6mm Lock Washer	1	6mm Wrench

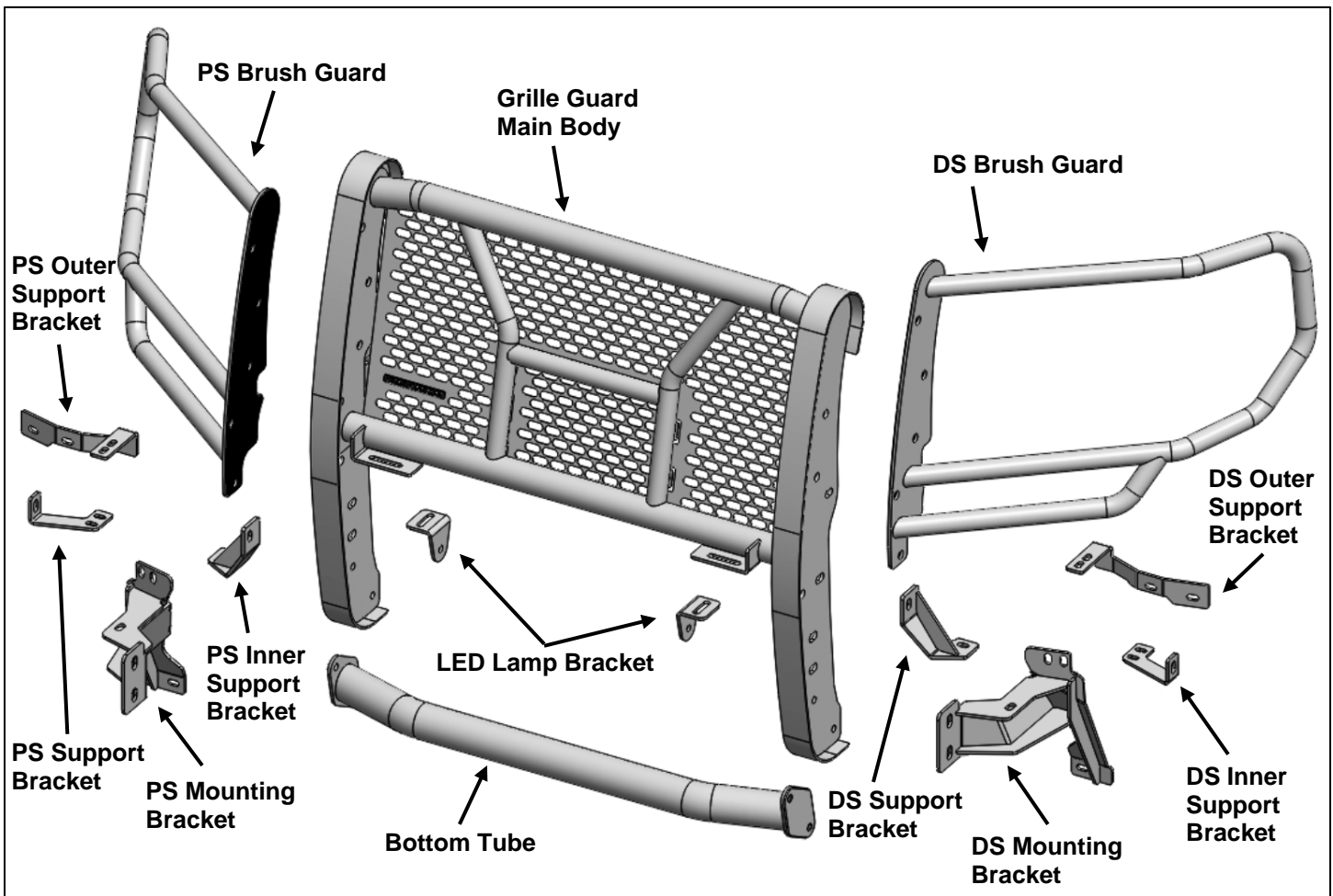



Hex Bolt

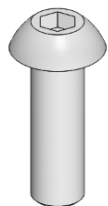

Button
Head Bolt



Lock
Washer



Flat
Washer



Nylon
Lock Nut



Hex Nut

TOOLS REQUIRED



Ratchet



Sockets



Extensions



Wrench

1

Follow (Fig 1 – 4) to remove Front Fascia and cut slots in bumper.

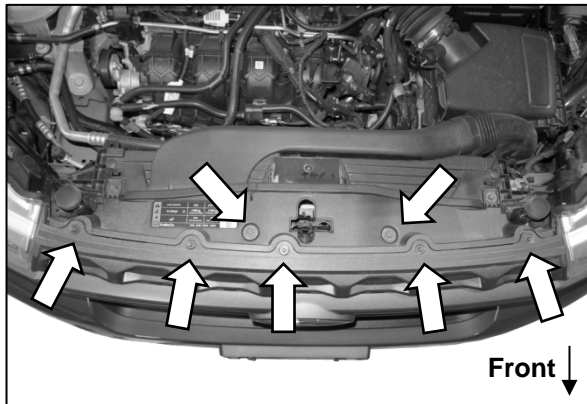

(Fig 1) Remove hardware holding Front Fascia

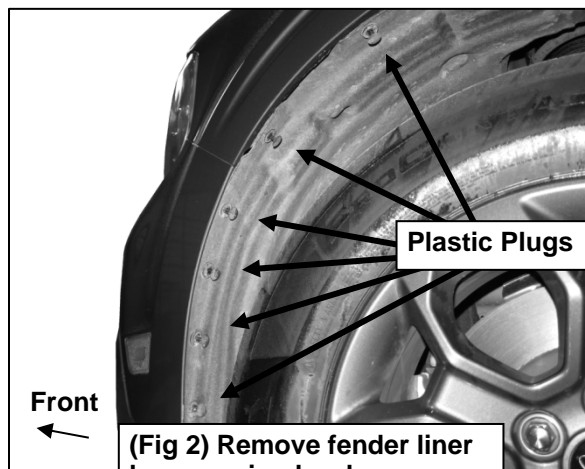

(Fig 2) Remove fender liner
by removing hardware

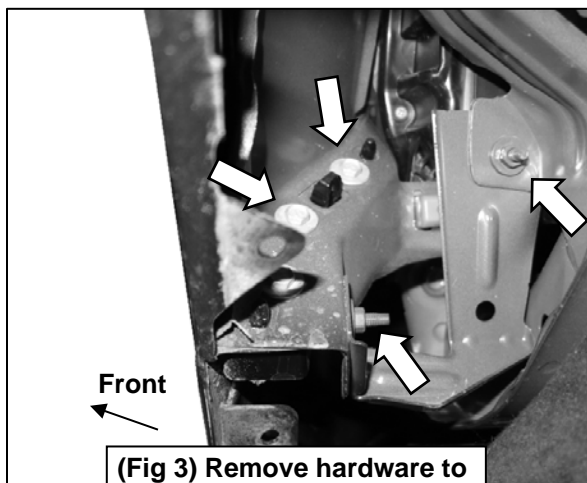

(Fig 3) Remove hardware to
remove Front Fascia

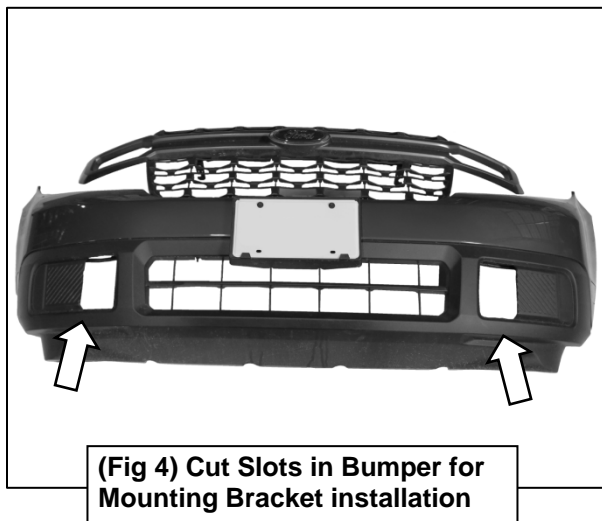

(Fig 4) Cut Slots in Bumper for
Mounting Bracket installation

Follow (Fig 5 – 14) to attach Mounting and Support Brackets to vehicle, then Reinstall Bumper and Front Fascia. Then attach Grille Guard to Brackets. Ensure hardware is hand tightened.

- (1) 10x35mm Hex Bolt
- (2) 10x20mm Flat Washer
- (1) 10mm Lock Nut

- (1) 10x35mm Hex Bolt
- (2) 10x27mm Flat Washer
- (1) 10mm Lock Nut

(Fig 5) Attach Mounting Bracket to vehicle

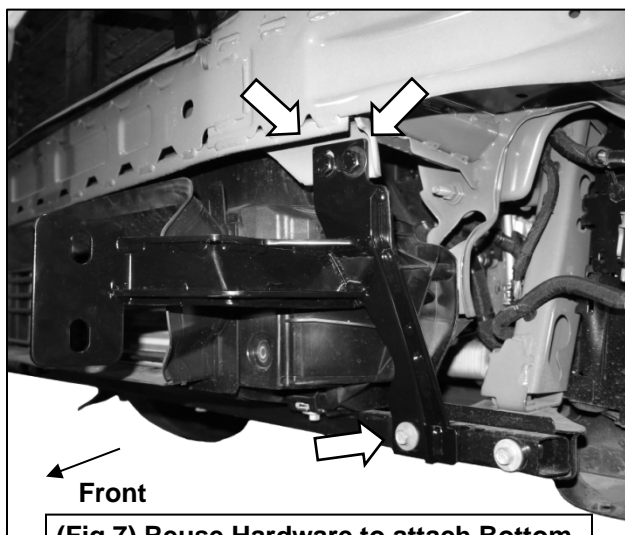

(Fig 7) Reuse Hardware to attach Bottom Mounting Slot for Mounting Bracket

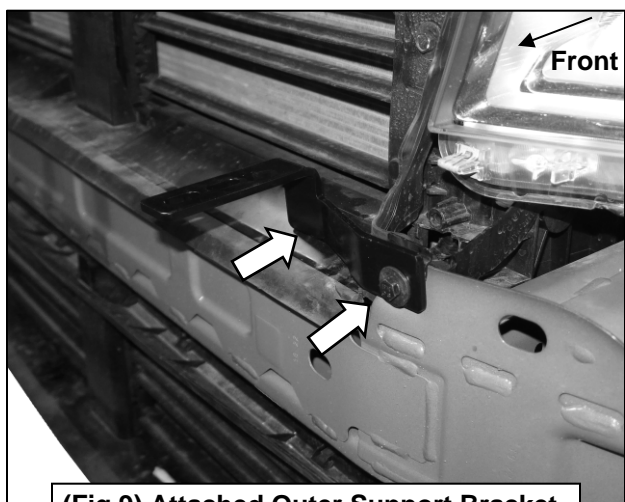

(Fig 9) Attached Outer Support Bracket

- (1) 10x35mm Hex Bolt
- (2) 10x27mm Flat Washer
- (1) 10mm Lock Nut

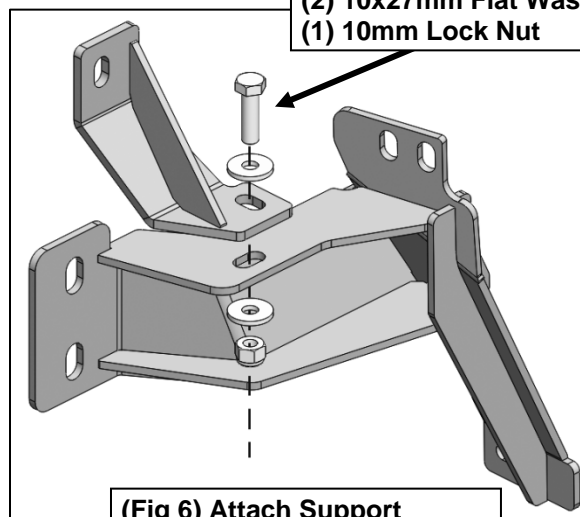

(Fig 6) Attach Support Bracket to Mounting Bracket

- (1) 6x25mm Hex Bolt
- (1) 6mm Lock Washer
- (1) 6x22mm Flat Washer

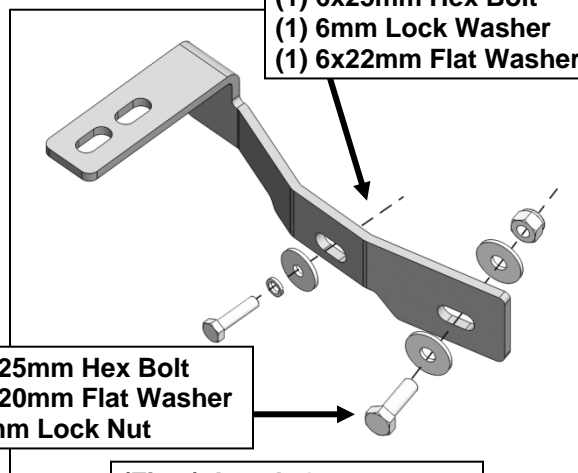

(Fig 8) Attach Outer Support Bracket to vehicle

Reinstall Bumper and Front Fascia after installation of Mounting and Support Brackets

- (1) 10x35mm Hex Bolt
- (2) 10x27mm Flat Washer
- (1) 10mm Lock Nut

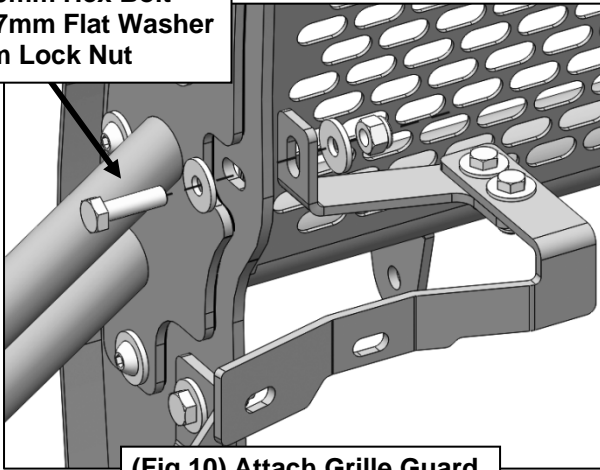

(Fig 10) Attach Grille Guard to Inner Support Bracket

- (2) 8x25mm Hex Bolt
- (4) 8x24mm Flat Washer
- (2) 8mm Lock Nut

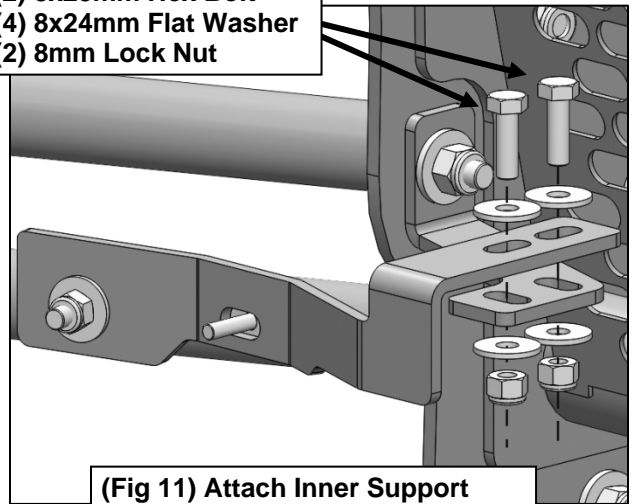

(Fig 11) Attach Inner Support Bracket to Outer Support Bracket

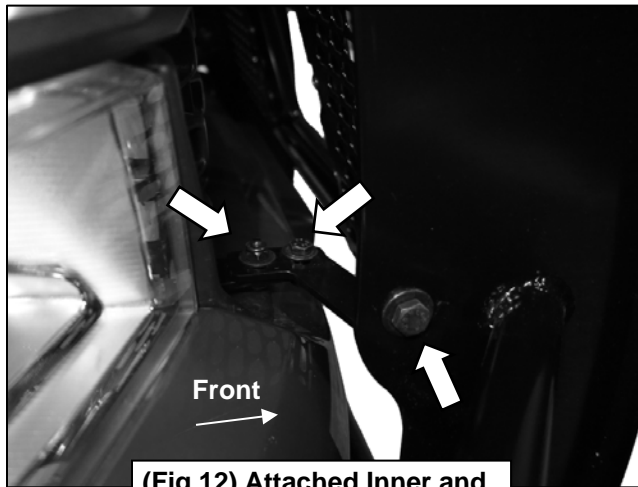

(Fig 12) Attached Inner and Outer Support Brackets

- (1) 10x35mm Hex Bolt
- (2) 10x27mm Flat Washer
- (1) 10mm Lock Nut

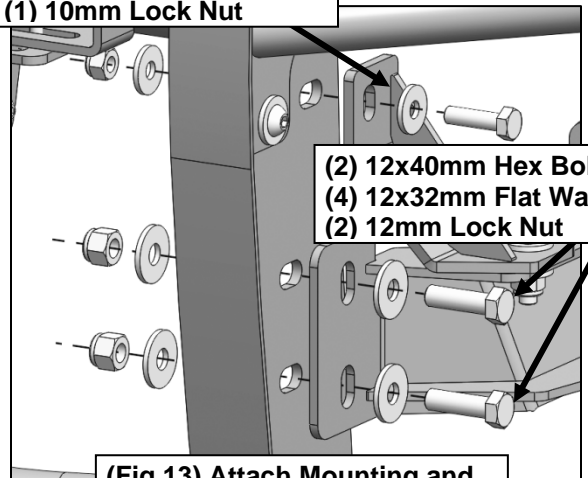

- (2) 12x40mm Hex Bolt
- (4) 12x32mm Flat Washer
- (2) 12mm Lock Nut

(Fig 13) Attach Mounting and Support Bracket to Main Body

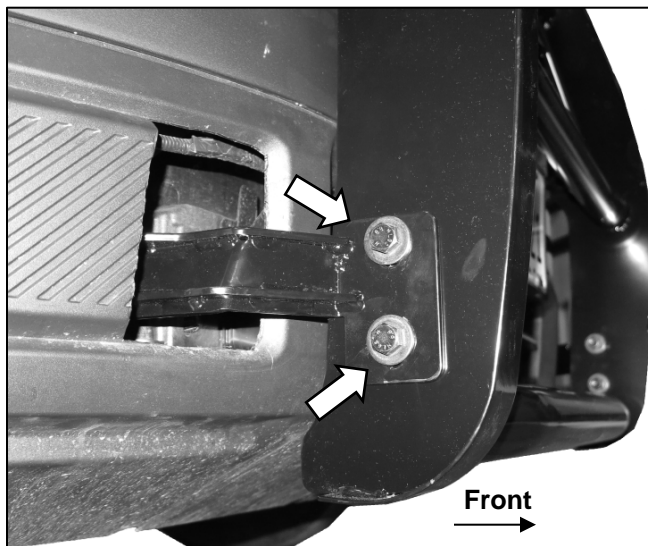

(Fig 14) Attached Mounting Bracket

Follow (Fig 15 – 18) to attach LED Bracket and LED Light if using, then attach Bottom Tube and Brush Guard. Ensure Grille Guard is level, then tighten all fasteners. Installation is complete. Do periodic inspections of the installation to make sure that all hardware is secure and tight.

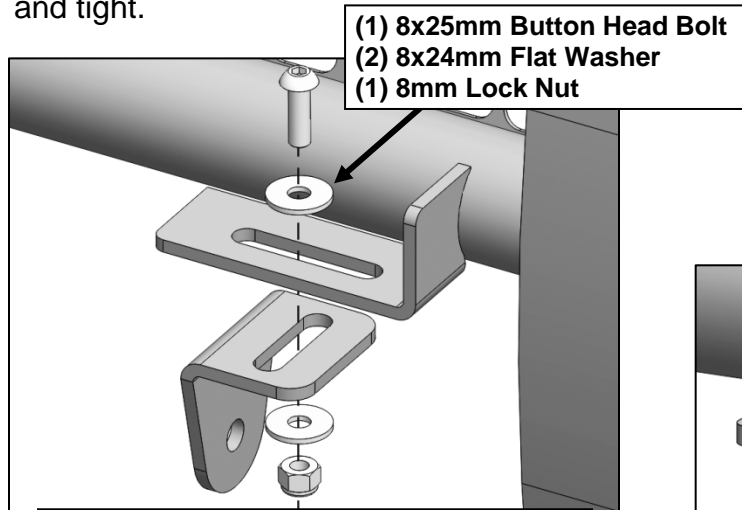

(Fig 15) If using LED Light (not included), attach LED Lamp Bracket

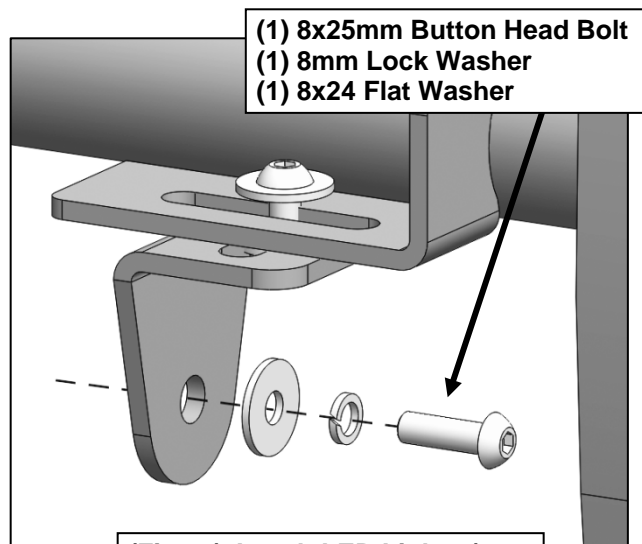

(Fig 16) Attach LED Lights (not included) to LED Lamp Bracket

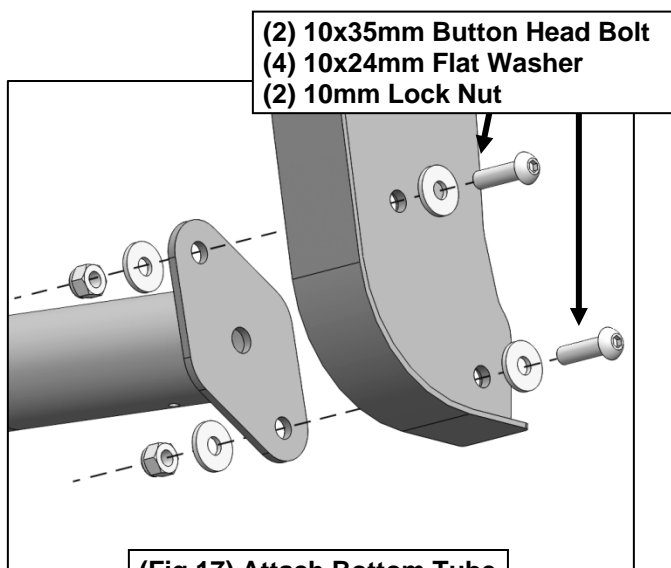

(Fig 17) Attach Bottom Tube to Grille Guard Main Body

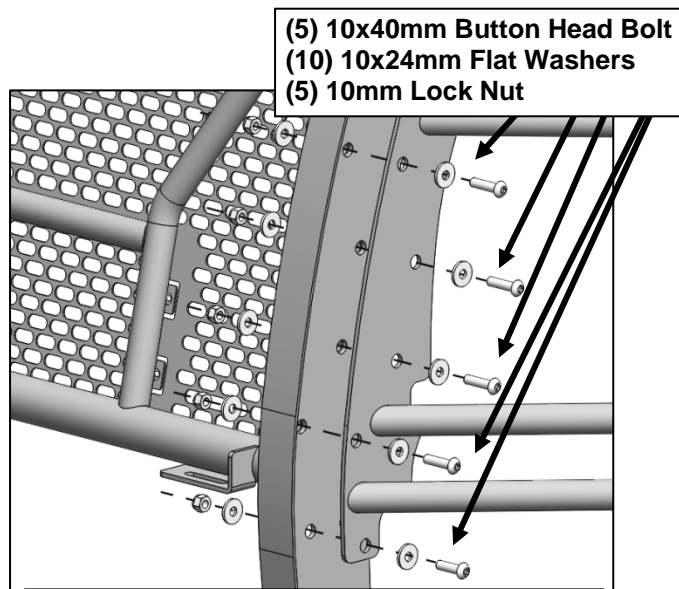

(Fig 18) Attach Brush Guards to Main Body

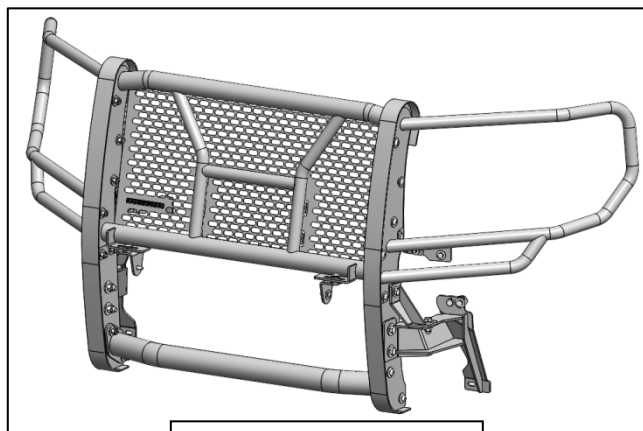

Completed Installation