



**BLACK HORSE  
OFF ROAD®**

**TEL: 1-866-XANATOS**

## **INSTALLATION INSTRUCTIONS**

**LD1 FRONT BUMPER**

**2016-24 NISSAN TITAN XD ONLY**

**PART#AFB-NITI**

**LD1 FRONT BUMPER  
2016-24 NISSAN TITAN XD ONLY**

**PARTS LIST:**

1	LD1 Front Bumper Assembly	2	8-1.25mm x 25mm Hex Bolts
1	Driver/left "L" Bracket (center LED light)	2	8-1.25mm x 16mm Hex Bolts (LED light bar)
1	Passenger/right "L" Bracket (center LED light)	6	8mm x 24mm Flat Washers
1	License Plate Bracket	4	8mm Lock Washers
2	Plastic Plugs for license plate mount	2	8mm Hex Nuts
4	Sensor Hole Plugs	2	6mm x 20mm Button Head Bolts
4	Sealing Washers	4	6mm x 18mm x 1.6mm Flat Washers
4	20mm x 10mm Foam Spacers	2	6mm Nylon Lock Nuts
4	Retaining Caps	8	4mm Self Tapping Screws
1	Sensor Covers Kit	1	4mm Allen Wrench
		10	Nylon Wire Ties

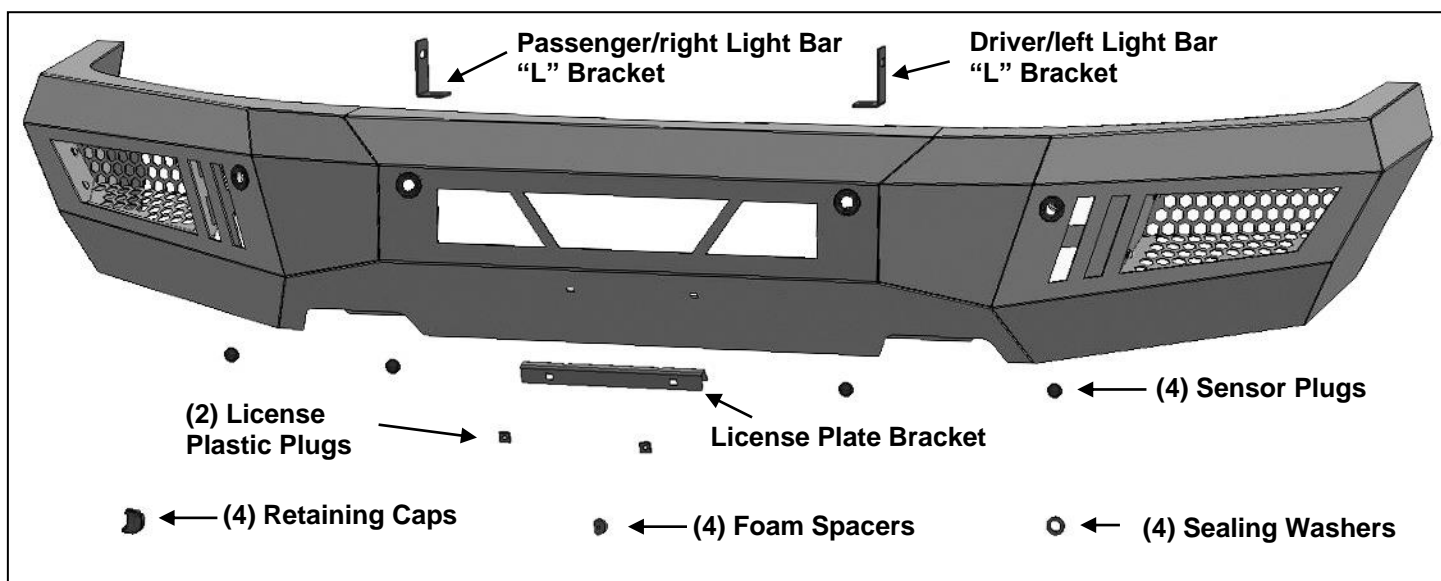

**PROCEDURE:**

**REMOVE CONTENTS FROM BOX. VERIFY ALL PARTS ARE PRESENT. READ INSTRUCTIONS CAREFULLY BEFORE STARTING INSTALLATION. BUMPER IS HEAVY, ASSISTANCE IS HIGHLY RECOMMENDED TO AVOID POSSIBLE INJURY OR DAMAGE TO THE VEHICLE.**

1. Remove the license plate. On models with factory fog lights and/or sensors, unplug the wiring harness leading to the bumper. Release the harness from clips attached to the back of the bumper and move harness out of the way.
2. Starting on the driver/left side, remove the plastic panel next to the opening in the bumper, **(Figure 1)**. On models with sensors, remove the panel and unplug the sensor, **(Figure 2)**. Next, remove the plastic fill panel directly above the tow hook, if equipped, **(Figure 3)**. Remove skid plate, if equipped. Skid plate cannot be reinstalled, **(Figure 4)**.
3. From under the front bumper, locate and remove the hex bolts (1 per side) attaching the lower bumper brackets to the crossmember on the frame, **(Figure 5)**. **NOTE:** Brackets are located behind bumper, below fog lights. Bolts are located on both ends of the crossmember next to body mount bolts.
4. Next, move to the driver/left inner wheel opening. Remove the hardware attaching the inner bumper reinforcement to the outside of the frame, **(Figure 6)**.
5. Repeat **Steps 2—4** on the passenger/right side of the vehicle.
6. Place blocks or jack stands under the front bumper to support it during mounting bolt removal. Once the bumper has been safely supported, remove the (3) hex bolts attaching each side of the bumper to the bracket on the end of the frame, **(Figures 2 & 7)**. **WARNING!** Assistance is required to hold the bumper in place during hardware removal to prevent the bumper from falling. Slide the bumper assembly off of the tow hooks, (if equipped).

**LD1 FRONT BUMPER  
2016-24 NISSAN TITAN XD ONLY**

7. Once the bumper assembly has been removed, remove both bumper brackets from the end of the frame, **(Figures 7 & 8)**.
8. Determine if the vehicle is equipped with front sensors. **NOTE:** Sensors must be installed before Bumper installation.

**Models without bumper sensors:**

- a. Select the included (4) Plastic Plugs.
- b. From the front, push the plugs into the sensor mounting holes, **(Figure 9)**.

**Models with bumper mounted sensors: IMPORTANT!** The factory bumper is equipped with two different shaped sensors.

- a. Disassemble the bumper to remove the wiring harness, **(Figure 10)**. Note location and type of all sensors for proper reinstallation in correct locations.
  - b. Remove the driver/left outer sensor. Remove the factory sealing washer from the end of the sensor, **(Figure 11)**. Push the included larger Foam Sealing Washer onto the end of the sensor, **(Figure 13)**. Push the sensor into the driver/left outer sensor mount on the back of the Bumper.
  - c. Attach the adhesive side of (1) Foam Spacer to inside of (1) Retaining Cap. Push the Retaining Cap onto the sensor mount to secure the sensor in place, **(Figure 13)**.
  - d. Repeat the previous Steps to install the remaining sensors across the Bumper. **NOTE:** Remove inner sensors from the plastic fill panels removed in **Step 2, (Figures 12 & 13)**.
  - e. Attach the wiring harness to the back of the Bumper and plug in all sensors. Use the included wire ties to securely attach the harness to the back of the Bumper.
9. **Center LED light installation** (sold separately).
- a. Select the L/R "L" Brackets, **(Figure 14)**. Attach the Brackets to the top of the (2) mounting tabs welded onto the back of the bumper with the included (2) 8mm x 25mm Hex Bolts, (4) 8mm Flat Washers, (2) 8mm Lock Washers and (2) 8mm Hex Nuts. Leave loose at this time.
  - b. Attach the LED light assembly to the "L" Brackets with the included (2) 8mm x 16mm Hex Bolts, (2) 8mm Lock Washers and (2) 8mm Flat Washers, **(Figure 14)**. Do not fully tighten hardware at this time. **IMPORTANT:** "L" Brackets are designed for 8mm light mounting hardware only. Modify "L" Brackets if necessary or use brackets supplied by the light manufacturer, if possible, to install hardware larger than 8mm.
  - c. Follow light manufacturer's instructions to properly wire the light.
- LED light installation at ends of bumper** (sold separately).
- a. Insert light into opening and up to mounting slots. Check for clearance between front and back of light. If necessary, remove screen from back of opening, **(Figure 15)**.
  - b. Follow the light manufacturer's instructions to attach (1) light to the center slot or (2) lights to the inner and outer slots in the top of the light opening, **(Figure 15)**. **IMPORTANT:** On two light systems, attach the flood light to the outer slot and the spot light to the inner slot.
  - c. Repeat the above steps for passenger side light installation.
  - d. Follow light manufacturer's instructions to properly wire the light.
10. With assistance, position the LD1 Bumper Assembly up to the frame brackets. Temporarily support the weight of the Bumper. **WARNING:** To avoid possible injury or damage to the vehicle, do not proceed until the Bumper is fully and safely supported.
11. Reuse the (3) factory bumper bolts to attach the mounting plate on the back of the driver/left side of the Bumper to the end of the frame, **(Figures 16 & 17)**. Do not fully tighten at this time. Repeat this Step to attach the passenger/right side of the Bumper to the end of the frame, **(Figure 18)**.
12. Level and adjust the bumper and fully tighten all hardware.
13. Plug the wiring harness into the main harness.
14. If front license plate is required, attach the License Plate Bracket to the holes in the bumper with the included (2) 6mm x 20mm Button Head Screws, (4) 6mm x 18mm Large Flat Washers and (2) 6mm Nylon Lock Nuts. Insert (2) Plastic Plugs into the square holes in the Bracket. Reuse the factory screws to attach the license plate to the plastic plugs, **(Figure 19)**.
15. Do periodic inspections to the installation to make sure that all hardware is secure and tight.

**LD1 FRONT BUMPER  
2016-24 NISSAN TITAN XD ONLY**

**To protect your investment,** Do not use any type of polish or wax that may contain abrasives that could damage the finish. Mild soap may be used to clean the Bumper assembly.

**Driver/left Side Installation Pictured**



**(Fig 1) Remove fill panel to access bumper bolts**

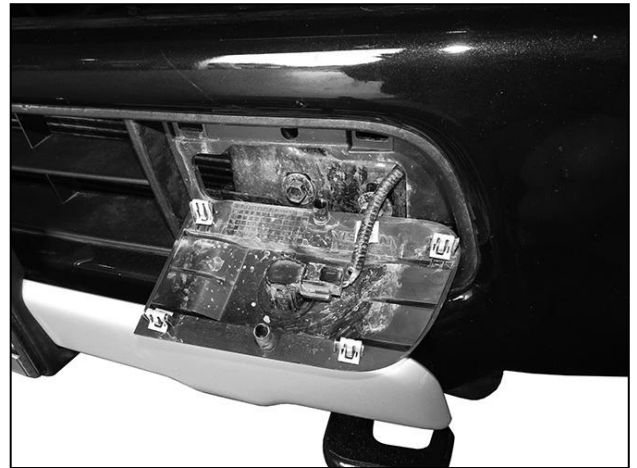

**(Fig 2) Models with sensors, unplug sensors**

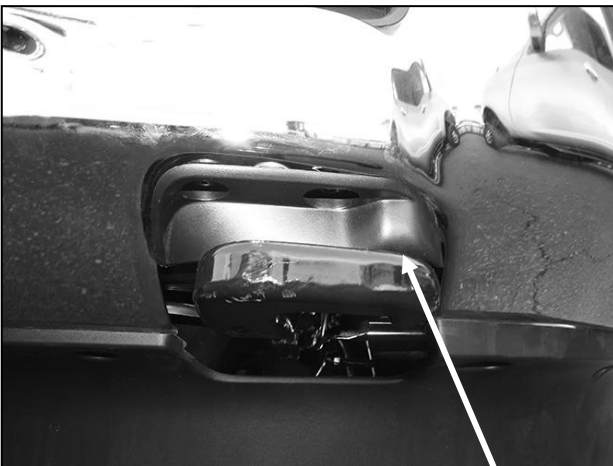

**(Fig 3) Remove plastic panel above tow hook**



**(Fig 4) Remove skid plate if equipped**

Driver/left Side Installation Pictured

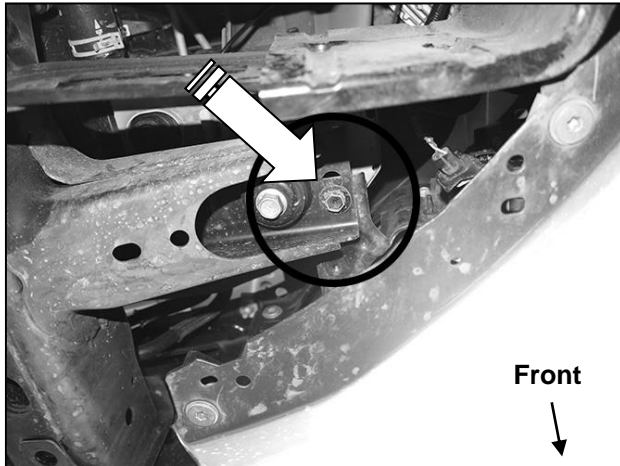

(Fig 5) Remove hex bolts (1 per side) attaching outer bumper bracket to end of frame crossmember (arrow). Passenger/right side pictured from below bumper

**WARNING!** Do not remove bumper bolts unless it is properly supported on blocks or stands or the bumper may fall.

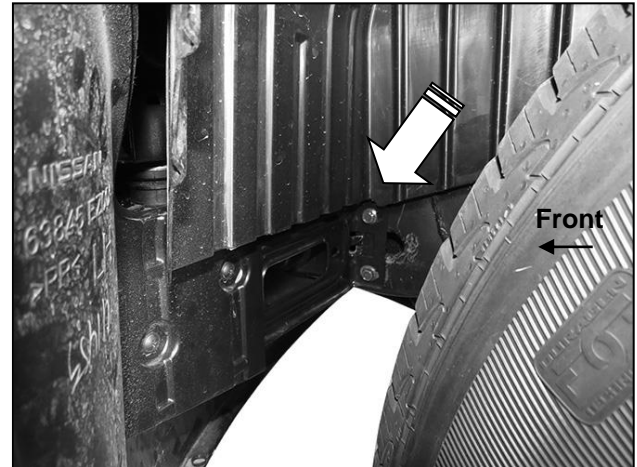

(Fig 6) Remove hardware attaching outer bumper support to side of frame (arrow)

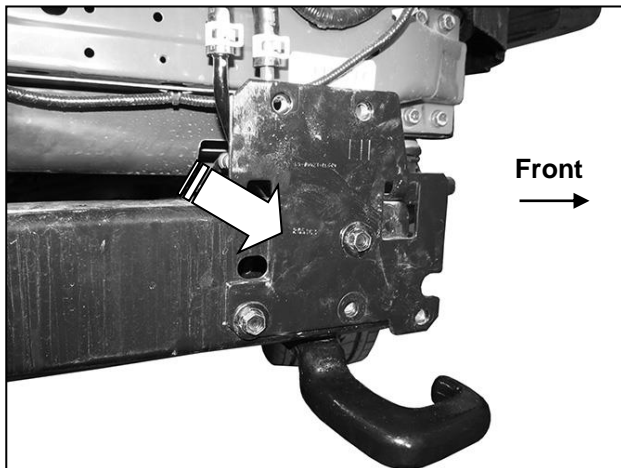

(Fig 7) Remove bumper bracket (arrow)



(Fig 8) Driver/left side of frame

**LD1 FRONT BUMPER  
2016-24 NISSAN TITAN XD ONLY**

**Driver/left Side Installation Pictured**

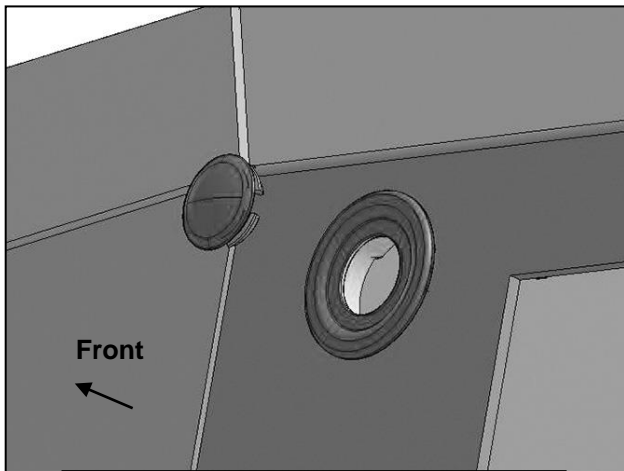

**(Fig 9) Models without sensors, push Hole Plug into sensor mount**

**WARNING!** Do not crawl under bumper unless it is properly supported on blocks or stands or the bumper may fall.

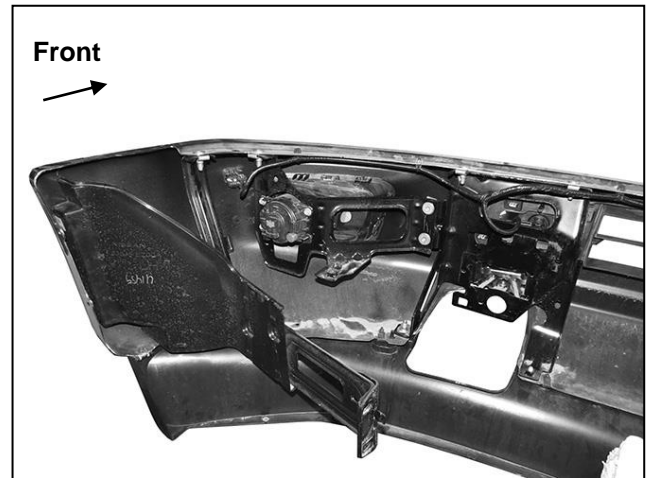

**(Fig 10) Remove sensors and wiring harness (if equipped) from bumper**

**Remove factory washer from sensor**

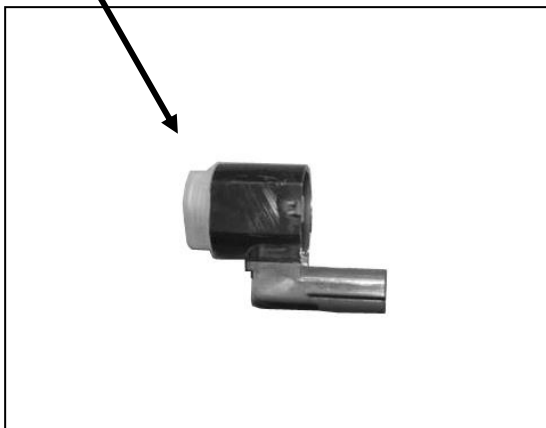

**(Fig 11) Z-Shaped outer sensor**

**Remove factory washer from sensor**



**(Fig 12) Inner L-Shaped Sensor**

**LD1 FRONT BUMPER  
2016-24 NISSAN TITAN XD ONLY**

**Driver/left Side Installation Pictured**

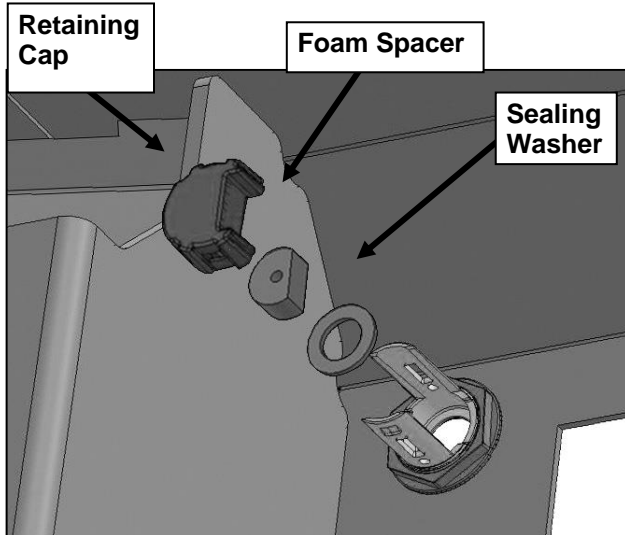

(Fig 13) Push sensor with Foam Seal Washer into mount. Attach Foam Spacer to Cap. Snap Retaining Cap onto mount to secure sensor in place.

**WARNING!** Do not crawl under bumper unless it is properly supported on blocks or stands or the bumper may fall.

(2) 8mm x 16mm Hex Bolts  
(2) 8mm Lock Washers  
(2) 8mm Flat Washers

(2) 8mm x 25mm Hex Bolts  
(4) 8mm Flat Washers  
(2) 8mm Lock Washers  
(2) 8mm Hex Nuts

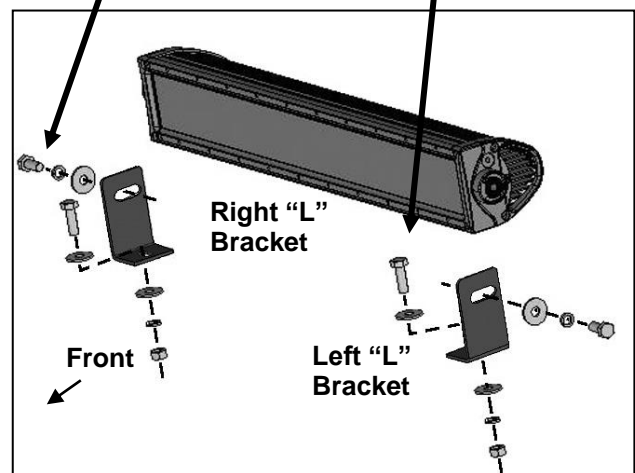

(Fig 14) Example of center light installation

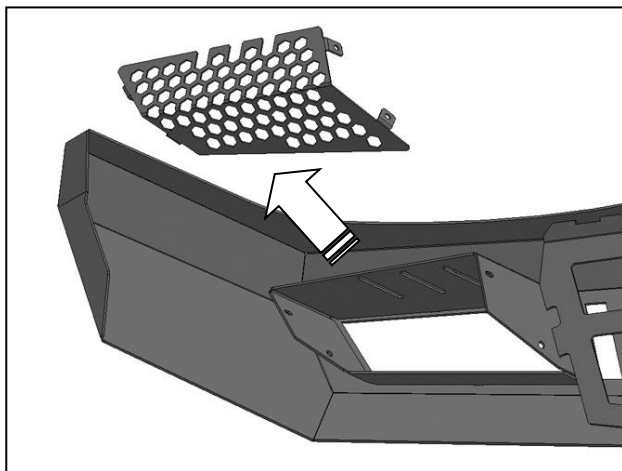

(Fig 15) Remove screens, if necessary, for clearance/access to outer light

(3) Factory bumper bolts

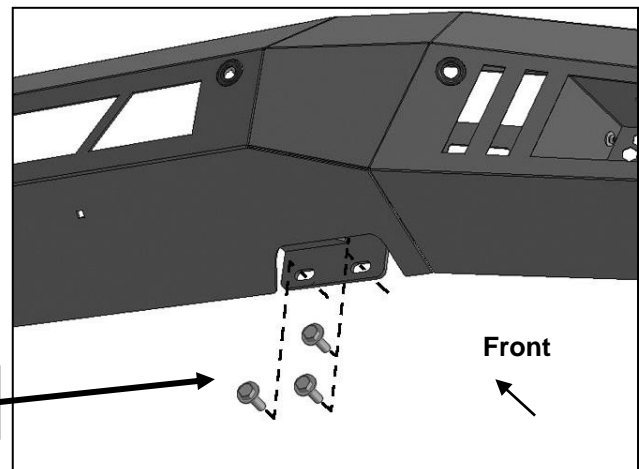

(Fig 16) Reuse the factory hex bolts to attach Bumper to end of frame

**LD1 FRONT BUMPER  
2016-24 NISSAN TITAN XD ONLY**

**Driver/left Side Installation Pictured**



**(Fig 17) Driver/left side complete installation**

**WARNING!** Do not crawl under bumper unless it is properly supported on blocks or stands or the bumper may fall.

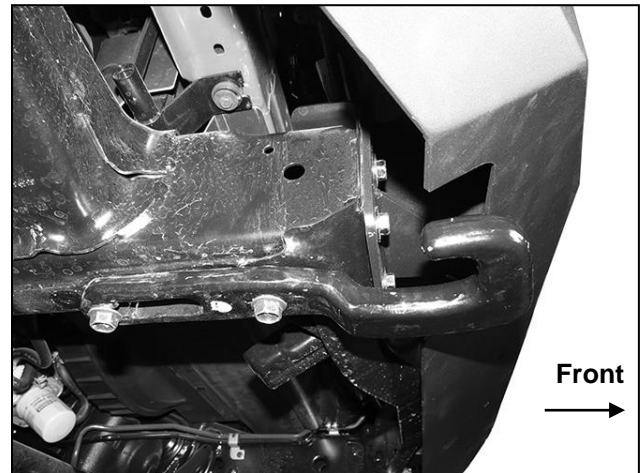

**(Fig 18) Passenger/right side complete installation**

**(2) Plastic  
Plugs**

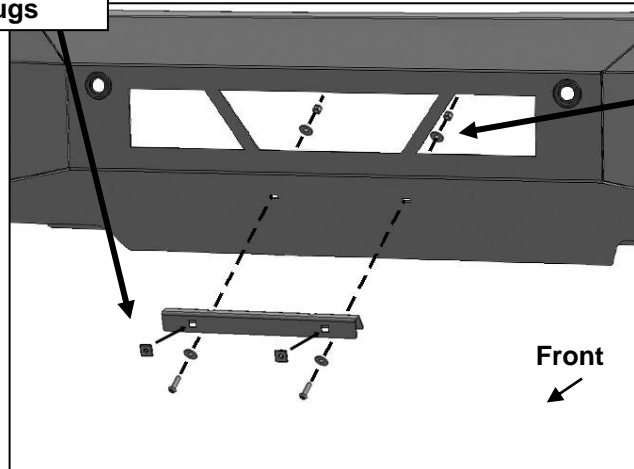

**(Fig 19) Attach License Plate Bracket to Bumper**

**(2) 6mm x 20mm Button  
Head Screws  
(4) 6mm Flat Washers  
(2) 6mm Nylon Lock Nuts**



**Complete Installation**