



**BLACK HORSE
OFF ROAD®**

TEL: 1-866-XANATOS

INSTALLATION INSTRUCTIONS

MD1 FRONT BUMPER

2019-24 RAM 1500 (Excl. Classic, Rebel and Diesel Model)

PART#AFB-RA20-BU

PARTS LIST:

1	MD-1 Front Bumper	2	10mm Double Nut Plates
1	Bumper Top Fill Panel	10	10-1.5mm x 30mm Hex Bolts
1	Driver/left Frame Mounting Bracket	6	10mm x 27mm x 3mm Flat Washers
1	Passenger/right Frame Mounting Bracket	4	10mm x 20mm x 2mm Flat Washers
1	Long Center Mesh Plate	10	10mm Lock Washers
2	Small Outer Mesh Plates	2	10mm Flange Nuts
1	Driver/left "L" Bracket (center LED light)	2	8-1.25mm x 25mm Hex Bolts
1	Passenger/right "L" Bracket (center LED light)	2	8-1.25mm x 16mm Hex Bolts
1	License Plate Bracket	6	8mm x 24mm x 2mm Flat Washers
2	Plastic Plugs for license plate mount	4	8mm Lock Washers
1	LED Wiring Harness Kit	2	8mm Hex Nuts
6	Sensor Retaining Caps	10	6-1.0mm x 20mm Combo Bolts
6	20mm x 10mm Foam Spacers	5	6-1.0mm x 20mm Button Head Bolts
6	15.5mm x 25mm x 2mm Foam Seals	10	6mm x 18mm x 1.6mm Flat Washers
6	Sensor Hole Plugs	10	6mm Flange Nuts
2	Sensor Wiring Harness Extensions	5	6mm Nylon Lock Nuts
6	12-1.75mm x 35mm Hex Bolts	12	Self-Tapping Screws
12	12mm x 32mm x 3mm Flat Washers	1	4mm Wrench
6	12mm Lock Washers	10	Nylon Wire Ties
6	12mm Hex Nuts		

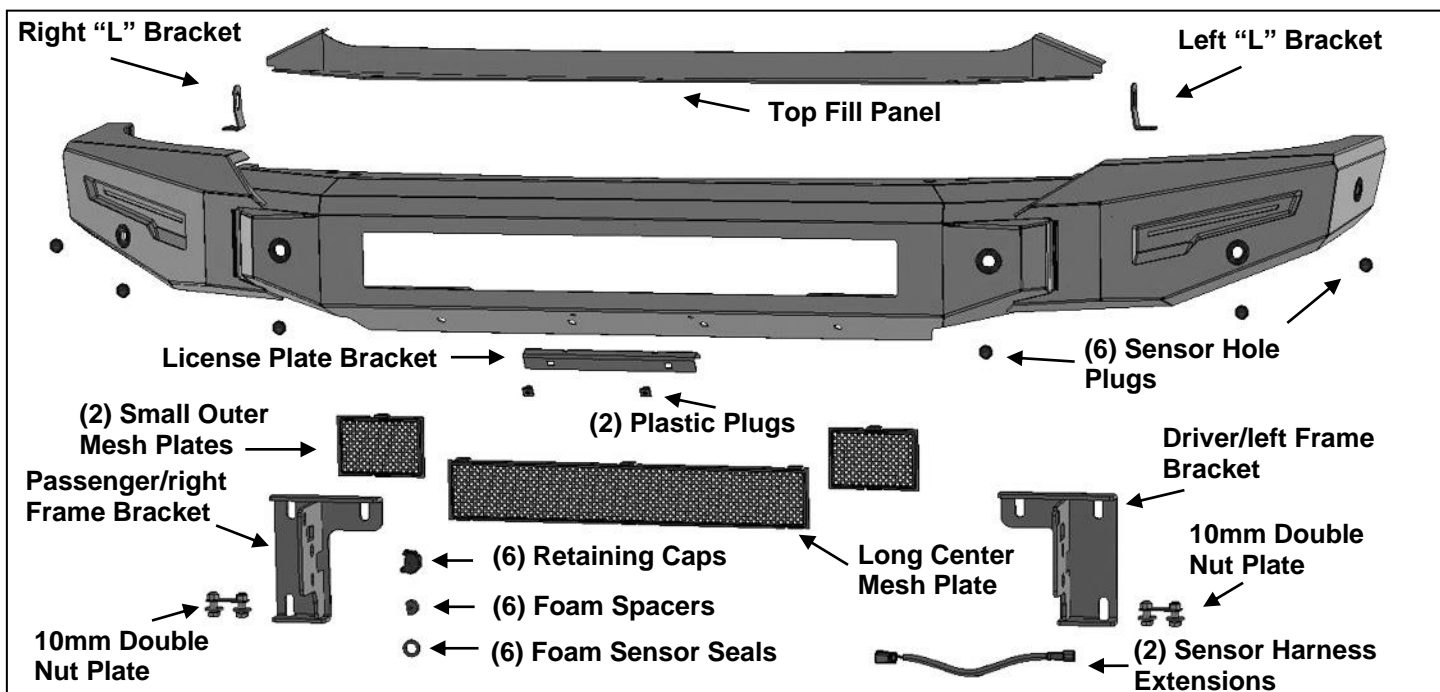

PROCEDURE:

REMOVE CONTENTS FROM BOX. VERIFY ALL PARTS ARE PRESENT. READ INSTRUCTIONS CAREFULLY BEFORE STARTING INSTALLATION. BUMPER IS HEAVY, ASSISTANCE IS HIGHLY RECOMMENDED TO AVOID POSSIBLE INJURY OR DAMAGE TO THE VEHICLE.

1. Remove the license plate and bracket.
2. On the driver/left side of the bumper, remove the (2) factory bolts attaching the side of the bumper cover to the side of the frame, (**Figure 1**). Repeat this Step for the passenger/right side.
3. Starting from under the front bumper, locate and unplug the main wire harness on the driver/left side of the bumper, (**Figure 2**).

**MD-1 FRONT BUMPER
2019-24 RAM 1500**

4. Place blocks or jack stands under the bumper to support it during hardware removal. Once the bumper has been safely supported, remove the (3) factory flange nuts attaching each bumper bracket to the end of the frame, **(Figures 2 & 3)**. **WARNING!** Assistance is required to hold bumper in place during hardware removal to prevent the bumper from falling. Slide the bumper assembly off of the end of the frame and place bumper on stable clean flat surface, **(Figure 4)**.
5. Select the driver/left Frame Mounting Bracket, **(Figure 5)**. Attach the Bracket to the end of the frame with the included (3) 12mm x 35mm Hex Bolts, (6) 12mm Flat Washers, (3) 12mm Lock Washers and (3) 12mm Hex Nuts, **(Figure 6)**. Do not fully tighten hardware at this time. Repeat this Step to attach the passenger/right Frame Bracket.
6. Carefully unwrap the Bumper assembly. Pull outward to unfold the passenger/right outer wing until fully extended, **(Figure 7)**. Anchor the Wing to the back of the Bumper with the included (2) 10mm x 30mm Hex Bolts, (2) 10mm Lock Washers and (2) 10mm x 20mm Small Flat Washers, **(Figure 8)**. Leave hardware loose at this time. Repeat this Step to unfold and attach the driver/left Wing to the Bumper. **IMPORTANT:** There is a small amount of adjustment in the Wings that can increase or decrease the final width of the Bumper. Loosen the (2) pivot bolts and the (2) anchor bolts and pull each Wing outward as far as possible to start, **(Figure 9)**. Snug hardware but do not fully tighten.
7. Select the Top Fill Panel, **(Figure 10)**. Attach the Fill Panel to the inside, top of the Bumper with the included (3) 6mm x 20mm Button Head Bolts, (6) 6mm Flat Washers and (3) 6mm Nylon Lock Nuts.
8. Determine if the vehicle is equipped front sensors:

Models without bumper sensors:

- a. Select the included (6) Plastic Plugs.
- b. From the front, push the plugs into the sensor mounting holes, **(Figure 11)**.

Models with bumper mounted parking sensors:

- a. Disassemble the factory front bumper to unplug and remove sensors and wiring harness from bumper. Pay attention to mounting location of all sensors for proper reinstallation.
 - b. Select the driver/left outer sensor. Remove the silicone seal from the end of the sensor. Slide the included larger Foam Sensor Seal over front of sensor, **(Figure 12)**.
 - c. Insert sensor with Seal into driver/left outer sensor mount, **(Figure 13)**.
 - d. Place Foam Spacer over end of sensor. Push Sensor Retaining Cap onto sensor mount and lock into mounting holes, **(Figure 13)**.
 - e. Repeat previous Steps to install remaining sensors.
 - f. Install wiring harness for sensors. **NOTE:** Use the included (2) Wire Harness Extensions to extend the length of the factory harness to reach all sensors.
 - g. **Optional:** Secure each sensor to the socket with (2) 4mm Self Tapping Screws. **IMPORTANT:** Sensors fit snug in sockets. The 4mm Screws are used to apply slight pressure to lock the sensors in place. Tighten both screws evenly until they touch the sensor body only. Do not overtighten screws or damage to sensors will result.
9. With assistance, position the Bumper Assembly up to the frame. Temporarily support the weight of the Bumper. **WARNING:** To avoid possible injury or damage to the vehicle, do not proceed until the bumper is fully and safely supported.
 10. Attach the driver/left side of the Bumper to the top mounting hole in the Bracket with the included (1) 10mm x 30mm Hex Bolt, (1) 10mm Lock Washer, (1) 10mm x 27mm Large Flat Washer and (1) 10mm Flange Nut, **(Figure 14)**. Line up the (2) slots in the Bumper with the Bracket. Hold (1) 10mm Double Nut Plate up to the outside of the Bumper Bracket. Attach the Bumper to the Bracket and Nut Plate with (2) 10mm x 30mm Hex Bolts, (2) 10mm Lock Washers and (2) 10mm x 27mm Large Flat Washers, **(Figures 15 & 16)**. Do not fully tighten hardware at this time. Repeat to attach the passenger/right side of the Bumper to the Bracket.
 11. Level and adjust the Bumper and fully tighten all hardware. **IMPORTANT:** Adjust wings on bumper as needed and fully tighten all wing pivot and mounting hardware, **(Figure 9)**. If necessary, temporarily remove bumper to fully tighten inner 10mm anchor hardware.
 12. Determine if accessory lights, (not included), or Screen Fill Panels will be installed at this time.

Screen Fill Panel Installation (do not install fill panels if installing lights).

- a. Select desired long center or small outer Screen Fill Panels, **(Figure 17)**.

**MD-1 FRONT BUMPER
2019-24 RAM 1500**

- b. Attach Screen Fill Panels as needed with the included 6mm Button Head Combo Bolts and 6mm Flange Nuts, **(Figure 17)**. Fully tighten Fill Panel hardware at this time. Repeat to install all Panels as desired.

Inner center LED bar style light installation (light not included).

- a. Select the passenger/right “L” Light Bar Bracket, **(Figure 18)**. **NOTE:** “L” Brackets are offset to adjust for different widths of LED Bar Lights and can be installed on either side as needed.
 - b. Attach the “L” Bracket to the slot on the back of the Bumper with (1) 8mm x 25mm Hex Bolt, (2) 8mm Flat Washers, (1) 8mm Lock Washer and (1) 8mm Hex Nut, **(Figure 18)**. Repeat this Step to install the remaining “L” Bracket on the other side of the Bumper. **IMPORTANT:** The Bumper features slots designed for most 20” and 30” bar style lights. Attach the Brackets to the correct slots in the Bumper. If necessary, hold the light up to the slots to determine correct slots to use.
 - c. Attach the light to the “L” Brackets with the hardware included with the light or the supplied (2) 8mm x 16mm Hex Bolts, (2) 8mm Lock Washers and (2) 8mm Flat Washers, **(Figure 18)**. Do not fully tighten hardware at this time.
13. Attach the License Plate Bracket to the holes in the bumper with the included (2) 6mm x 20mm Button Head Screws, (4) 6mm Flat Washers and (2) 6mm Nylon Lock Nuts, **(Figure 19)**. Insert (2) Plastic Plugs into the square holes in the Bracket. Reuse the factory screws to attach the license plate to the plastic plugs.
 14. Models with parking sensors, plug the bumper wiring harness into the factory harness.
 15. Do periodic inspections to the installation to make sure that all hardware is secure and tight.

To protect your investment, Do not use any type of polish or wax that may contain abrasives that could damage the finish. Mild soap may be used to clean the Bumper assembly

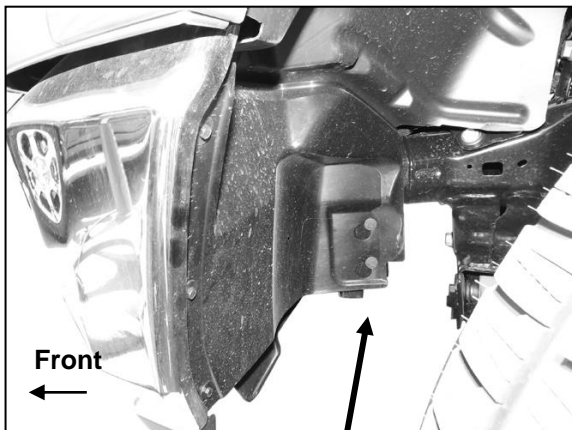

(Fig 1) Remove the (2) factory bolts attaching the side of the bumper to the frame (Driver/left side pictured)

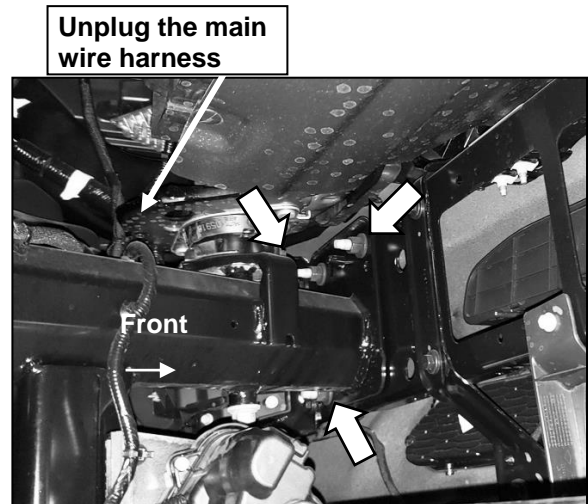

(Fig 2) Remove the (3) factory flange nuts from the driver/left side frame

WARNING! Do not remove bumper bolts unless the bumper is properly supported on blocks or stands or it may fall.

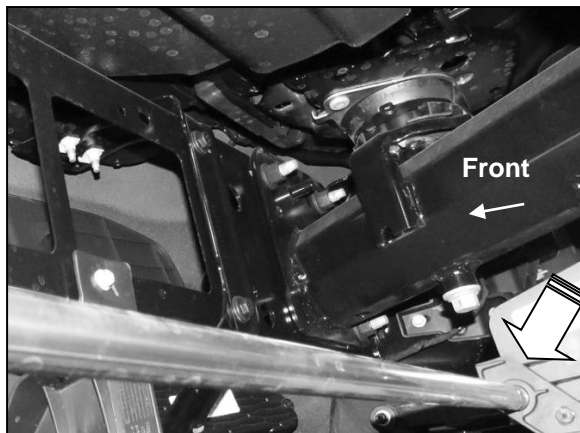

(Fig 3) Unplug and remove the active air dam if equipped (arrow). Passenger/right side of frame pictured

WARNING! Do not remove bumper bolts unless the bumper is properly supported on blocks or stands or it may fall.

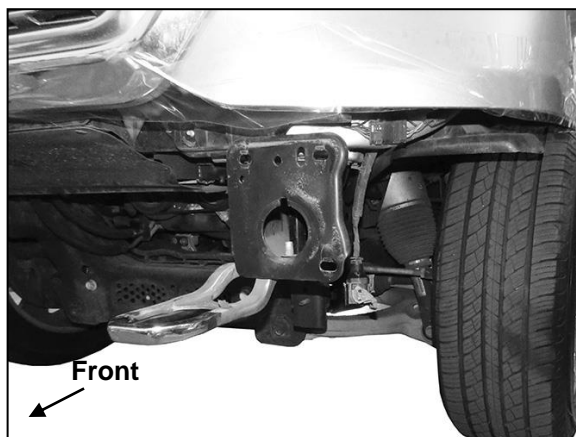

(Fig 4) Driver/left side end of frame

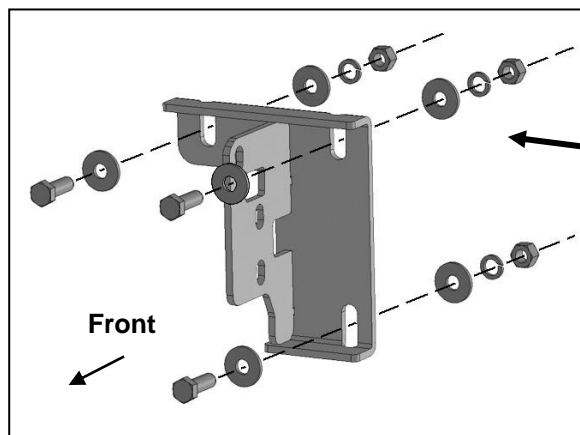

(Fig 5) Attach driver/left Mounting Bracket to end of frame

- (3) 12mm x 35mm Hex Bolts
- (6) 12mm Flat Washers
- (3) 12mm Lock Washers
- (3) 12mm Hex Nuts

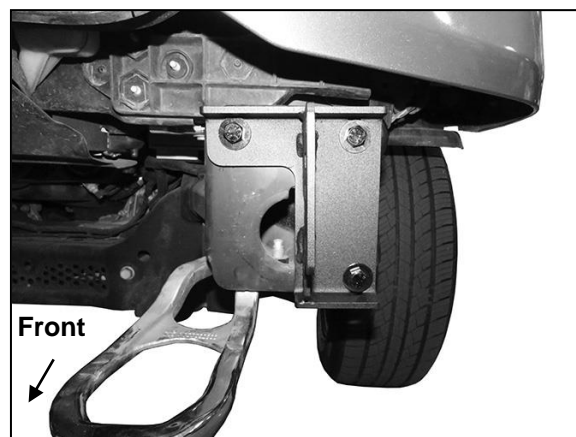

(Fig 6) Driver/left Bracket installed

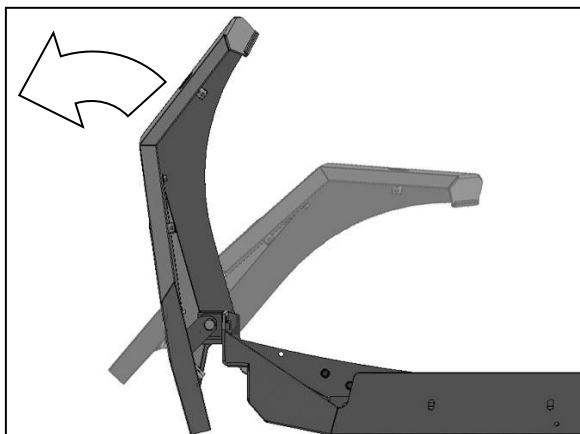

(Fig 7) Unfold outer Wings from center Bumper.

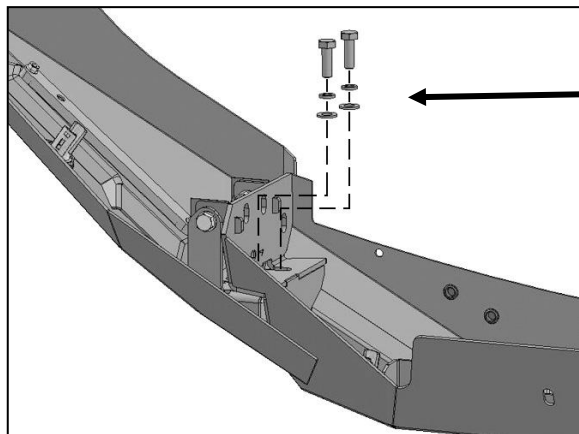

(Fig 8) Anchor outer Wings to back of center Bumper

- (2) 10mm x 30mm Hex Bolts
- (2) 10mm Lock Washers
- (2) 10mm x 20mm Small Flat Washers

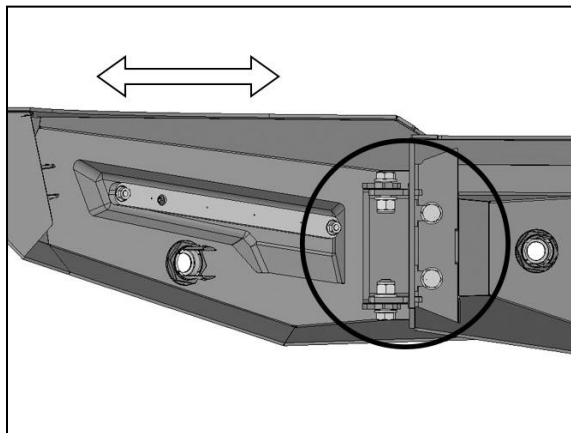

(Fig 9) Loosen hardware and pull Wing outward to widen overall Bumper

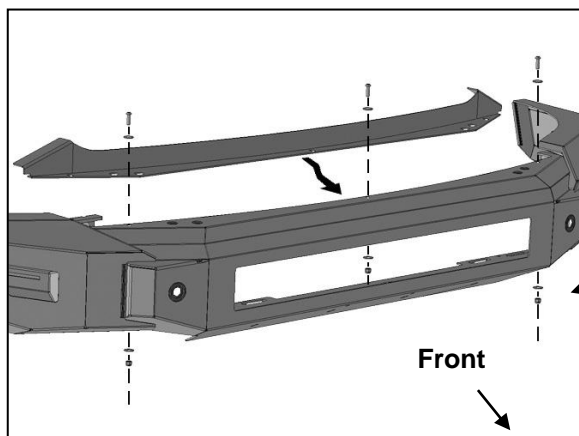

(Fig 10) Attach Top Fill Panel to inside/top of Bumper

- (3) 6mm x 20mm Button Head Bolts
- (6) 6mm Flat Washers
- (3) 6mm Nylon Lock Nuts

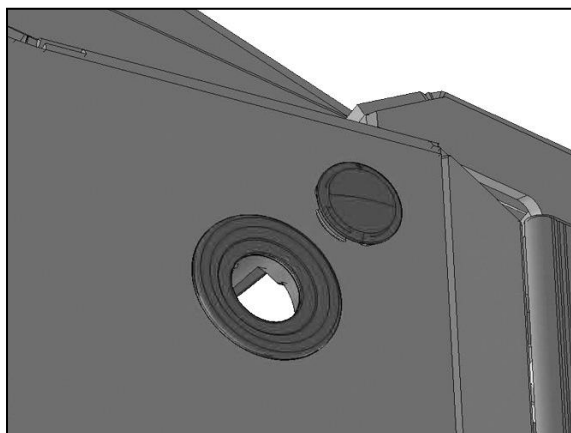

(Fig 11) Push Plastic Plug into sensor mount



(Fig 12) Remove silicone seal from sensor. Slide large Seal over end of sensor (arrow)

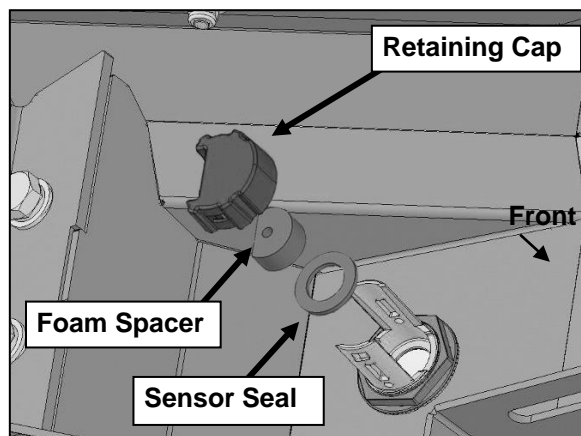

(Fig 13) Insert sensor assembly into the sensor mount on back of Bumper

WARNING! Do not crawl under bumper unless it is properly supported on blocks or stands or the bumper may fall.

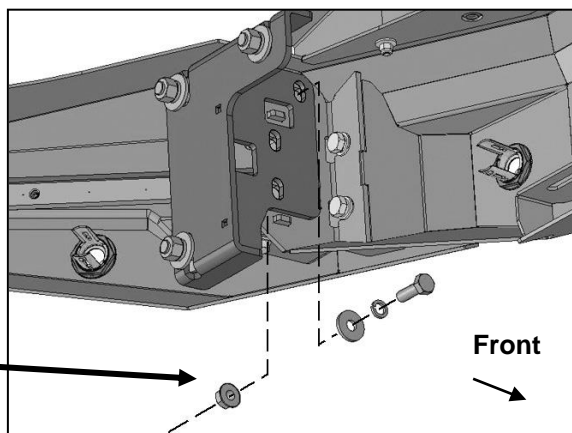

(Fig 14) Insert 10mm Hex Bolt and Washers through top mounting hole in Bracket and Bumper (diver/left side illustrated)

10mm Double Nut Plate

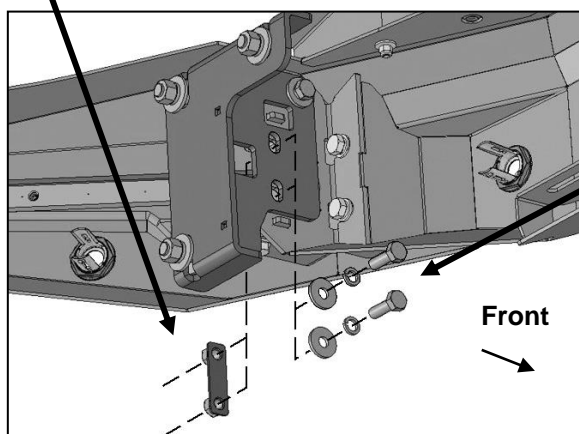

(Fig 15) Insert 10mm Hex Bolts and Washers through center mounting holes and into 10mm Double Nut Plate

(2) 10mm x 30mm Hex Bolts
(2) 10mm Lock Washers
(2) 10mm x 27mm Large Flat Washers

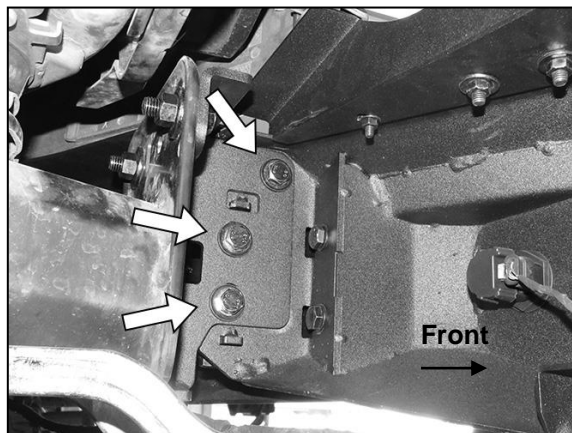

(Fig 16) Driver/left side complete installation pictured from behind Bumper

**MD-1 FRONT BUMPER
2019-24 RAM 1500**

(10) 6mm Combo Bolts
(10) 6mm Flange Nuts

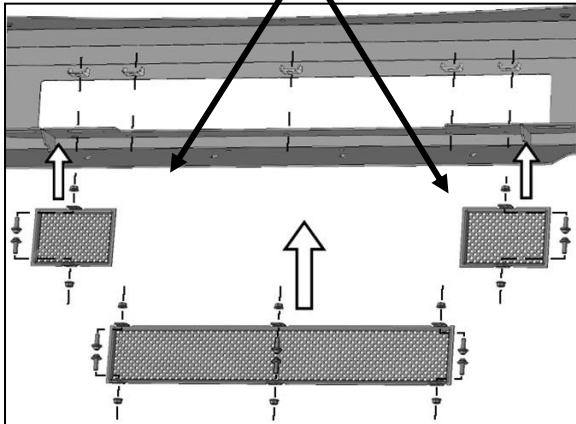

(Fig 17) Attach Outer and Center Mesh Plates to tabs on the back of the bumper as desired

WARNING! Do not crawl under bumper unless it is properly supported on blocks or stands or the bumper may fall.

8mm x 25mm Hex Bolt
(2) 8mm Flat Washers
8mm Lock Washer
8mm Hex Nut

8mm x 16mm Hex Bolt
8mm Lock Washer
8mm Flat Washer

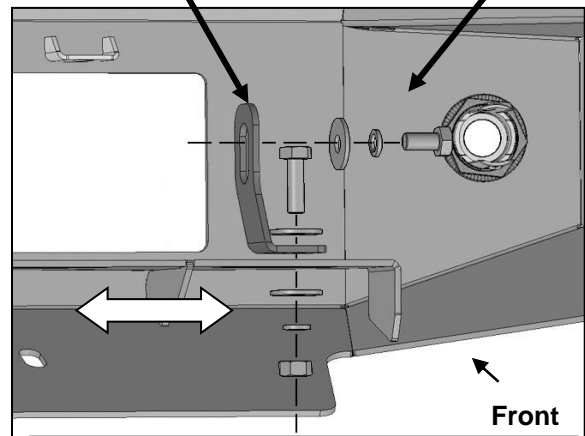

(Fig 18) Passenger/right side "L" Bracket attached to the back of the bumper.
NOTE: Mount the "L" Bracket to the proper slot for the size of led light

(2) 6mm x 20mm Button Head Screws
(4) 6mm Flat Washers
(2) 6mm Nylon Lock Nuts

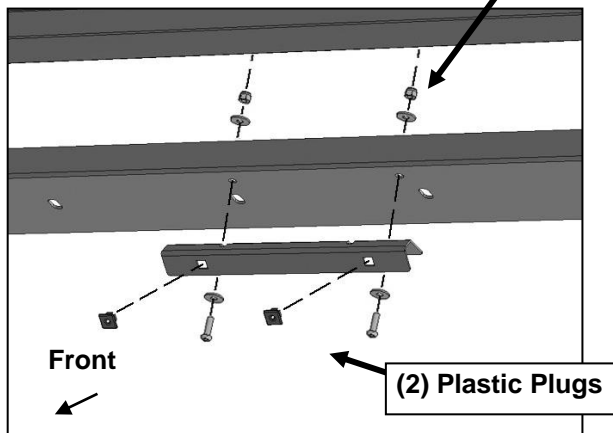

(Fig 19) Attach License Plate Bracket to Bumper



Complete Bumper installation pictured with Light Bar Hoop and light (not included)

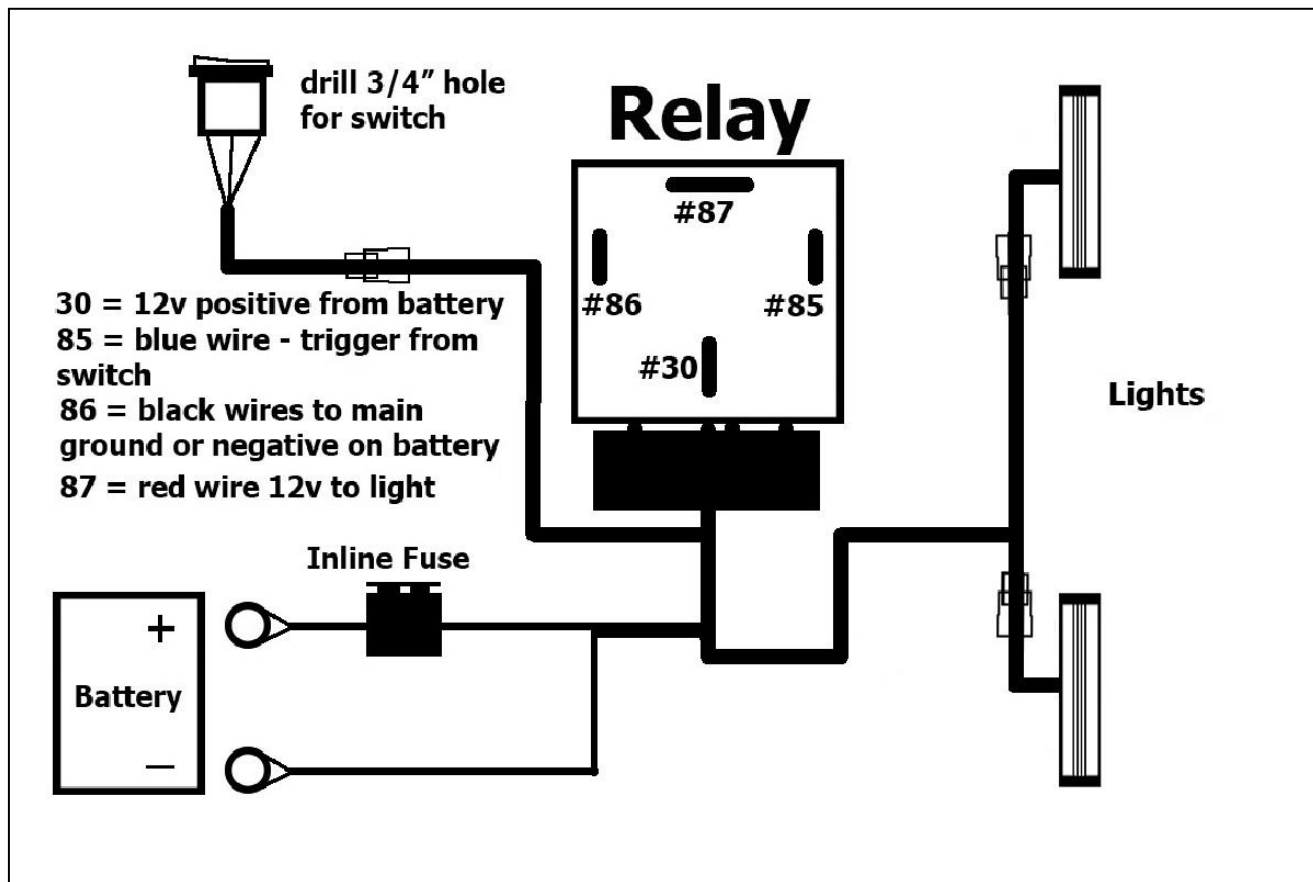

GENERAL LIGHT WIRING PROCEDURE:

1. REMOVE CONTENTS FROM BOX. VERIFY ALL PARTS ARE PRESENT. READ INSTRUCTIONS CAREFULLY. DRILLING IS REQUIRED. ELECTRICAL KNOWLEDGE IS HIGHLY RECOMMENDED.
2. Open hood and disconnect battery.
3. Unwrap preassembled wiring harness. Disconnect the plug in the harness leading to the lighted switch. Locate suitable mounting location for switch. Drill 3/4" hole in panel to mount switch. **IMPORTANT:** Do not drill any holes in panel until back of location is properly checked for clearance. Use of safety goggles is required.
4. Run switch harness through firewall on vehicle. Drill hole through firewall as required for harness plug. Highly recommend use of rubber grommet (not included) to protect harness. Feed switch harness plug through hole in firewall. Seal firewall with silicone as necessary.
5. Attach Relay and main harness to suitable location near battery (firewall or inner fender for example). Do not connect to battery at this time.
6. Attach switch plug to switch harness and tie harness away from anything that could damage harness.
7. Run the prewired light harness down to each light. Plug harness into prewired plug on each light. Tie wiring harness away from anything that could damage harness.
8. Attach the fused red positive and black negative wires on the main harness to the battery. **NOTE:** Attach black negative wire to negative terminal on battery or suitable chassis ground.
9. Reattach battery cables to battery. Installation is complete.
10. Do periodic inspections to the installation to make sure that all hardware is secure and tight and all wiring harnesses are properly secured and free from excessive movement.