



**TEL: 1-866-XANATOS**

# **INSTALLATION INSTRUCTIONS**

**MODULAR RUGGED GRILLE GUARD  
17-24 NISSAN TITAN  
PART# RU-NIT17-B**

**PARTS LIST:**

1	Main Body	4	12mm Nylon Lock Nuts
1	Driver/Left Brush Guard	2	10-1.5mm x 30mm Button Head Bolts
1	Passenger/Right Brush Guard	4	10mm x 27mm x 3mm Flat Washers
2	LED Lamp Bracket	2	10-1.5mm Nylon Lock Nuts
1	Driver/Left Frame Mounting Bracket	4	8-1.25mm x 25mm Hex Bolts
1	Passenger/Right Frame Mounting Bracket	22	8mm x 24mm OD x 2mm Flat Washers
1	2017-19 1pc Driver/Left Frame Bracket Fill Panel	4	8mm Lock Washers
1	2017-19 1pc Passenger/Right Frame Bracket Fill Panel	10	8-1.25mm x25mm Button Head Bolts
1	2020-on Driver/Left Outer Fill Panel	8	8-1.25mm Nylon Lock Nuts
1	2020-on Passenger/Right Outer Fill Panel	4	5mm x 20mm Button Head Bolts
1	2020-on Driver/Left Inner Fill Panel	8	5mm x 10mm x 1mm Flat Washers
1	2020-on Passenger/Right Inner Fill Panel	4	5mm Nylon Lock Nuts
1	Driver/Left Side Top Support Bracket	2	250mm x 50mm x 1mm Foam Tape
1	Passenger/Right Side Top Support Bracket	1	2.5mm Wrench
2	Top Support Mounting Brackets	1	3mm Wrench
4	12-1.75mm x 40mm Hex Bolts	1	5mm Wrench
8	12mm x 37mm x 3mm Flat Washers	1	6mm Wrench

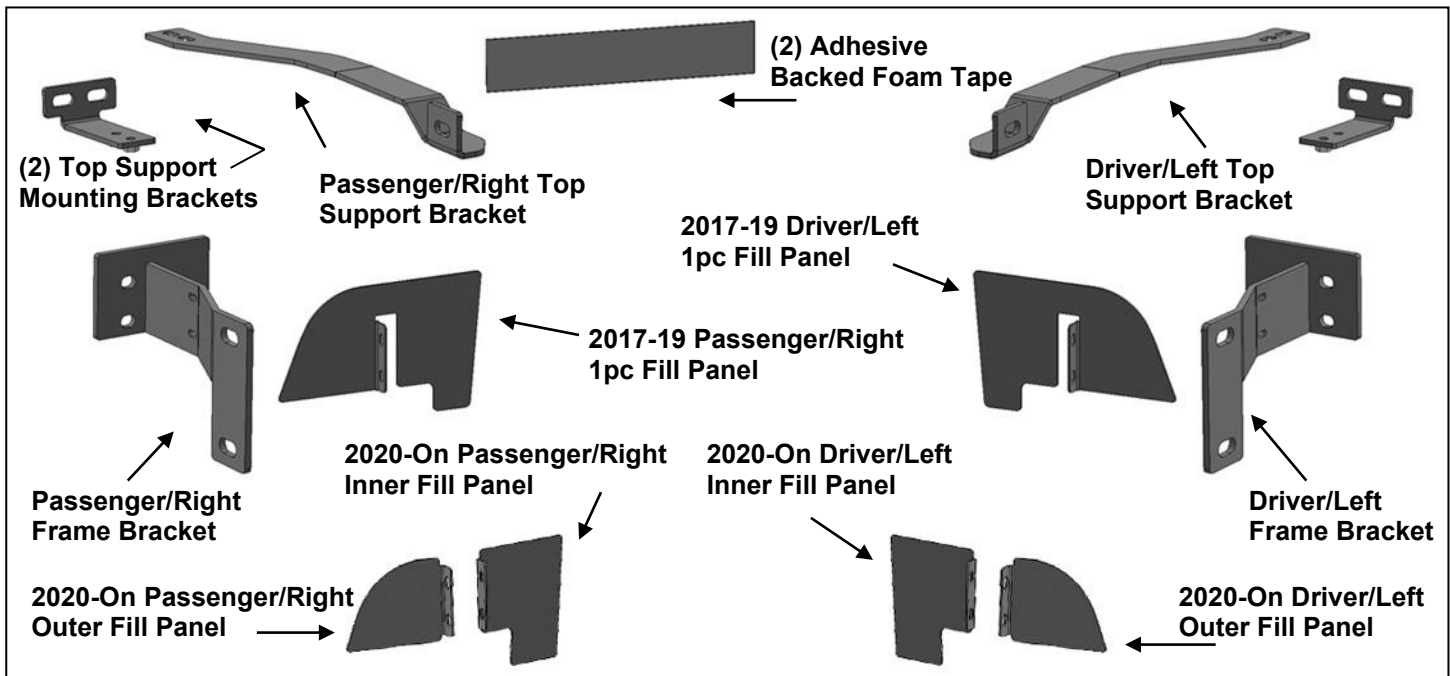

**(2)LED lamp Bracket**



**Main Body  
For example only**

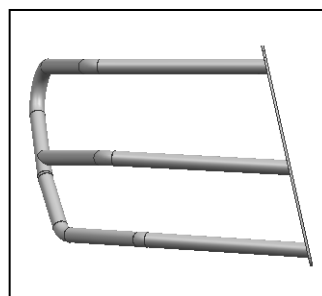

**Passenger/Right  
Brush Guard  
For example only**

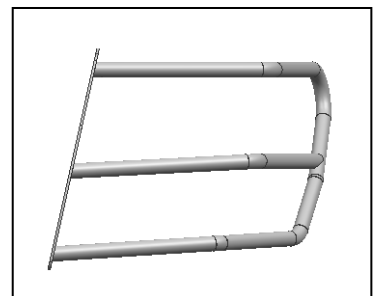

**Driver/Left  
Brush Guard  
For example only**

**Please Noted:**

1. Before you install the Grille Guard on the vehicle, please install the Driver/Left Brush Guard and Passenger/Right Brush Guard on the main body first.
2. Before you install the LED Lamp on the main body please install the LED Lamp Bracket first.
3. If you are not going to install a LED Lamp, the LED Lamp Bracket installation is unnecessary. For main body installation follow the instruction as bellow.

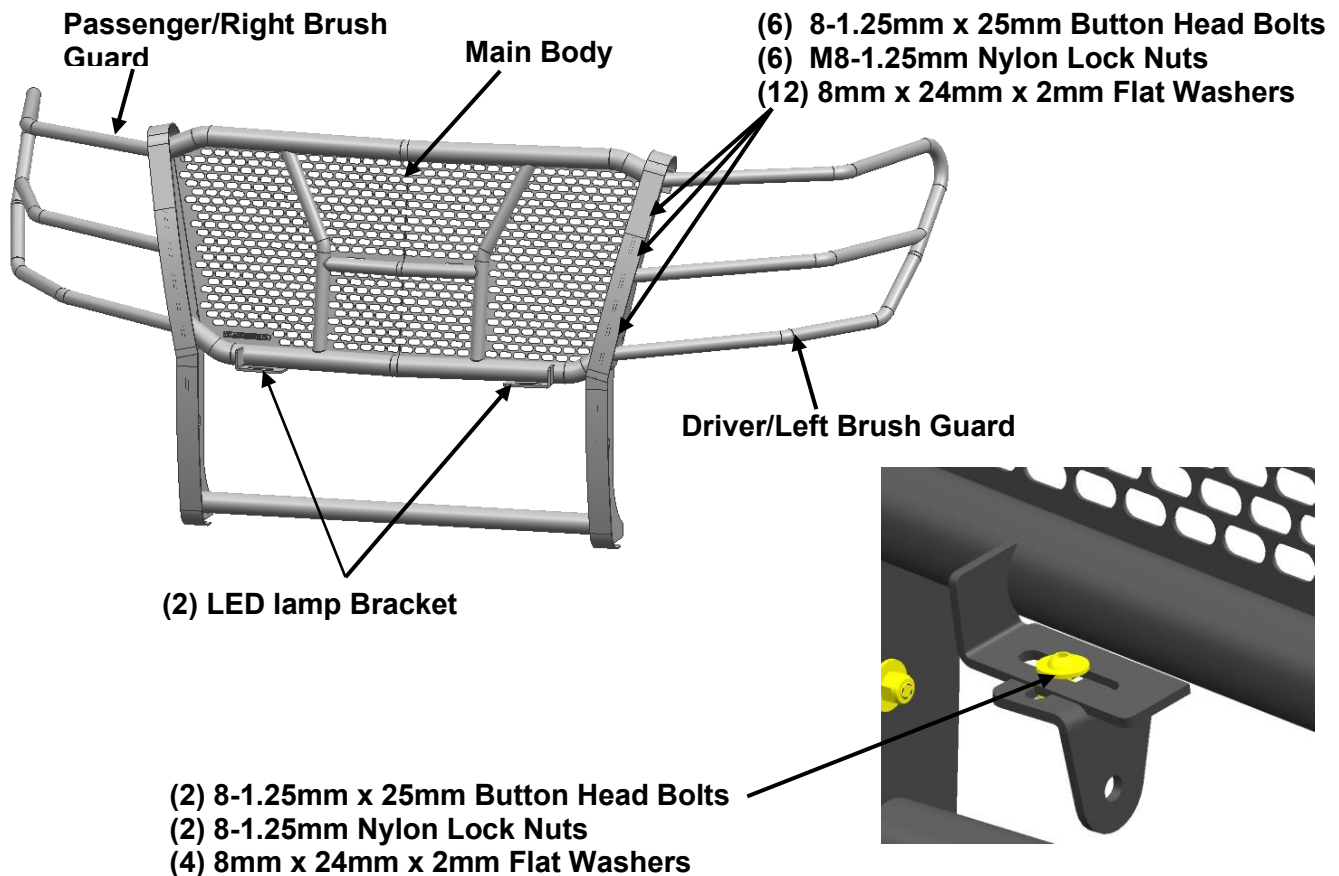

**PROCEDURE:**

**REMOVE CONTENTS FROM BOX. VERIFY ALL PARTS ARE PRESENT. READ INSTRUCTIONS CAREFULLY BEFORE STARTING INSTALLATION. ASSISTANCE IS RECOMMENDED.**

1. Start installation at the front of the driver/left side of the vehicle. Remove the plastic panel surrounding the tow hook, **(Figure 1)**. **NOTE:** On models with bumper mounted sensors, unplug harness leading to sensor to remove panel. Panel will not be reinstalled. **NOTE:** Sensor relocation kit sold separately. Contact your retailer/dealer for purchase.
2. Through the opening in the bumper, remove the (3) factory hex bolts attaching the bumper bracket to the end of the frame, **(Figure 2)**. Select the driver/left Frame Mounting Bracket, **(Figure 3)**. Reuse the factory hex bolts to attach the Frame Bracket to the end of the frame, **(Figures 3 & 4)**. Do not fully tighten hardware.
3. Repeat **Steps 1 & 2** to install the passenger/right Frame Mounting Bracket.
4. Next, open the hood and remove the plastic cover from the top of the grille and radiator, **(Figure 5)**. **NOTE:** Insert flat blade screwdriver into clips attaching cover. Rotate clips 1/4 turn to release clips.
5. Once top cover is removed, next carefully remove the grille. Pay attention to the type and location of all fasteners for easier reinstallation.
6. In the space between the bottom of the driver/left side headlight assembly and the side of the radiator, locate and remove the bottom (2) factory hex bolts in the bottom of the body panel directly above the

- body mount, **(Figure 6)**. Select (1) Top Mounting Bracket, **(Figure 7)**. Reuse the (2) factory hex bolts to attach the Bracket to the body panel, **(Figure 8)**. Do not fully tighten hardware at this time.
7. Select the driver/left Top Support Bracket, **(Figure 9)**. Apply a section of Adhesive Backed Foam Tape to the top and bottom of the Bracket as indicated. **IMPORTANT:** Cover any part of the Support Bracket that may come in contact with the bumper or plastic fascia body panel.
  8. Carefully slide the flat end of the Support Bracket through the gap between the top of the steel bumper and the bottom of the plastic fascia body panel, **(Figures 4 & 12)**. Attach the Top Support Bracket to the Top Mounting Bracket with (2) 8mm x 25mm Hex Bolts, (2) 8mm Lock Washers and (2) 8mm Flat Washers, **(Figures 10 & 11)**. Do not fully tighten hardware at this time.
  9. Repeat **Steps 6—8** to install the passenger/right Top Mounting Bracket and Support Bracket.
  10. With assistance, position the Grille Guard onto the outside of the Brackets. Attach the Grille Guard to the Frame Brackets with (4) 12mm Hex Bolts, (8) 12mm Flat Washers and (4) 12mm Nylon Lock Nuts, **(Figure 13)**. Snug but do not fully tighten hardware.
  11. Attach the Top Support Brackets to the Grille Guard with (2) 10mm Button Head Bolts, (4) 10mm Flat Washers and (2) 10mm Nylon Lock Nuts, **(Figure 13)**. Do not tighten hardware at this time.
  12. Level and adjust the Grille Guard and fully tighten all hardware.
  13. Reinstall the grille and plastic cover. **NOTE**, remove any clips remaining attached to body. Attach all clips to grille first before reinstalling grille.
  14. Determine year of vehicle:  
**2017-19 models:**
    - a. Select the driver/left 1pc Bumper Fill Panel, **(Figure 14)**.
    - b. Attach the Panel to the Frame Mounting Bracket with the included (2) 5mm Button Head Bolts, (4) 5mm Flat Washers and (2) 5mm Nylon Lock Nuts, **(Figure 14)**.
    - c. Repeat this Step to attach the passenger/right Fill Panel.**2020-On models:**
    - a. Select the driver/left Inner and Outer Bumper Fill Panels, **(Figure 15)**.
    - b. Attach the Panels to the Frame Mounting Bracket with the included (2) 5mm Button Head Bolts, (4) 5mm Flat Washers and (2) 5mm Nylon Lock Nuts, **(Figure 15)**.
    - c. Repeat this Step to attach the passenger/right Fill Panels.
  15. Repeat this Step to attach the passenger/right Fill Panels.
  16. Models equipped with grille mounted camera, remove center screen from Grille Guard, **(Figure 16)**.
  17. Do periodic inspections to the installation to make sure that all hardware is secure and tight.

**To protect your investment**, wax this product after installing. Regular waxing is recommended to add a protective layer over the finish. Do not use any type of polish or wax that may contain abrasives that could damage the finish. Mild soap may be used to clean the Grille Guard.

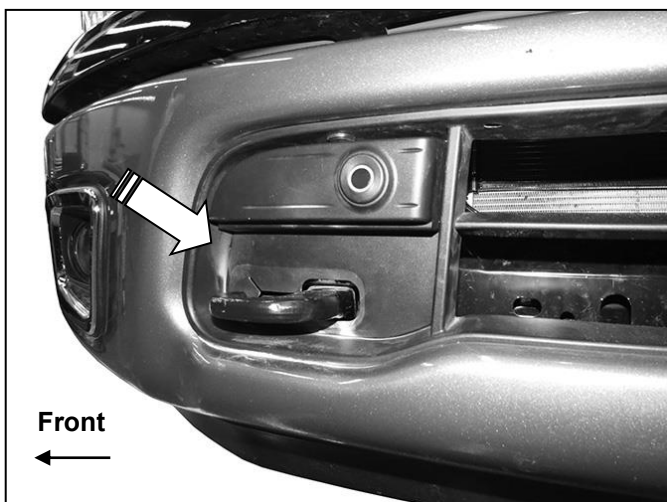

**(Fig 1) Remove plastic panel (arrow). Passenger/right side pictured with factory tow hook**



**(Fig 2) Remove plastic panel. Models with parking sensors, unplug harness**

**Driver/left Side Installation Pictured**

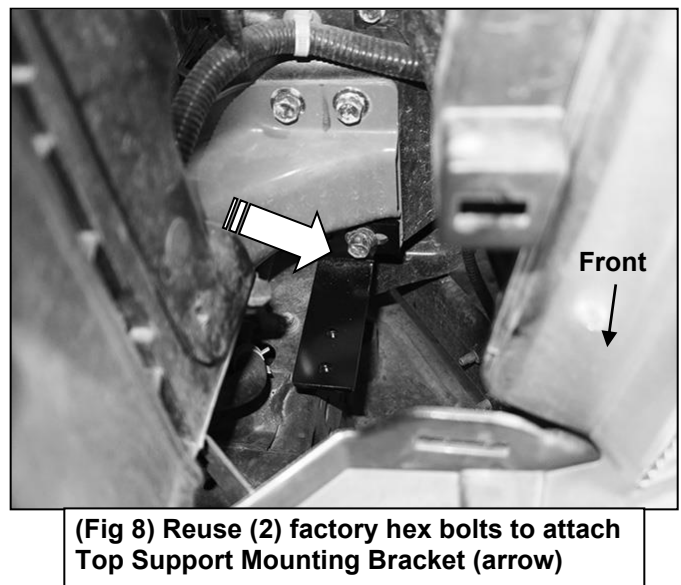
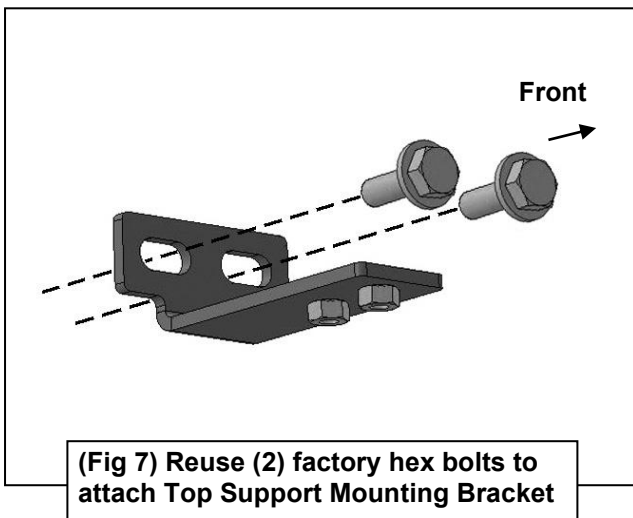
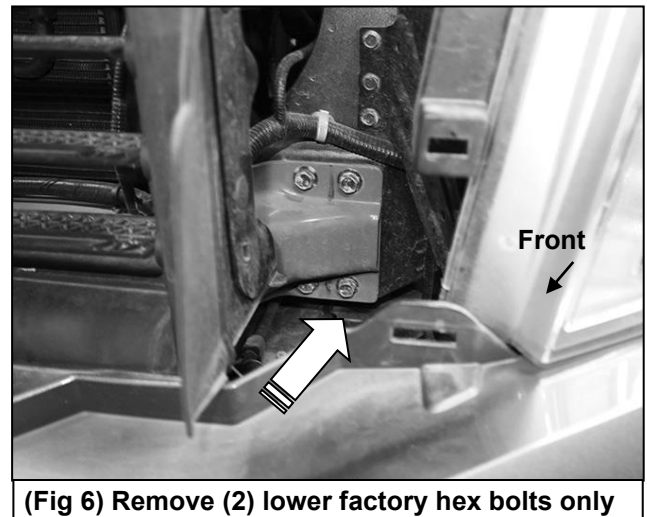
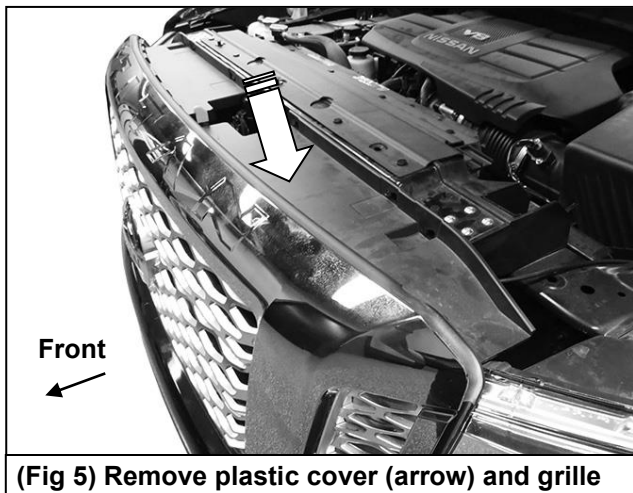
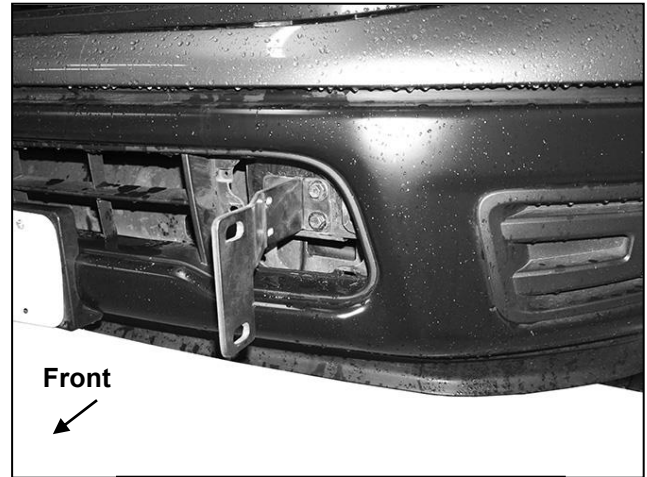
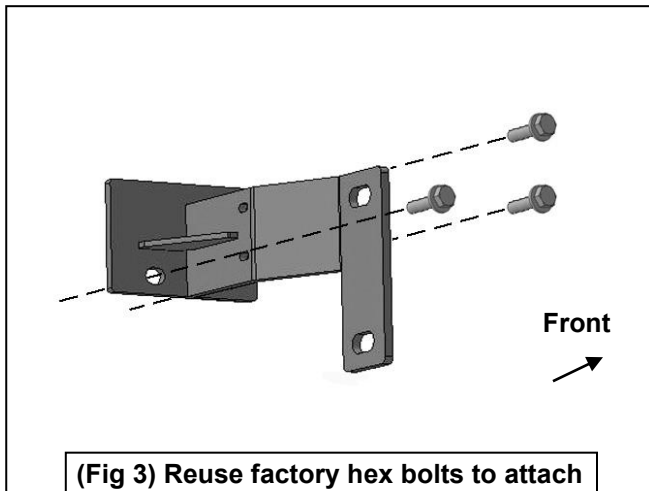

**Passenger/Right Side Installation Pictured**

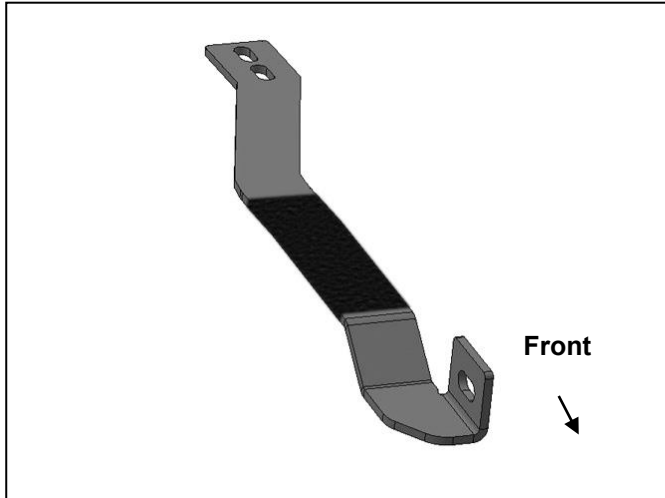

(Fig 9) Apply included Foam Tape to Top Support Brackets

(2) 8mm x 25mm Hex Bolts  
(2) 8mm Lock Washers  
(2) 8mm Flat Washers



(Fig 11) Slide Top Support Bracket through bumper, (see Fig 12). Attach Bracket to top of Mounting Bracket

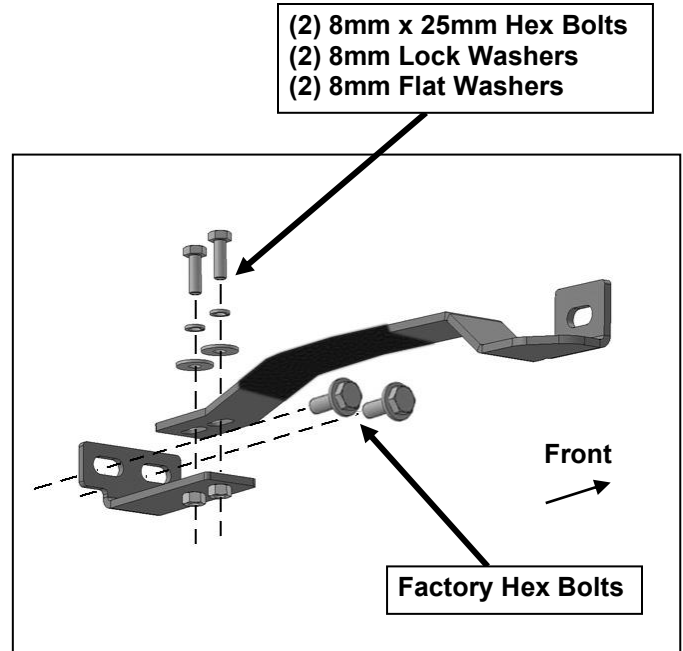

(Fig 10) Attach Top Support Bracket to top of Mounting Bracket

Insert Top Bracket through gap between plastic bumper cover (fascia) and bumper



(Fig 12) Attach Top Support Bracket to top of Mounting Bracket

**Passenger/Right Side Installation Pictured**

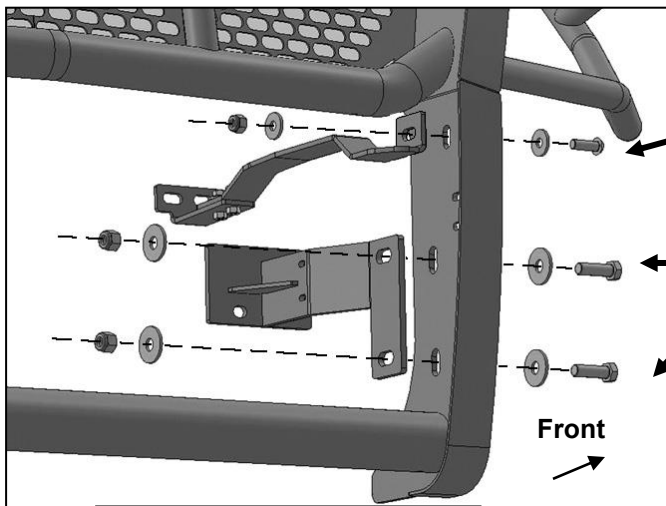

**(Fig 13) Attach Grille Guard to top and bottom Brackets**

- (1) 10mm Button Head Bolt
- (2) 10mm Flat Washers
- (1) 10mm Nylon Lock Nut

- (2) 12mm Hex Bolts
- (4) 12mm Flat Washers
- (2) 12mm Nylon Lock Nuts

- (2) 5mm Button Head Bolts
- (4) 5mm Flat Washers
- (2) 5mm Nylon Lock Nuts

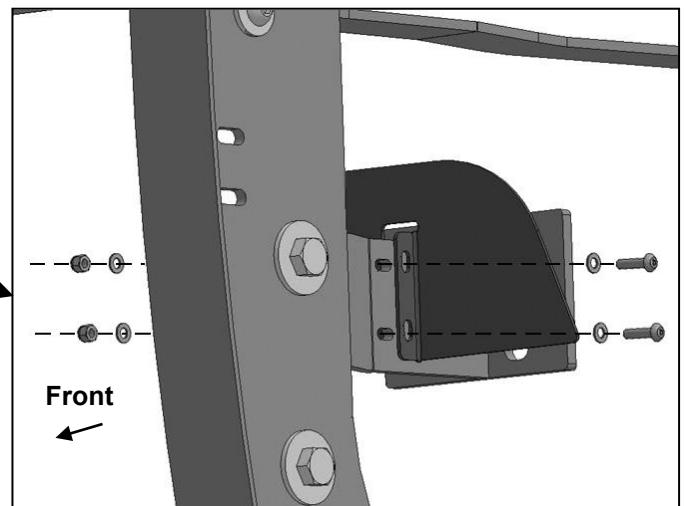

**(Fig 14) 2017-19 Models: Attach 1pc Fill Panel to outside of Frame Bracket**

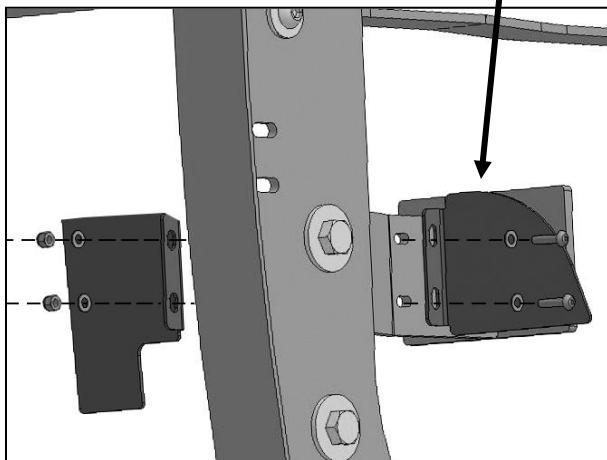

**(Fig 15) 2020-on Models: Attach 2pc Inner and Outer Fill Panels to Frame Bracket**

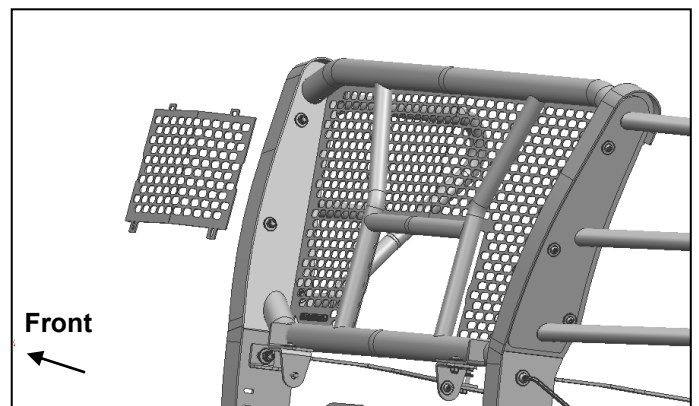

**(Fig 16) Models with grill mounted camera, remove screen**