

E-ROLLER COVER FOR 19-24 DODGE RAM 1500 NEW BODY (DT)(NOT FIT 19-23 CLASSIC) 5.5' FT BED



TEL: 1-866-XANATOS

INSTALLATION INSTRUCTIONS

E-ROLLER COVER FOR 19-24 DODGE RAM 1500 NEW BODY (DT)(NOT FIT 19-23
CLASSIC) 5.5' FT BED

PART # ERCRA01

PROTECTED BY ONE OR MORE PATENT



≡ **NOTICE:**

≡ All the pictures in this manual are for reference only, the pictures may be different from the actual product, but the installation method is the same.

⇒ In order to facilitate your installation, please read the product manual carefully before installation; please protect the surface of your car during installation to avoid scratches.

≡ Please regularly check whether all the accessories connected to the car are loose to ensure safe use.

≡ Distinguish the left and right directions according to the forward direction of the front of the car.

Accessory case overview diagram

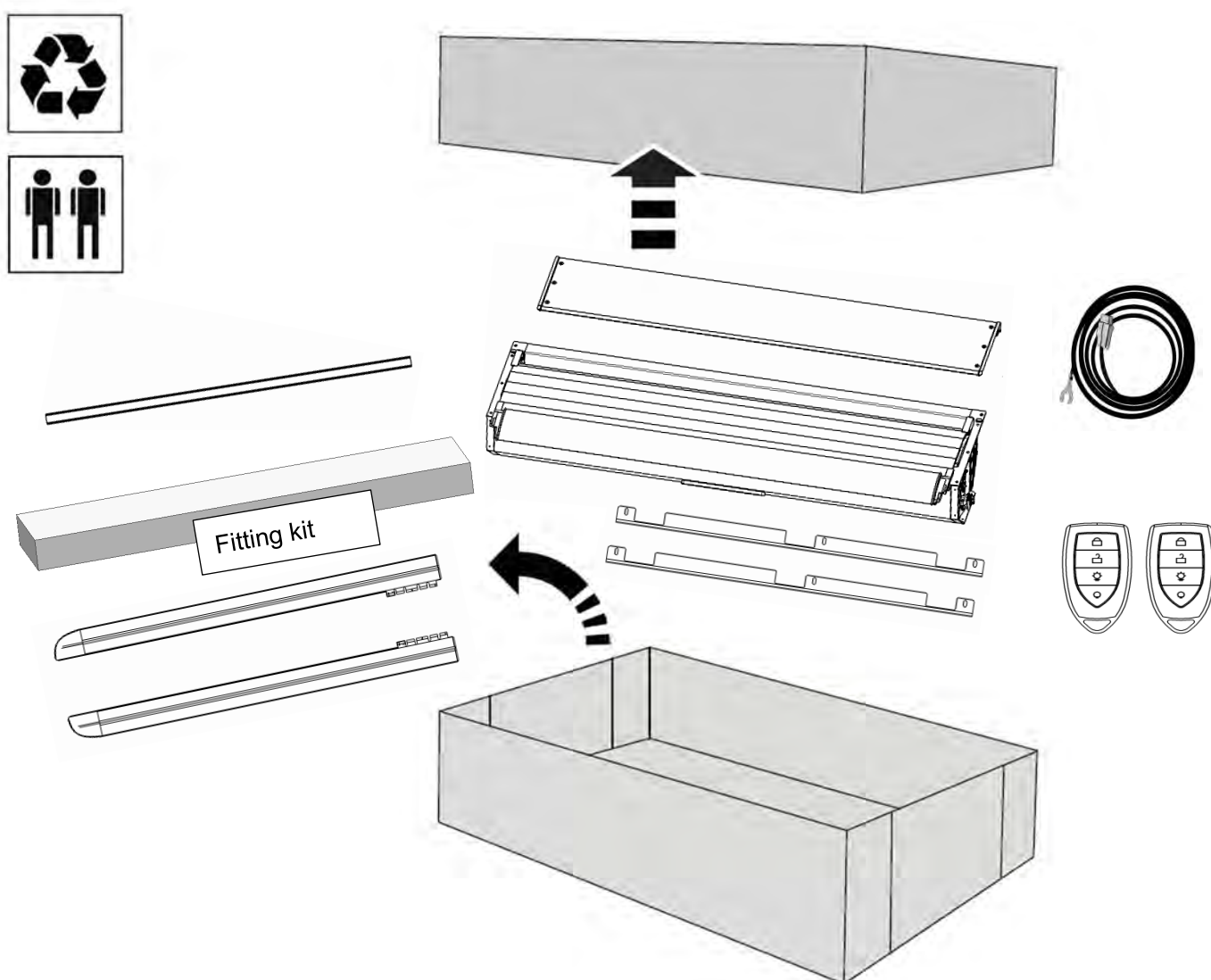

KIT CONTENTS - COMPOENT NUMBER AND QUANTITY

1

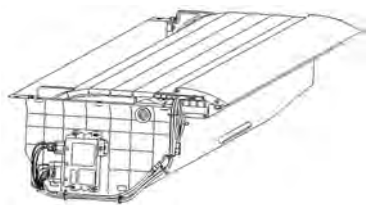

CANISTER ASM. QTY:1

2

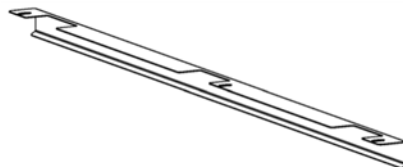

WIRE HARNESS BOARD QTY: 2

3



SIDE RAIL (L) QTY:1

4



SIDE RAIL (R) QTY:1

5

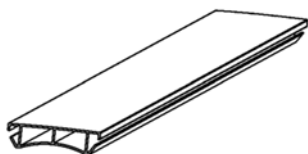

ALU STANDARD BAR QTY: 1

6

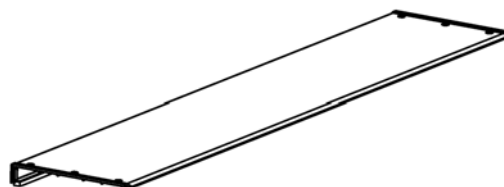

COVER PLATE QTY: 1

FITTING KIT IN BOX

7

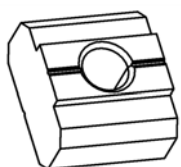

M6 T-Nut QTY: 12

8

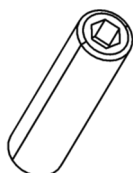

Inner Hex Thread Rod
M6×25 QTY: 12

9



Large Washer D6
(6x18x1.6mm) QTY:18

10



Flange Nut M6 QTY: 12

E-ROLLER COVER FOR 19-24 DODGE RAM 1500 NEW BODY (DT)(NOT FIT 19-23 CLASSIC) 5.5' FT BED

11

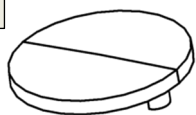

End cap for side rail
QTY:2

12

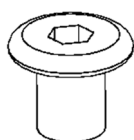

M5×6 QTY: 6

13

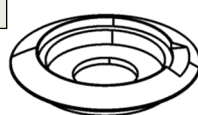

Plastic Base QTY: 6
(For top plate)

14

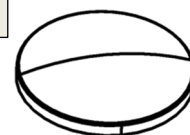

Plastic Cap QTY: 6
(For top plate)

15

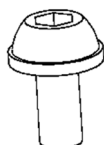

M6×12 (BLACK) QTY: 6

16



Front Drainage Tube
QTY: 2

17



Rubber Washer
56x43x3 QTY: 2

18

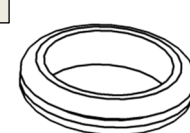

Grommet QTY: 2

19

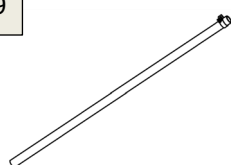

Rear drain tube assembly
QTY: 2

20

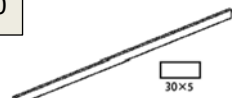

Rear Foam Tape
(1650×30×5) QTY: 1

21

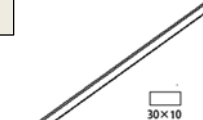

Front Foam Tape
(1650×30×10) QTY:1

22

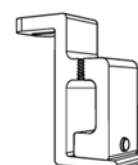

Clamp assembly
QTY: 6

23

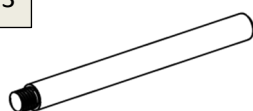

Rod for Gear box
QTY: 1

24



Nylon Cable Tie (2.5x140)
QTY: 10

25

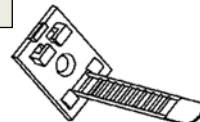

Cable Tie with holder
QTY: 8

26



Allen Wrench S=5 QTY: 1

27



Allen Wrench S=3 QTY: 1

FITTING KIT ADDITIONAL ITEMS

28



WIRE HARNESS QTY: 1

29

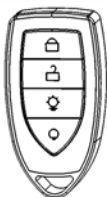

REMOTE CONTROL QTY: 2

30

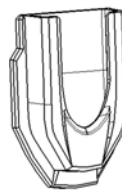

KEY HOLDER QTY: 1

31



INSTALLATION
INSTRUCTIONS QTY: 1

TOOLS REQUIRED – NOT SUPPLIED IN KIT

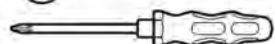

Phillips Screwdriver

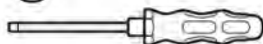

Flat Screwdriver

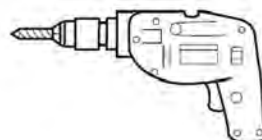

Drill



Holesaw



Drill Bits

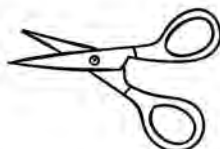

Scissors



Spanners 10mm

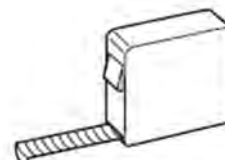

Tape measure



Non-permanent pen

SIDE RAIL INSTALLATION

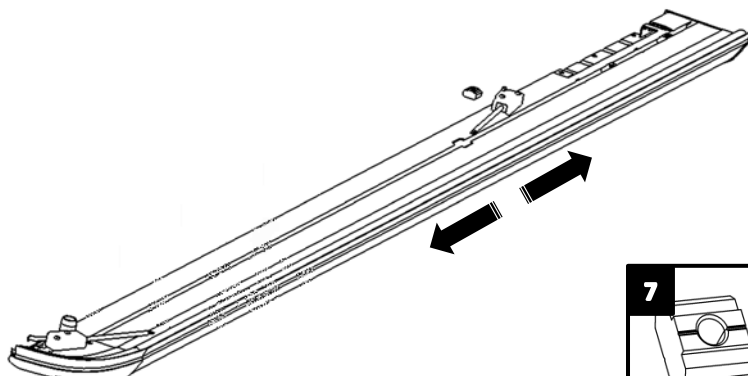
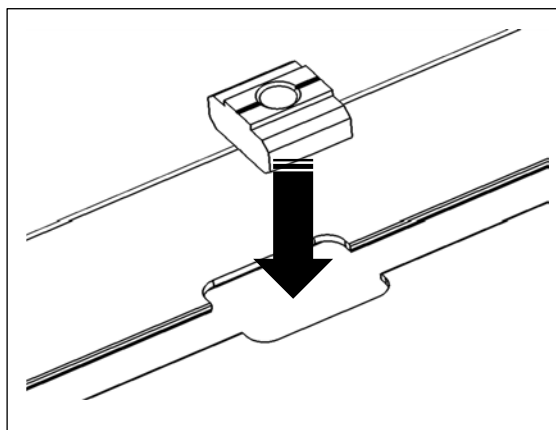

Slide 6 sliding nuts from the gap in the side rail into the side rail, of which 5 slide down and 1 slide up.

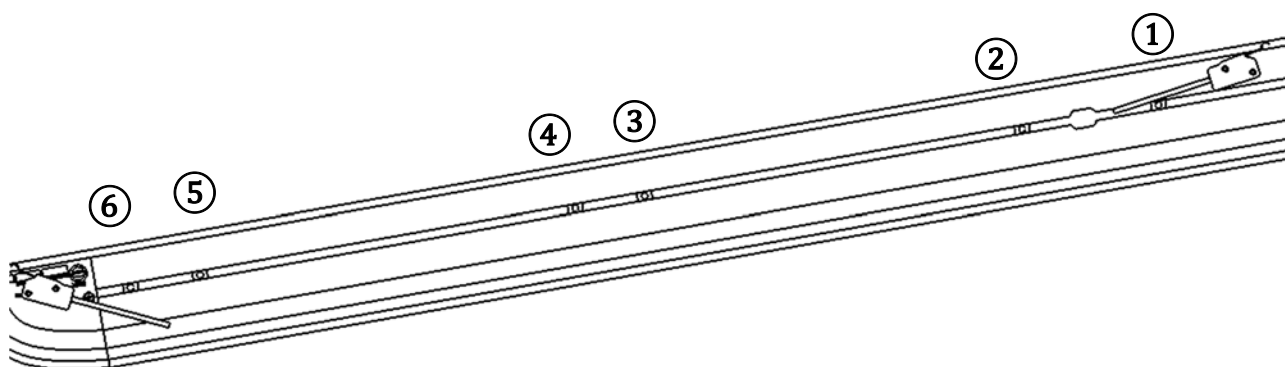

Approximately adjust the position of the sliding nut according to the position of the serial number in the figure.

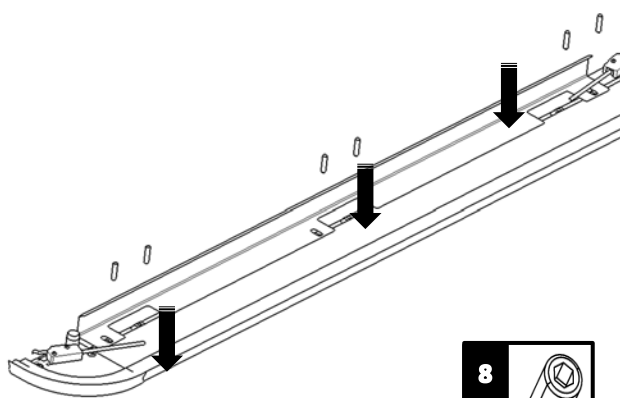
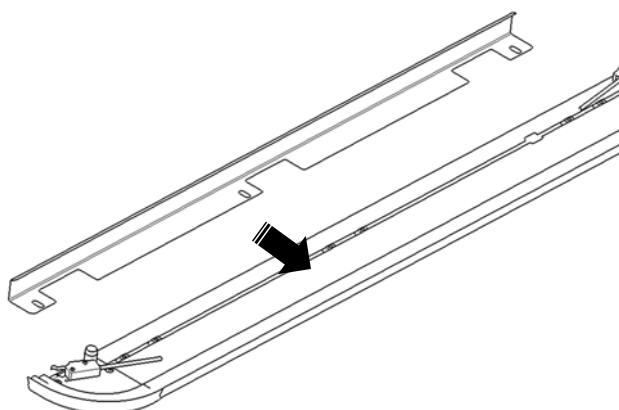

Place the wire harness board on the side rail, and adjust the position of the sliding nut according to the position of the waist hole and notch on the wire harness board so that the sliding nut is aligned with the waist hole. Pass 6 M6_25 hexagon socket flat-end set screws through the waist hole of the wire harness board, and lock them to the sliding nut.

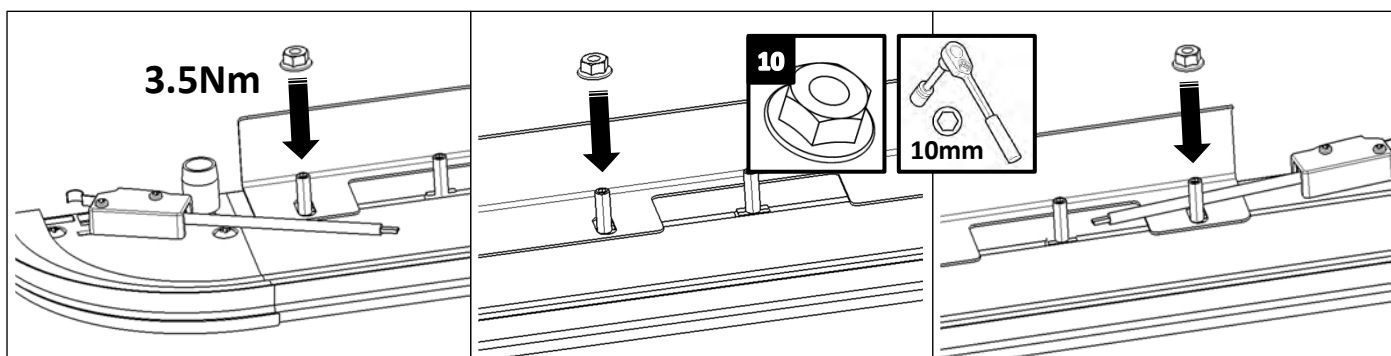

Use a No. 10 socket wrench and M6 flange face nut to lock the wire harness board through the 3 set screws passing through the wire harness board.

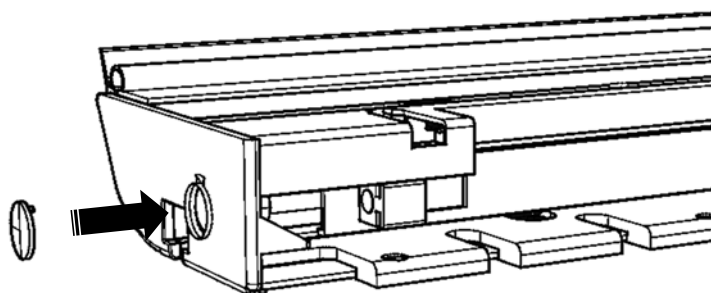

Press the small black rubber cap into the screw hole on the front end of the side rail. Assembly way is same on both sides.

SIDE RAIL & CANISTER

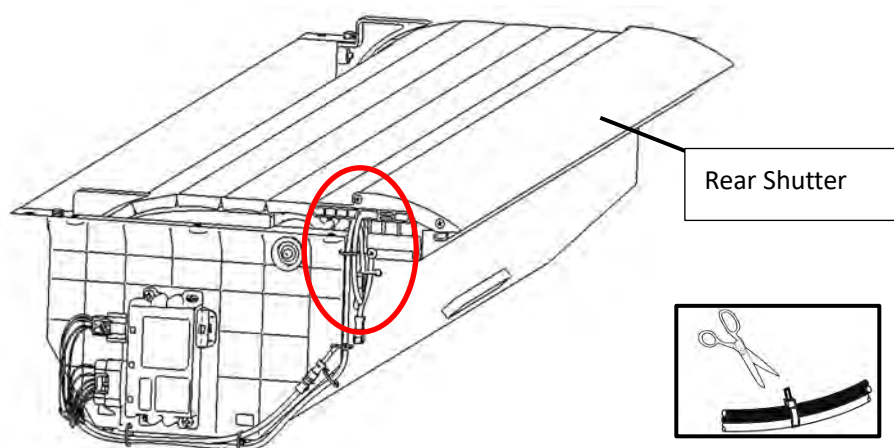

Pull out the shutters a little bit, release the cable tie for switch.

E-ROLLER COVER FOR 19-24 DODGE RAM 1500 NEW BODY (DT)(NOT FIT 19-23 CLASSIC) 5.5' FT BED

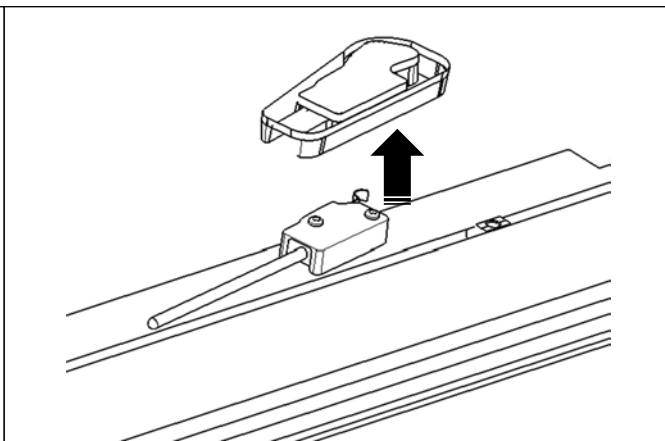
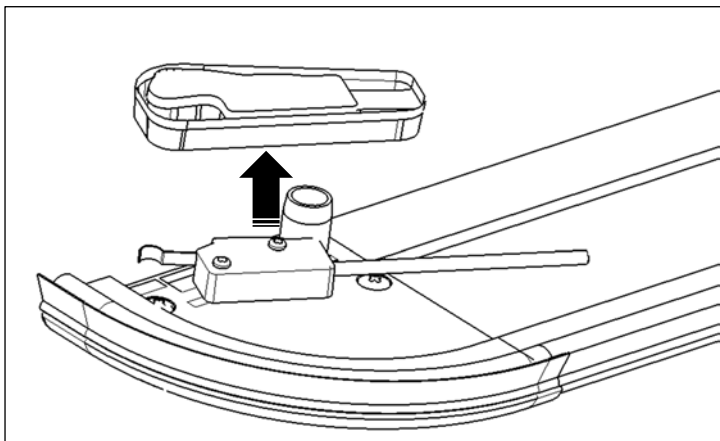

Tear off the limit switch protective shell on the side rail.

△Notice: There is no need to loosen the screws above, just tear them off.

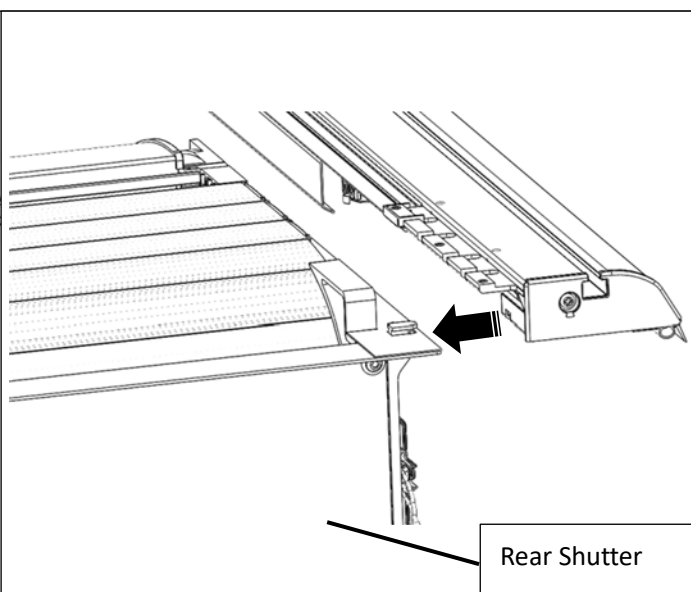
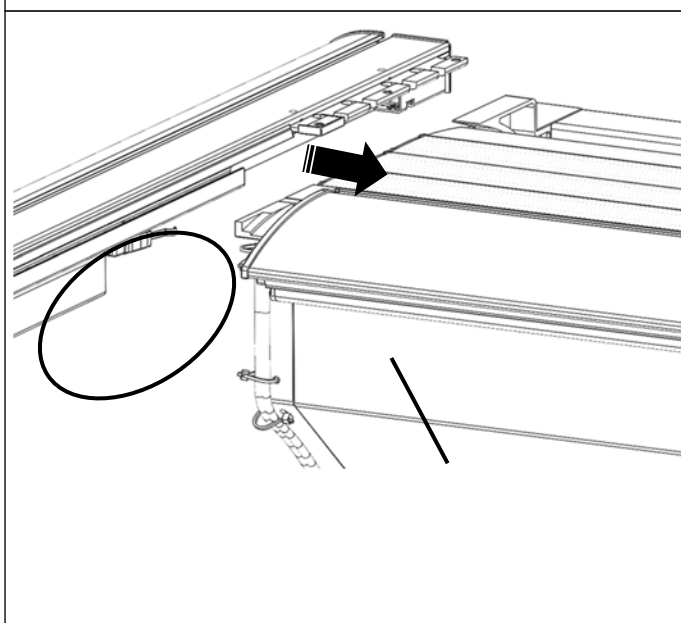

After the wire harness board is installed, install the side rail on the box body, slightly lift the end of the door without lock, the side rail slide rail faces the end, and the notch of the side rail faces the upper positioning boss of the box body.

△Notice: During the installation of the side rail, avoid the end of the door without locking the door from

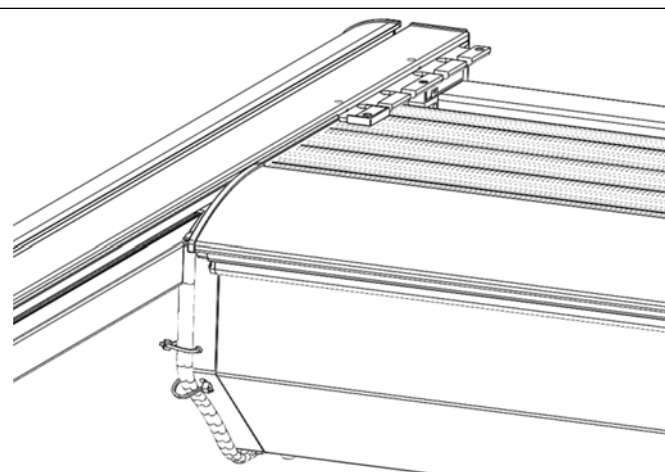
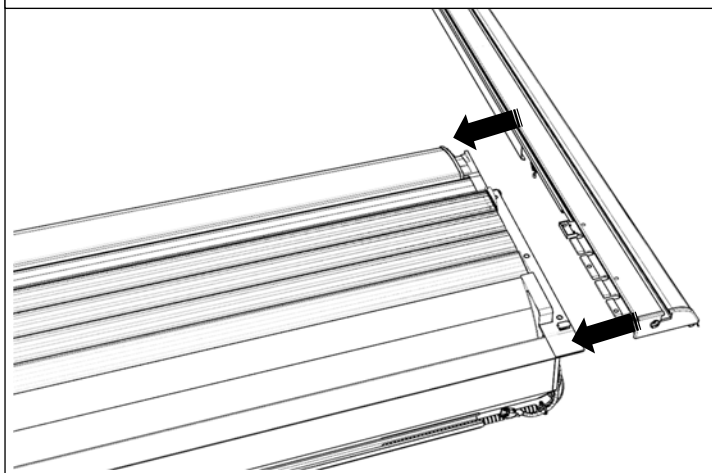

Place the side rail on and align.

△Notice: Be careful, the switch may get damaged if it hit the canister harshly.

E-ROLLER COVER FOR 19-24 DODGE RAM 1500 NEW BODY (DT)(NOT FIT 19-23 CLASSIC) 5.5' FT BED

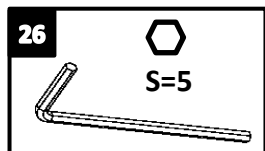
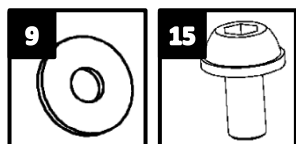

3.5Nm

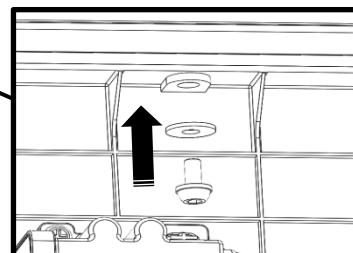
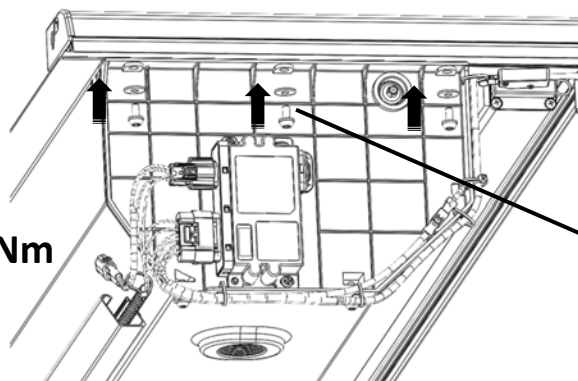

Place the side rail and align, tighten it with M6 Bolt combo.

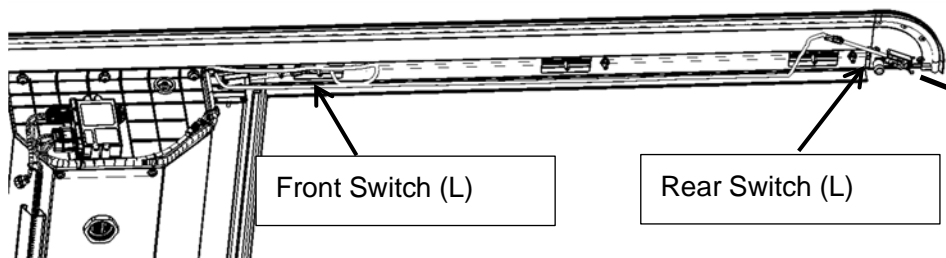

Bottom View (L)

Front Switch (L)

Rear Switch (L)

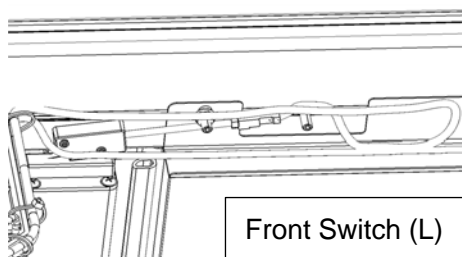

Front Switch (L)

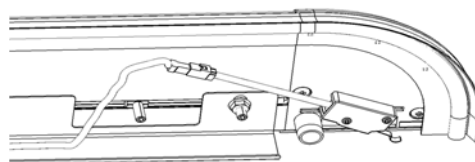

Rear Switch (L)

Connect the disconnected limit switch harness to the corresponding limit switch on the side rail.

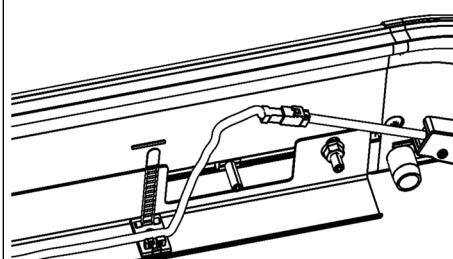
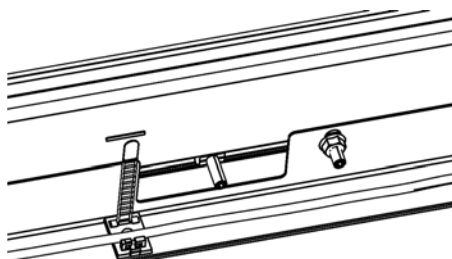
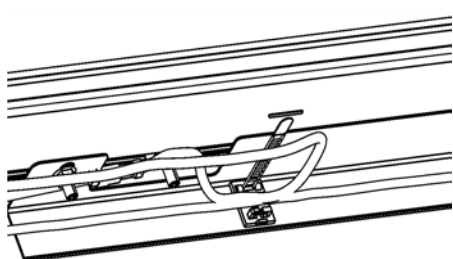
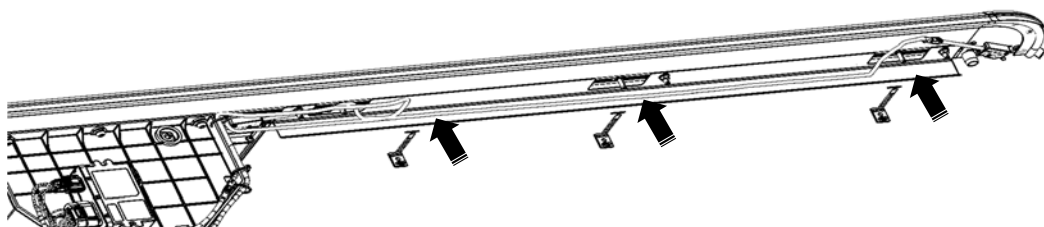
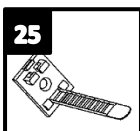

Peel off the protective film, stick the cable tie holder on inner side of the wire harness board. Stick 3 pieces on each wire harness board. Assembly way is same on both sides.

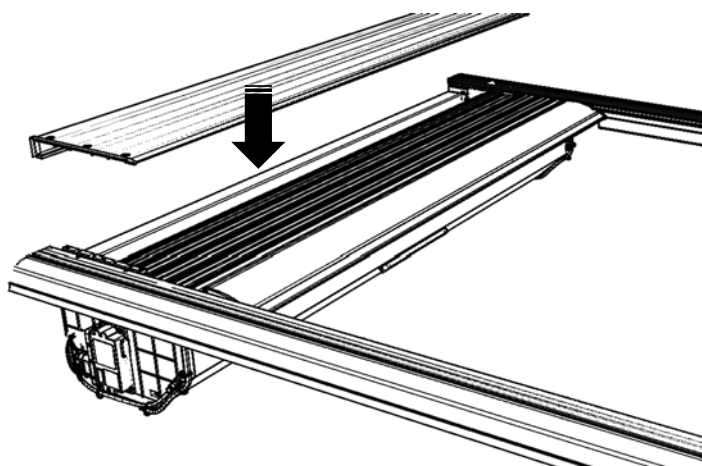
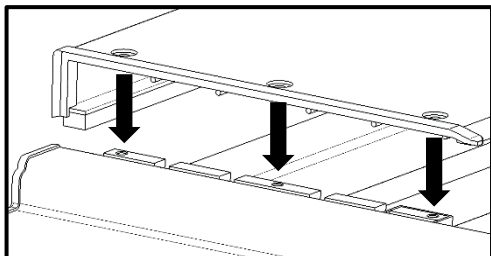
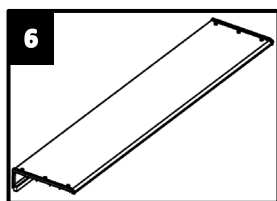

Put on the cover plate, adjust it to appropriate position.

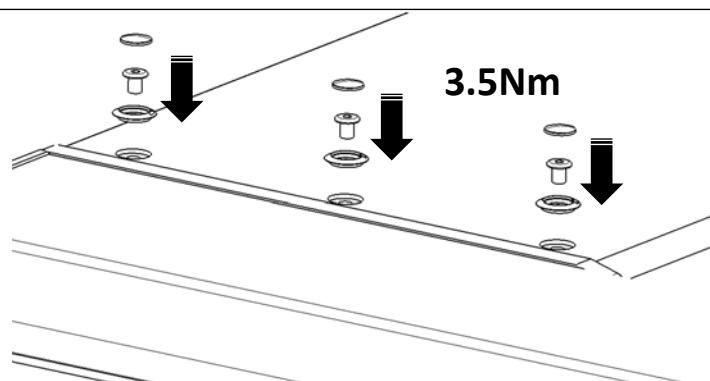
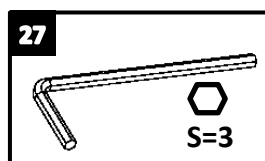
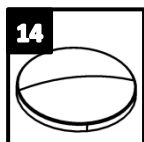
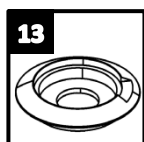
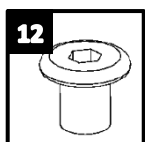

Install the top plate, fasten it with plastic base and M5_6 inner hex bolt. Then put on the plastic cover.

Drilling Holes for Drainage Tube

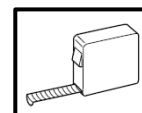
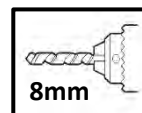
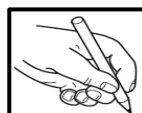
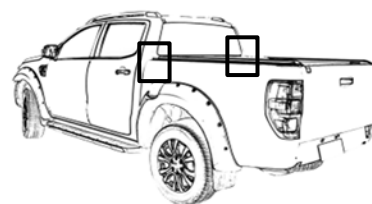
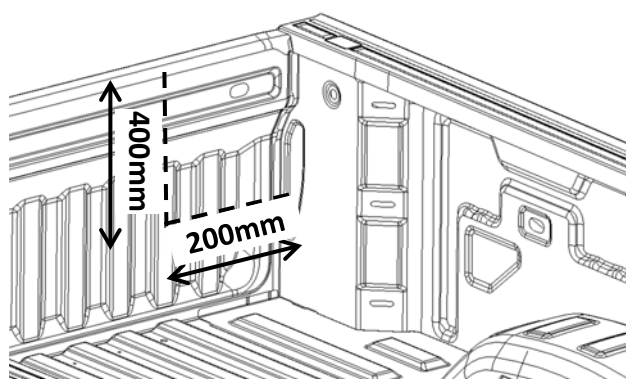

Measure and mark up the positions for the front drain tubes on both sides. Then drill through the truck bed with 8mm drill. **Notice:** Positions for drain tubes may be different for some pickup trucks.

18

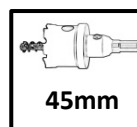
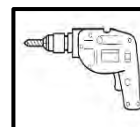
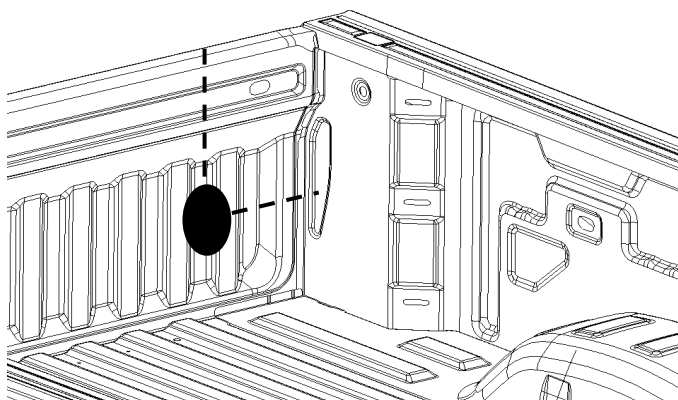
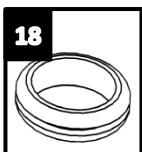

45mm

Drill out the front pilot holes in the truck bed with 45mm holesaw. To avoid getting rust, you should paint the drain hole on truck bed before putting on the grommet.

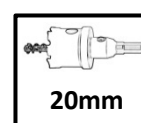
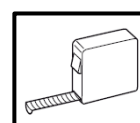
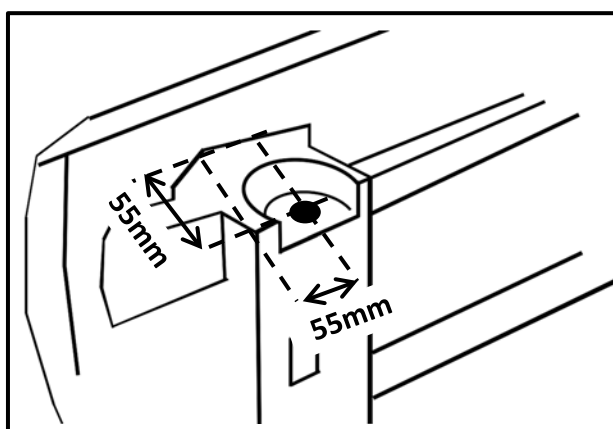

20mm

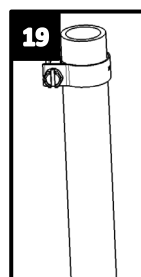
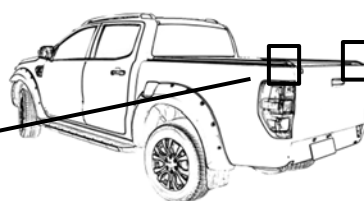

19

Measure and markup the positions for the rear drain tubes on both sides. Drill the locations with 20mm holesaw. Notice: Just for reference, for some vehicles the rear drain hole positions would be different.

Route the Wiring Harness

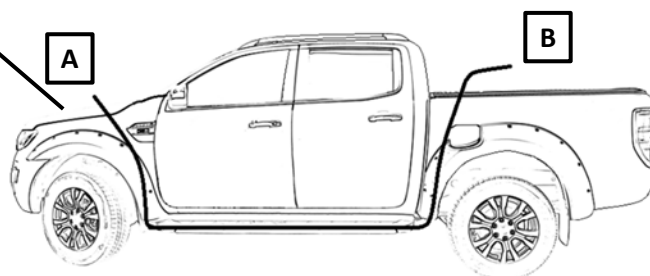
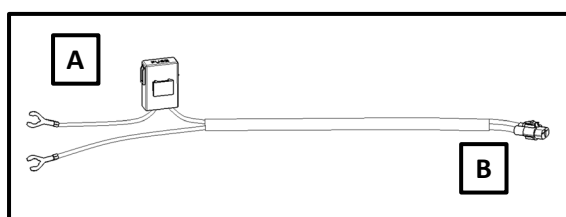
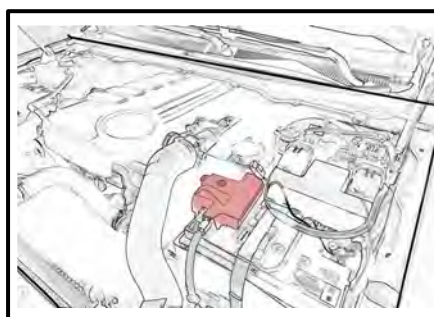

Start the power cord from the hole in the car compartment at the left rear wheel, go through the beam to the engine compartment, and connect to the battery of the vehicle.

24

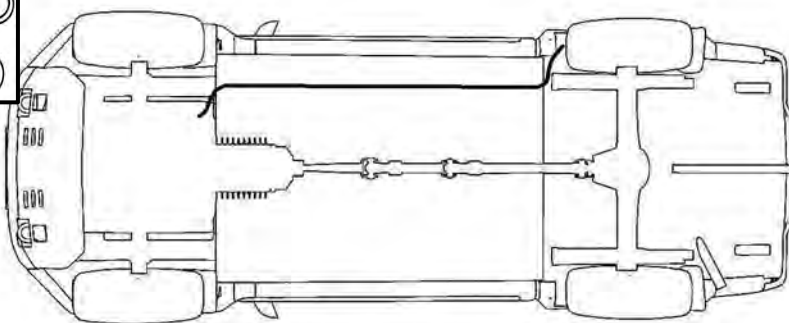

Attach the wiring harness to the chassis rail using hole in the tab mount, use cable tie.

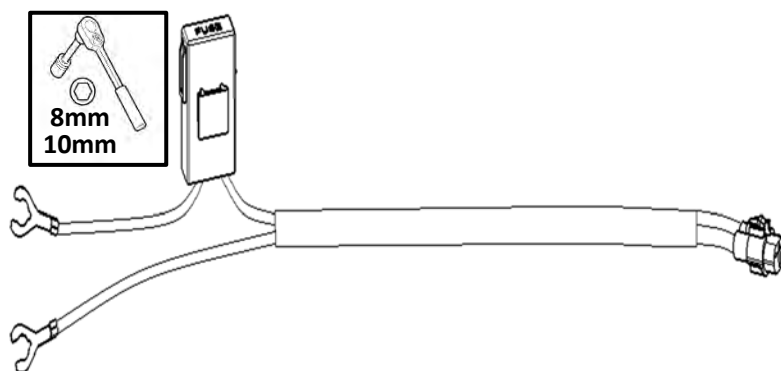
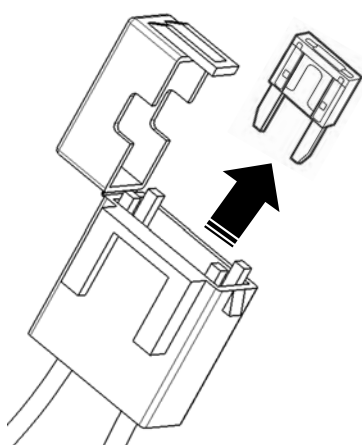

Pull out the fuse from the fuse box, and then connect the vehicle wiring harness to the positive and negative terminals of the battery. **NOTE : Black- Negative; Red- Positive. After all installations are completed, assemble the fuse.**

Put the Roller Shutter on Truck Bed

21

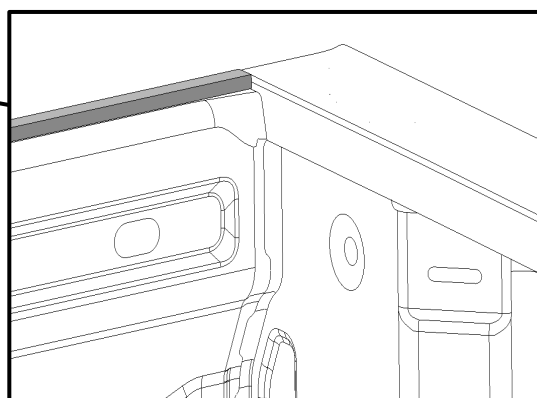
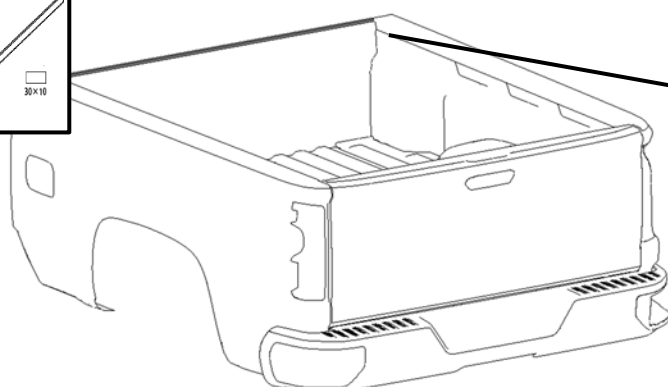
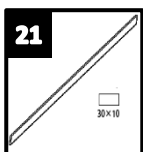

Install the front foam tape on the top of the bulkhead.

E-ROLLER COVER FOR 19-24 DODGE RAM 1500 NEW BODY (DT)(NOT FIT 19-23 CLASSIC) 5.5' FT BED

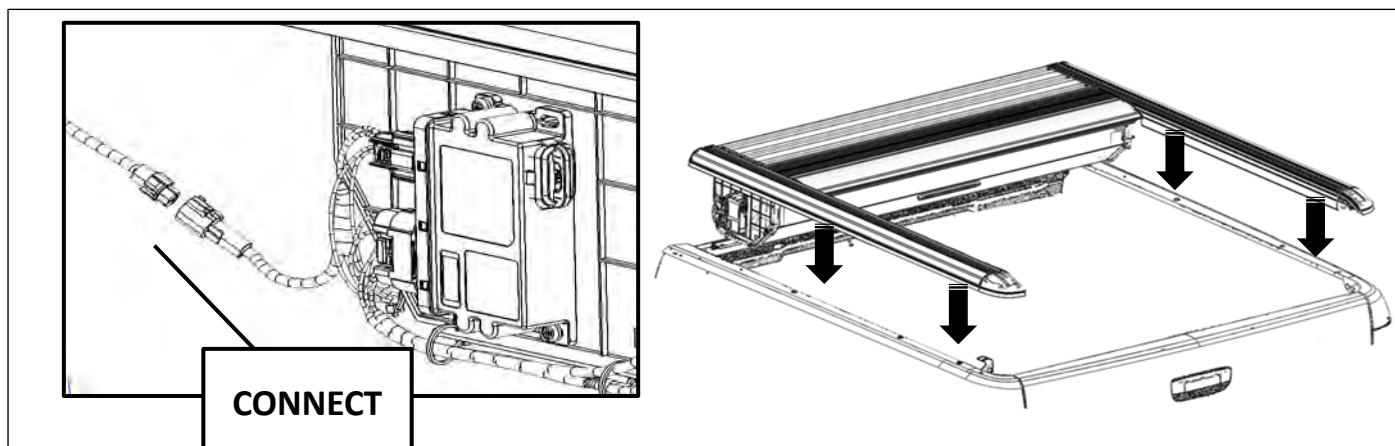

Put the roller shutter on truck bed, and then connect the wire harness.

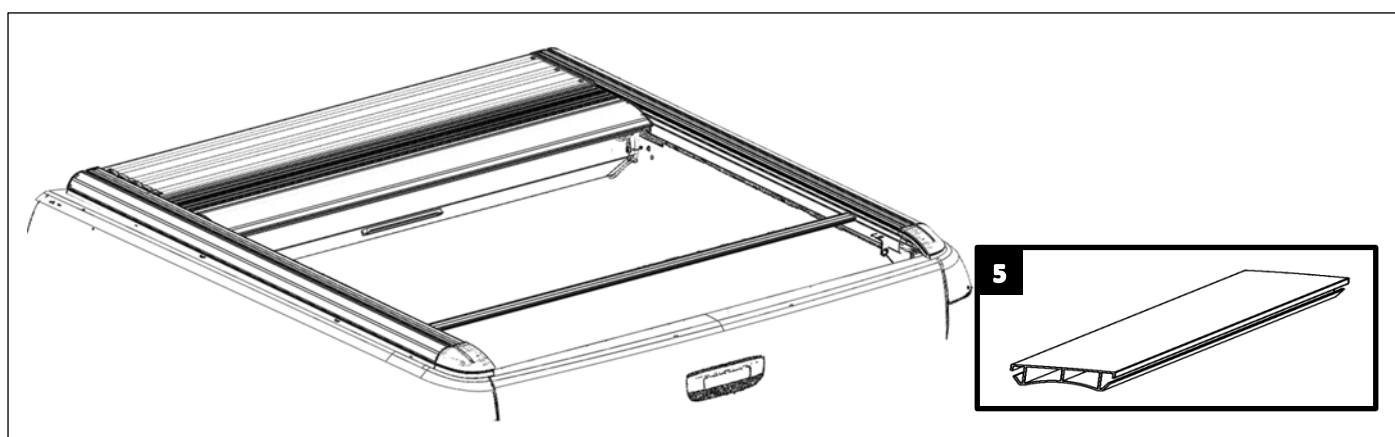

Put on the Aluminum standard bar, to keep the side rails on parallel status.

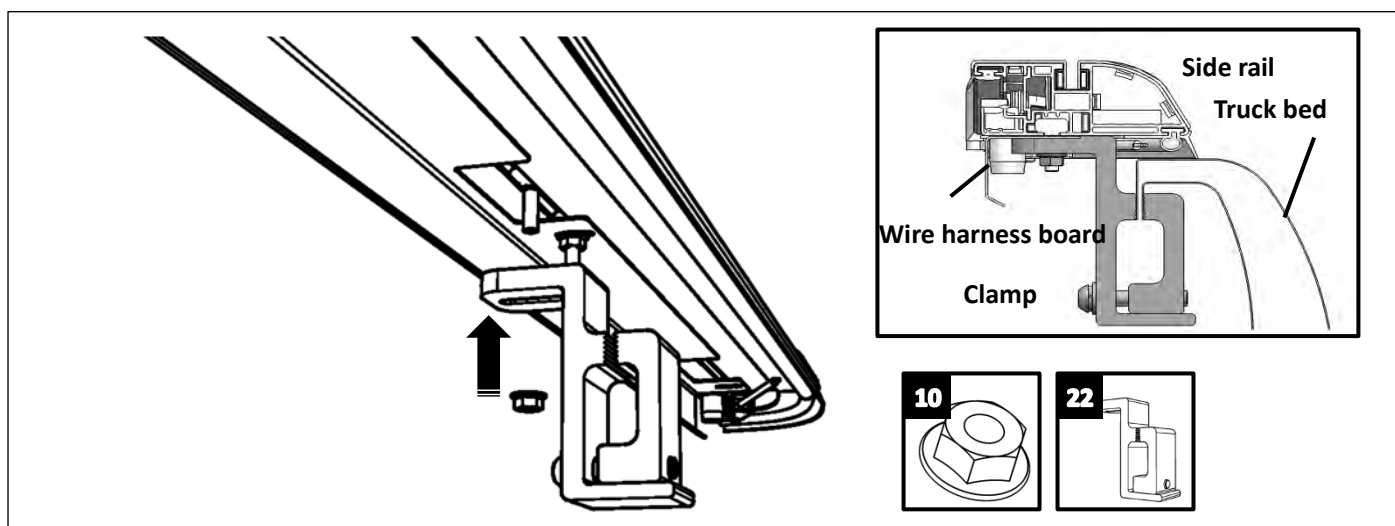

Fix the side rail on the truck bed by fastening the clamps.

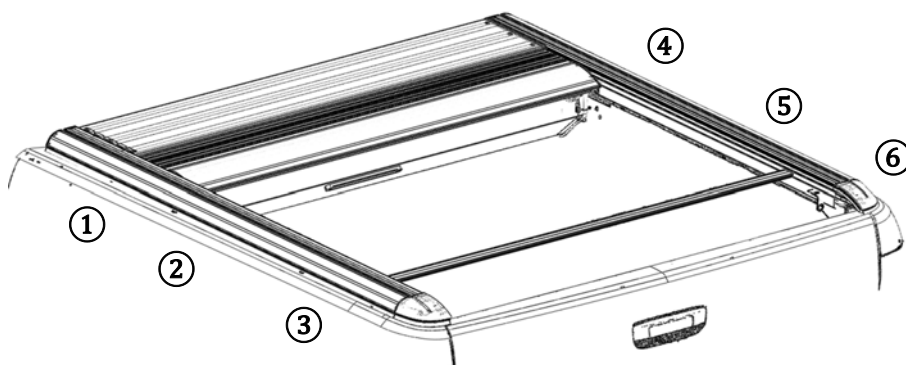

Install the clamps on left and right side rails, above picture is the clamping position for reference.

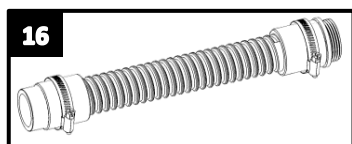
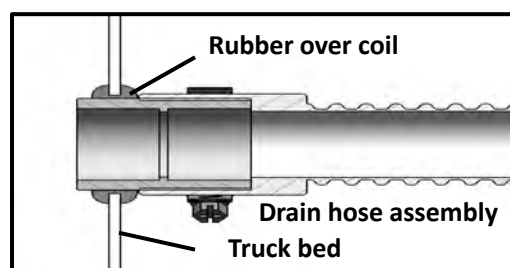
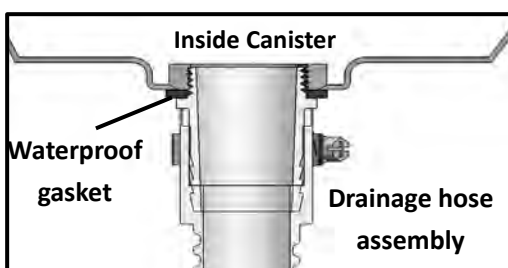
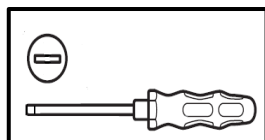
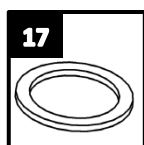

Bottom of canister

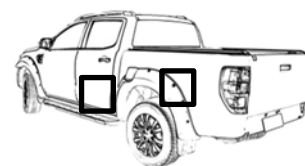
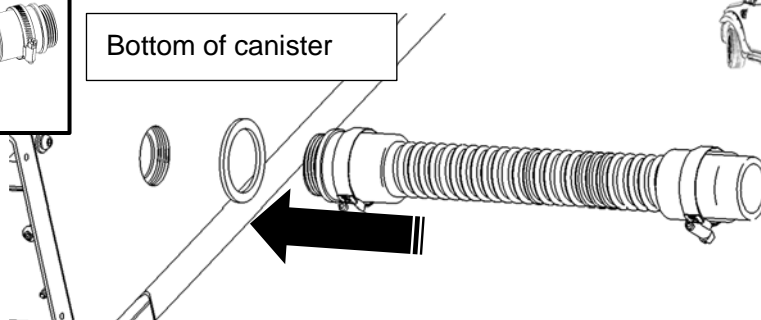

Put a waterproof gasket on the threaded end of the drainage hose assembly, screw on the hole at the bottom of the roller blind box, and plug the other end into the hole of the tail box. Finally, use a flat-blade screwdriver to tighten the hose clamps at both ends of the drainage hose.

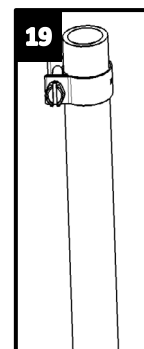
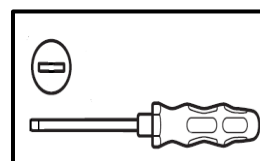
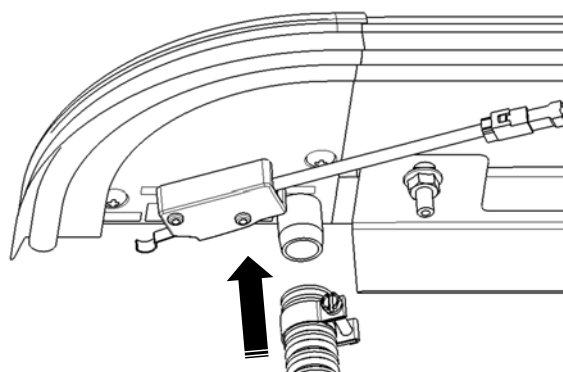

Screw the rear drain bellows to the leaking hole at the rear end of the side rail, and use a flat-blade screwdriver to tighten the hose clamp on the bellows.

E-ROLLER COVER FOR 19-24 DODGE RAM 1500 NEW BODY (DT)(NOT FIT 19-23 CLASSIC) 5.5' FT BED

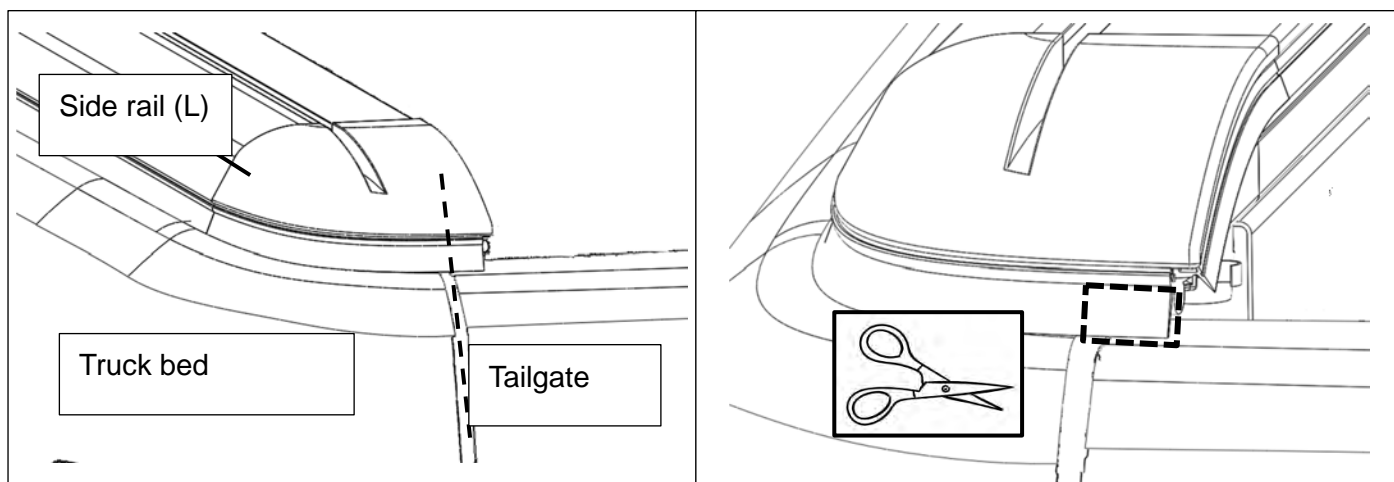

When closing the tailgate, if there is interference between rubber strip and tailgate, please trim the rear rubber strip as above picture shows.

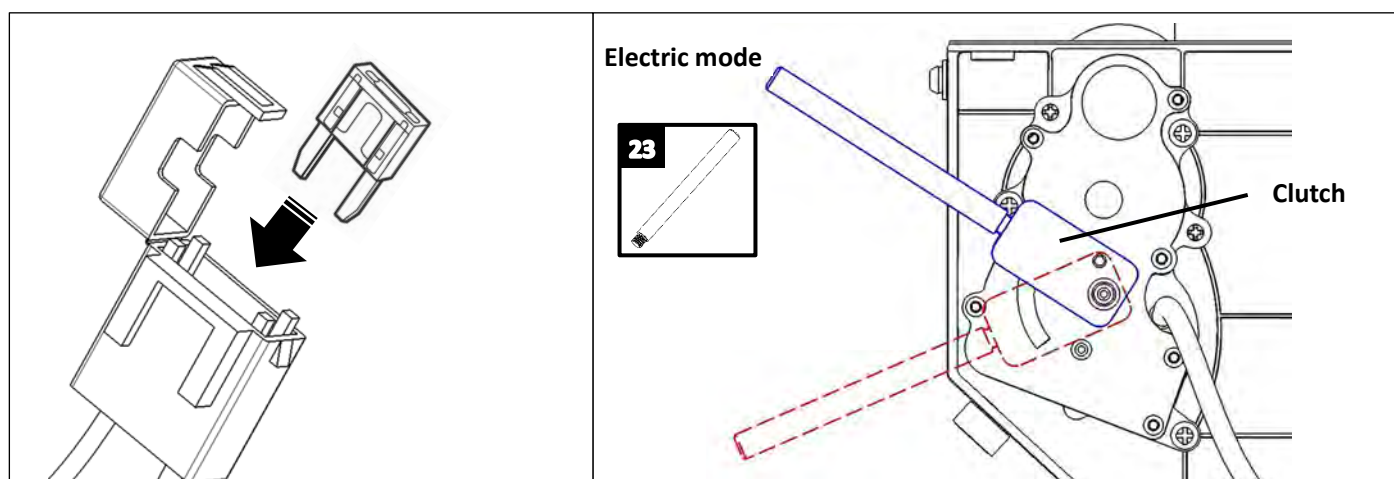

Finally insert the 25A fuse back to the fuse box, then the installation is complete.

Notice: There is no distinction between the front and the back side of the fuse.

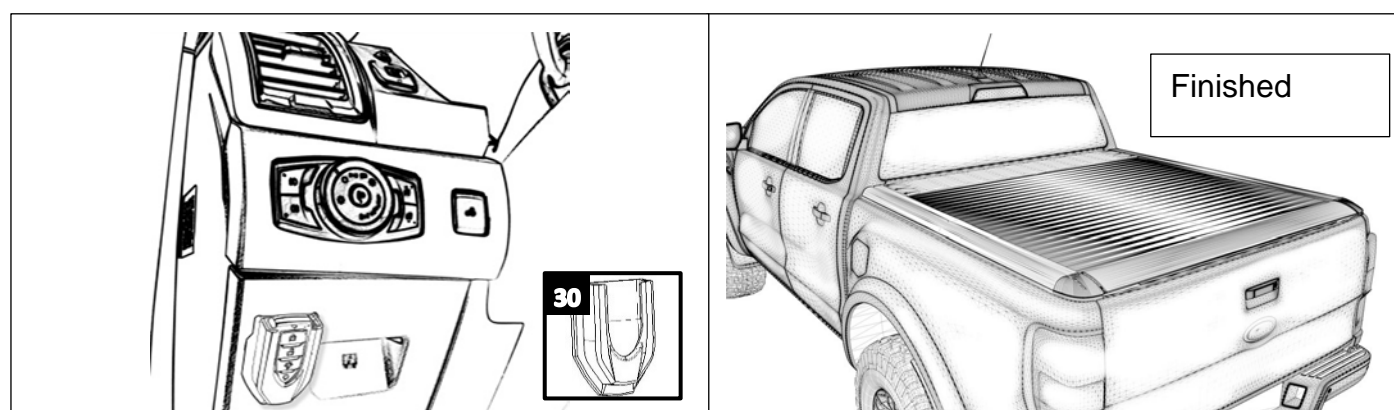

For convenience, maybe you can keep one of the remote control in driver cabin.

(Such as sticking the key holder on below of the console, then put the remote control in it)