

INSTALLATION INSTRUCTION

Front Runner

2021 Nissan Rogue

PART # 15NIROA21



Attention:

- Please read this installation menu before installing this part. Protect your car properly in case there is any scratch might have.
- You may need to periodically to re-tighten all hardware for safety use after installation.
- Installation pictures are only for your reference, there might be some differences between pictures and real parts but no affect for your fitting.

PART LIST

NO.	NAME	QTY	REMARK	QTY	NAME	QTY	REMARK
1	Wing Guard (L)	1		11	T-BOLT	2	M8
2	Wing Guard (R)	1		12	PVC Clipφ8	2	
3	Cross Bar	1		13	Large Washer	2	Φ8x25x2.0
4	Cross Bar	1		14	Spring Washer	2	Φ8
5	Bracket (L)	1		15	Hexagon Nut	2	M8
6	Bracket (R)	1		16	Hexagon Bolt	4	M12x35
7	Hexagon Socket Button Head Screws	8	M6x20	17	Large Washer	8	Φ12x30x3.0H
8	Flat Washer	16	Φ6x12x1.5	18	Spring Washer	4	Φ12
9	Spring Washer	8	Φ6	19	Hexagon Nut	4	M12
10	Hexagon Nut	8	M6	20	Hex Wrenches	1	

Notes: The installation is the same on the left and right sides.

INSTALLATION PICTURES

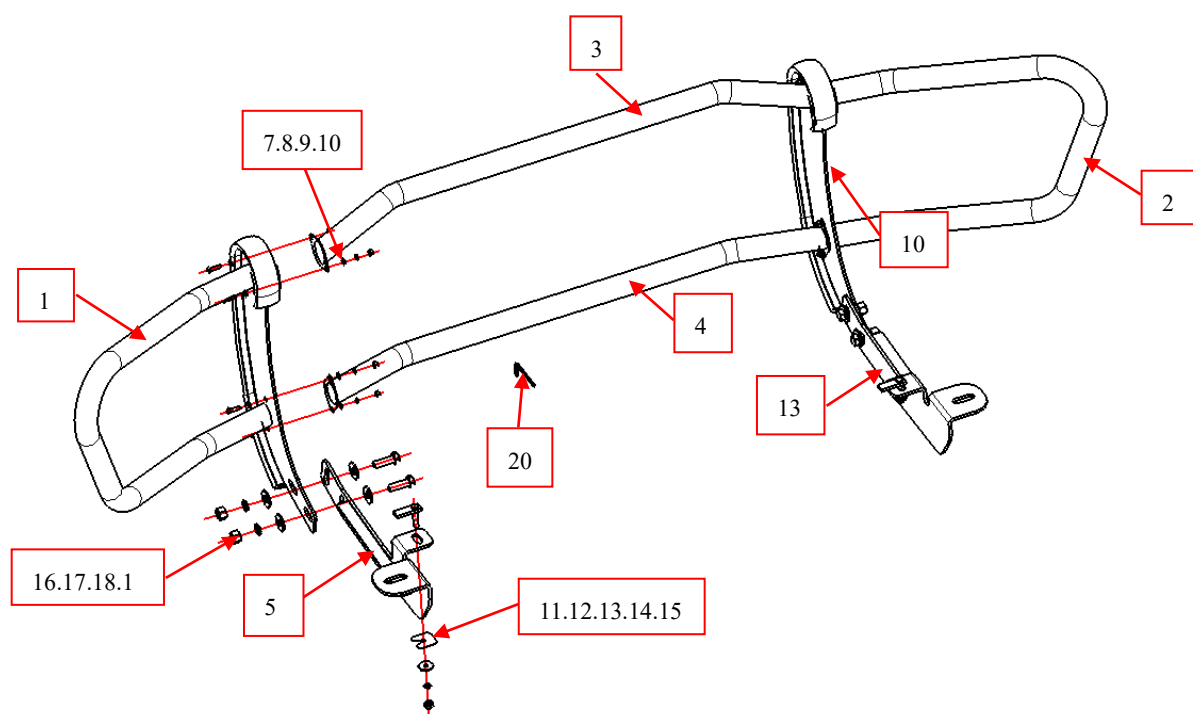

Step 1: Refer to Part List to check if all hard ware are included.

Step 2: Firstly, according to the installation diagram of the car code, distinguish between the car code (left) and the car code (right), and then place them together with the fasteners in the corresponding positions to improve your installation speed.

Step 3: Refer to the schematic diagram and screw on the vehicle code using standard parts, but do not tighten the screws yet.
(The installation method for the left/right car code is the same)

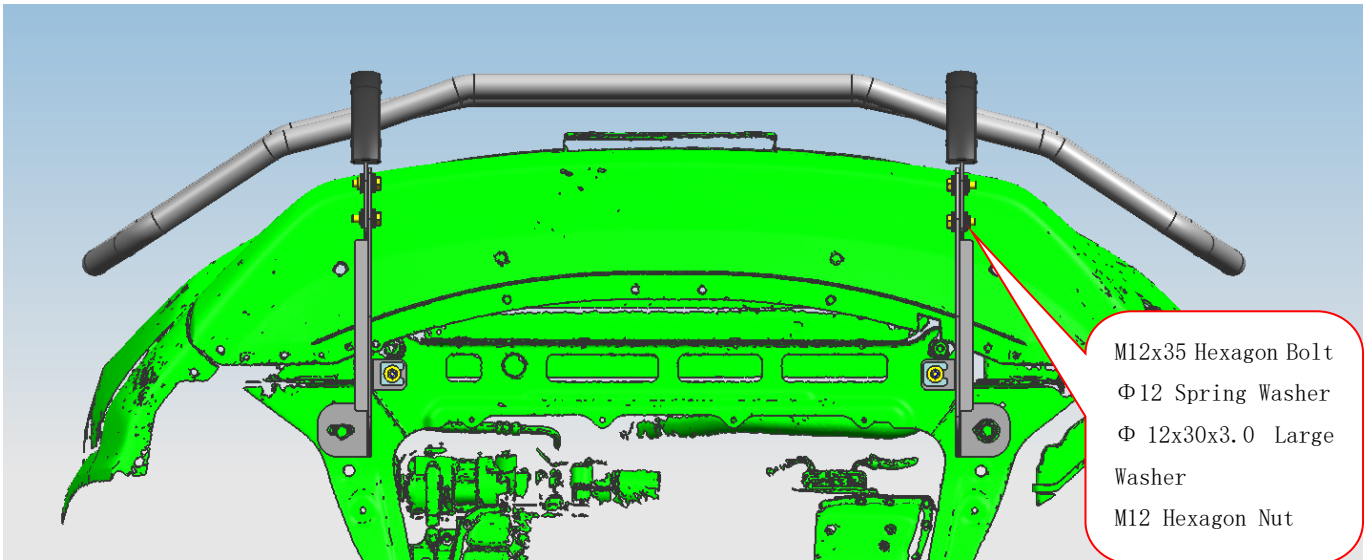

Step 4: Check if all hard ware are installed and then fasten all to complete the installation.

Step 5: Easy Install refer Pic

Disclaimer: Caused due to improper installation initiates or some related problem and losses, are beyond our company's quality assurance.